

496(1) ($\frac{1}{35} + \frac{36}{70} *$)

K13/158 E. B. Madondo

496 0
PP-1-35

1



K13/158

THE UNION

EXERCISE BOOK

40 Pages

Ruled Feint and Margin

Class Mkwanda kwana

Subject Bomvu nokubusa kw
wo

13.038

(Msinga) Bomvu

4960 P.P. 1-70

K13/158

Ukwandd kwamabomvu
no kubusa kwawa

E. B. M. Madondo

history of the
Bomvu (Uzinga)
tribe

indexed

13.038

38 p typed
£ 2-7-6

57/6 # 38
37/156

Isingeniso

Abanumyane bakithi abadumileyo
 O. A. J. Molife no J. Z. Masendo
 sebe balile ngomdabuko wezizwe
 eziNsondu, nangomngululu wo
 kwehla kwazo ziza lapha emzansi.

Nami ngizamise ukugqqa zonke
 lezindaba ngihambela abakithi
 abadala. Ngizamise nokuthi ngi
 thole amasiko athile agondene
 nezizwe lezi zama bonvu.

Lezizindaba zakithi zithi uma
 izoxwa sihlabe umxhwele. Ngiz
 bonile ukuthi kuhle sizibale zifu
 ndwe yiho bonke abantu, ngoba
 futhi isizwe sasema bonvini siza
 bakelaka singumboniso wo kwanda
 kwezizwe.

Ngizonde ukuba ngihambele zonke
 izizwe zakithi edilungwini nokwa
 zulu, ukuz zonke izindaba zaki
 thi zitholakale kahle namasiko
 ezizwe anga khohlakali.

496

K13/158

Ngo jakula kakhulu uma abafu
ndi baleli buku kengibalela nomayi
ni abangayizwayo nabangayazi.

Ngifisa ukuba nizi tholele okuhle
no kubi okungadungeki okwakwe
nziwa abakithi abadala.

Bem. Enoch M. Madondo

Adam College.

Adams Mission Station

Natal.

Izindaba Ezikulencwadi.

1. Ukhamba kuka Mawane elwa noShaka.
2. Ukungena kuka Matomela ebukhosini.
3. Ukufa kwakhe.
4. Ukubamba kuka Somaishi nokungena kwakhe ebukhosini.
5. Impi ya Manzamalala yesigwe sikhwayintaba.
6. Ukubusa kwakhe.
7. Ukufa kwakhe kanye nokwehlukana kwakhe noThomoyi.
8. Ukungena kuka Mawele ebukhosini esefile uyise.
9. Ukubusa kwakhe kanye nokufa kwakhe.
10. Ukungena kuka Nyoniyezwe kanye nokubanjelwa kwakhe uSiBindi.
11. Impi yase Nkandla.
12. Ukubusa kanye nokufa kuka Nyoniyezwe.
13. Ukungena kuka Mayiz ekanye kanye nokubanjelwa kwakhe uMakhasana.
14. Ukubusa kwakhe.

<u>Ukhasi</u>	15. Ukwakha kwesizwe sika Nthonyi	43
1	16. Ukubusa kwakhe kanye nokufa	
2	kwakhe.	44
4	17. Ukungena kuka S'bunge ebukhosini	47
6	18. Uku busa kwake	49
8	19. U S'kelwano lwezizwe zama Bomvu	51
8	20. Amasiko azo zokhe.	52
13	21. Ama butho esizwe sika Somashi	54
11	22. Intuthuko yase Ma bomvini asenkla	55
13	23. Isimo selizwe kanye nezinto ejitsha	
"	lwa kulo	58
16	24. Ukuphuma kwe Ngina.	61
	25. Ukubandlululana kwa Ma bomvu.	63
19	26. Ukugcagca kwe Nkvozana.	65
	27. Amagama okugquba isizwe.	67
28	28. Izigodi zase Ma bomvini asenkla.	68
	29. U Mhlawengome nesigodi sakhe.	69
30		
33		
36		
40		

Amangwane elwa noShaka 1

496

K13/158

1. Ukubamba kukaMatwane elwa noShaka

U Matwane wayeyi Nkosi ya - Mangwane, edumile futhi enamandla. UShaka walwa naye izimpi ezinkulu kodwa engalitholi isu lokumngoba. Kwathi ngomnyaka ka 1820 waze wone ngoba wazwaboleka, washona ngakho Khahlamba lapho azwaphellelwa abantu bakhe bonke.

Kuthe uma ezwe ukuthi uShaka akasekho wabuya weza kwaZulu. Kodwa uDingane washesha wambula la ngoba ezwa izindaba ezingalungile ngaye.

Isizwe saMangwane sahlala si ngena Nkosi enamandla, kwaze kwa ngena uZombane ozala uMatamela. Sanda ke isizwe saMangwane saqala ukuba namandla.

2. Ukungena nokubusa kuka Matomela

Kwathi ukuba afe u Mzukulu ka-Matiwane u zombane. U Matomela wangena esikhundleni sikayise ngoba kwakunguyena iNkosana.

Wanella ukungena nje wawabutha nenku zonke amabutho eqinisa isigwe sakhe. Izwe lonke lamabutha ngelinye iso, kwabasengathi ugothi ayihlone. Amakhosi onke athumela kwa zulu ukuthi amaBomvu ayahlo ma akwaziwa lapho ebeke khona.

Ngalesikhathi kwa zulu kwakubusa u Mpande engakuthandi ukulwa, nga khoke wathula nje, kuthe ngomnyaka ka 1855 wathumela u Mbelu wakwa Nxumalo ukuba azokuzwa ukuthi kwenzenjani, uyihlonisa uyibekisa phi. Uthe esephindela emuva wayese hamba neNxusa lika fomu Matomela eliyochazela iNkosi uMpande nempe la u Mpande wafike waneliswa yincasiselo yeNxusa lelo. Kodwa wa-

K13/158 Amangwane abuyela e Mandleni 3

496
liyala ukuba bangalingi bakhlasele
bengamtshelile, wathi futhi yena
akazifuni izimpi.

U Matomela wagqwama abafazi aba
ningi, wazala abantwana abaningi
futhi. Wabusa kahle kakhulu.

Kodwa thi esabusa nje kwase kuba
khona ukungqwanani phakathi kwama-
dadana akhe u Somashi no Thonoyi.

Yefuna ukubusa bobabili kanti
ondala kwa ku Somashi. Nokho
wabacindezela ngesithunji esesabe
kayo ebona kala noma umuntu
engatshelwe umuntu ukuthi nansi
Nkosi. Eba~~thanda~~thanda, abantu bakhe
futhi ebizela zonke izinto zoku
jabula, engathandi ukuthetha
amacala amadoda njalo senga
thi abafokazana.

3 Ukufa kuka Matomela.

Kwathi ngo Masingana kwezwaka la ukuthi i Nkosi iyadunguzela.

Kuthe mhla gungamashimi amabili nane kwezwa kala ukuthi i Nkosi sekuze kwayehlula ayisekho. Kwaba sengathi ilanga ligokhuwa phansi lapho liphumayo lalingathi liyakha la, umhlaba kwangathi ugobuba.

Ahloma ama Bomvu kumpondo zankomo eqonde khona kwa Nkosi.

Kwathi uma lithi ukufudumala kwa fika i nkungu yanamathela kuzozonke ijintaba kwavela umoya obandayo.

Kwathi uma libantu bahlle bayitshala i Nkosi, bebumle ngenwunulo yabo yobukhosi olomashi no thamoyi.

Aguba ama bomvu kwaba sengathi izovuka umfo ka zombane.

U Matomela uyena Nkosi ya ma bomvu owazala abantwana abaniuzi futhi kwakungasagonda kali noyokuba i Nkosi emva kwa

K13/ 158

Isililo sama bonvu 5

496

khe ngoba bonke babe bilindela
ngawo wonke amandla abo ubu
khosi. Kodwa wathi uma esefa
walishiya izwe ukuthi uSomashi
uyena oya kuba yinkosi esikhu
ndleni sakhe.

Mkubusa khahle kuka Matomela
kwenza igama lakhe lingaphuni
emlonjweni wama bonvu, befu
nga bethi, Matomela ka Zombane,
ngisho abafana abanane noma
besezikoleni bezwakala ngokufu
nga ukuthi ^{na} ^{mal} igama bonvu.

Usonashi ethatha ubukhosi 6

K13/158

4 Mhamba kuka sonashi nokunge
na kwakhe ebukhasini

Kwathi ukuba iNkosi u
Matomela iqiniswe ukufa yase inkho
mba usonashi, ukuthi nguyena
o yothatha ubukhosi emva kwakhe.

Usonashi ngalesikhathi wabeyi
sidlakela sensizwa esenobuhwa-
nga, kodwa ku khona abafowabo
abakhulu kunaye njengo
Nyanazane ukuyena wayesege
niwe abafazi abaningi.

Umuzi wakhe afike wawa
kha kuka kuka solo lapho bethi
kuse Ngobeni lomuzi wawu
nama shumi ayihlanu ezindlu
ubiyelwe kungathi uMqungundlovu
ka Dugane. Ngisho nanamhlanje
kusa banakala lapho izindlu
zazi khona kanye noqange lwawo.

Usonashi wathi ukuba ezwe
ukuthi abafowabo bayavungama
wakhuluma nabo ayise bonke

496

Usonashi ethatha ubukhosi

K13/158

ukuba hasheke bambeke nempela kwathi ngo Maguba zizine ngomnyaka ka 1860. ama bonvu ahlangua ambe ka usomashi abeyi Nkosi.

Kwathi iyophela inyanga kwa ngathi ama bonvu azokulu odwa, kukhona abaka Nyamazane nabaka Nhomoyi Kanye naba khe uMntwana. Kwathi ukuba kuyengena kweyesibili inyanga abaka Nyamazane badela ukuthi ubukhosi abusabuyi, bahlangana nabakhe uMntwana.

Kwaphela amasento amabili yakhukhula eka Nhomoyi ibeke enzansi.

Walihlanganisa izwe lonke usomashi akwaba bikho noyedwa osolayo, futhi wangena ngesi khathi ama bonvu lile ngenkomo zonke izinsuku umkhonto ufana naye gele.

496

Emuka kwafulu amabomvu 8

K13/158

5 Impi ya Maxamalala yeqwe sika
Khwayimba.

Kwathi nxa uZombane esebona ukuthi abantu bakhe sekhani ngesi khathi es kwafulu, wathutha ebusuku nabantu bakhe bonke wanelela ukuwela u Mzinyathi abelungu abathi i Buffalo river, wayifika ingazele i Mkosi u Khwayimba. Kodwa yaklona kwa^{thi} nxa ama bomvu ethi ayowela iNgubevu, afika afika eseyi phake ngezigaba ejmashumi mabili u Ncincida indodana enkulu ka Khwayimba.

Kwathi kumpo zankomo wayidu melisa, yabambana laze lafudumala phakathi emanzini. Yakhunyuka eya Mabomvu nge Uhlazane.

Kuthe lapho uMuntu ethi sekuqonde ka amehlo wayiphaka umfo wakwa Ngwane, yabambana weqwa izinsizwa ~~uMuntu~~ sikhuya k'Ndi u Ndi" ngadla ngenkomo kababa, kwaze kwaphuma

K13/158

496

ikhweji. Kwathi ku Mpondozanko mo yawela ekazombane, kodwa ayizange ihambe yagcina ngakho ukuwela bayithela ngethala, yaze yadla inyama iluhlaza singakho nesikha thi sokupheka no kosa.

Kwathi kunyophela isonto lesitha thw ayesebenzela ngamandla ama bomvu, aze anchitha u Khwayimba kodwa wala nje ngisho nokuba - ama bomvu ake adundutale nga phezulu ezintabeni begingqa ngisho namatshi. Ama bomvu ayesebasi nga aze abathola ngentutso encane okuthiwa eyakwa Ngajana ngoba kwambiwa kuzala.

Yalwa ke ezinkalweni yaze yehlulwa ngempela eka Khwayimba wabaleka wachona le kwa zulu, lapho wadala khona isigoo sakhe sakwa luthelaji.

Ama bomvu ngisho nanamhlaye asayidla inyama iluhlaza sekungathi

ipisiko lawo. Kutheke esebalekile u-
Khwayimba iNkosi yenzukela ngaphe
zulu enkangala, yase iyigamba londa
wo ngokuthi kuse Msinga nanamhla
nje leligama lisasetshengiswa.

Namhla nje uma ukhulumana
na ma banu ngendaba yzwe
bakutshela ukuthi bona baxosha
u Khwayimba, izwe elabo balilwela.
Lo khuke kubenza bahlale bengaghu
be ki ngoba bechi izwe elabo kanti ijikha
thi ziyashintsha.

Uzombane wazala abantwana aba
ningi, indodana yakhe yakwa Nkosikazi
kwa ku Matomela. Babengatha
ndanu naba newabo abakhulu ngo
ba sonke isikhathi babethanda sengu
thi kungabekwa bona.

Kwaphela iminyaka angamashumi
amabili wayesefa uzombane, washi
ya indodana yakhe u Matomela ebu-
khosini.

K13/ 158

496

10: Ukubusa kwa Somashi

Kuthe ngomnyaka ka (1871) 1871
wangena ebukhosini uSomashi bo
mhlaba wanke ngoba ngalonyaka
u Nkosi wase Mvoti wakhuphuka
nana bomvu akwakhelwa kwenziwa
omkhulu umgido.

Kuthe esebusa uSomashi wThomoyi
wayenesikhulu isigwe eseyinkosi
naye. Ngomnyaka ka 1875 uThomoyi
no Somashi babonana sekuphelile
ukuxabana kwabo.

USomashi wabusa bakhe kakhu
lu akuyange kuvule nombango kubanta-
bakhe, futshi behloniphana kungathi
amaveli uma bendawonye. Eba-
thanda bonke abantu bakhe.

Umuzi wakhe omkhulu kwakuse-
Ngweni. USomashi wabusa njengoyise
izombane kanye no Matemela.

Mkubusa kwama Ngwane

12

496

K13/158



Nanku

umuzi omkhulu ka Lomashi - Mzoteni,
lapho a fela khona. Vehlakle neji-
giki zisibayeni lapho ayethethela
khona amadala.
Isigodlo sakhe sigondene nesihlakle
ngenhla nomuzi.

Ukwanda kwa Mahamu

B

K13/158

496

Ukufa kwakhe kanye nokwehluka
na kwakhe no Khomoji.

Ngokungezwani kwabo abantwana
behluka na ngobubi obukhulu aban-
ntu abanye bahamba no Khomoji
abanye basala kuye uSomashi.

Ngalenkathi iniqo eminiqo yavalwa
izwe la phenduka amahlane ngoba
a Khomoji wahamba namakhulu ama-
bili namashumi ayisithupha kanye
na bantu abayisishiyagalombili.

Izindlu zabo ezinye zafunzwa izinqomo.

Kwathi lapo belala khona endleleni
behambe belwa nezizwe endleleni kusa
le kugo khukile ngoba utshani igilwane
zazibudla ngempela. Sasala isizwe
sama homu silula kungathi nezi-
zwe eziseduz naso zizo sihlasela u-
Somashi wabiza inyanga izomqiniso
yena kanye nezizwe sakhe. Kuthe ku-
fika impi yase Sanolwane wayesezi-
ndaba egudwini kuzo zonke izizwe,
naye wawathumela ngokushesha

496

AMabomvu ehlakazeka

K13/158

14

okukhulu amabutho akhe eMkosiini
u Cetshwayo. Kwakumba Inkungu edla
ilanga kanye neMbonyande noMkhatho
zwe.

Mlomashi wayebathanda abantwa
na bakhe bonke, Ezama futhi aba-
ntabakhe bangaz babanga uma
esefile. Nempela ayizange ibekhona
imibomvu evamise ukuba khona
nxa ku fe iMkosi.

Kwathi esekuzwa ukufa ukuthi
kuyangqeda wayesebathela ukuthi
uMawele uyena oyoba yiMkosi nje
ngoba nonina wayeyiMkosi kazi
eyalotsholwa aMabomvu onke.
Emva ku empi enkulu yase Sa-
ndlwane iMkosi kwasekuyigqeda
ukufa. Yashiya amaningi aMakho-
sikazi nemizi ya yo eminingi futhi
kulo lanke izwe layo. Kwenzi uMkho-
si omkhulu kwabulawa neziMkomo
eziningi aMa Bomvu engangotshani,
Kwafika naka Khomoyi nawo eze ngaso

Ukwanda Kwama Ngwane

15

K13/158.

496

isililo seNkosi. Kwaguja kwaze kwaphela amasonto amabili.

Kwathi ngomuyaka olandelayo kwe nziwa isikhumbuzo seNkosi kwa hlatswa izinkomo ezingamashumi amabili nenkomo ezinkhlanu, ama bomu ephelile no khwala bungangananzi okuphala izikhumba, indumezulu. Kwaguja izinsu ezine ubusuku nemini.

496

Nkosi ingena ebu khosini

16

8 Ukungena kuka Mawele ebu khosini ^{K13/158}

Kuthe ukuba afe uSomashi uMawele indodana yakhe yakwa Nkosi kazi yangwa ebu khosini. Umgubo wakhe wokungena ebu khosini wenziwa ngomnyaka ka 1888 ngo Lwezi ziyishumi nanhlanu, kodwa uHulumeni yena wambi ka ngomnyaka ka ~~1888~~ ngo Ngcela zimbili.

Kwathi ngelanga a be kwa ngalo kwafika ama bomvu avela ku gise uHhomozi ngoba yena wayesaphila kanye namanye evela eMvoti lapho ku khona amanye ama bomvu. Kuya bona kala ukuthi isizalo sawo wonke sikhona kuye uSomashi noma eugasa buswa uy. Afika ama Nxusa ka Hhomozi ephethe isikumba sesilo awase Mvoti ephethe uMkhonto nehawo eli waba, kungathi ligatshelwe ngobuhlalu.

Amakholwa nawo aqogana odwa amusa opondo abayishumi no pondobayisithupha. Aka Hhomozi amakholwa am thingela isibamu uNgazini.

K13/158
496

Abelungu bonke a babekhona la
pho emgidweni bathi nabo bashiywa
bajithela imali kwababomvu izithebe
eyiyithelelwa kuzo. Abelungu a babe
khona babengamashumi amathathu
na belungu abane. Kukhona neNkosi
yase Nkantolo. 'Yanyala yathi angachithi
igazi; angashayi abantu. 3 Uma efuna
ukuhlasela atshela uMulumeni.

4. Abaphathe kahle sijise nonina, naba
fowabo. 5 Angamudli umuntu engalithe
thile icala. Okokugcina yabonga
ama bomvu ngokubonakalisa uthando
lwawo kumntwana. Wabatshela futhi
ukuthi kuhle bamhloniphe bonke aba
ntu bakhe ngisho nolijise, onina na-
brafowabo, yathi ayobanjwa ngecala
lo kwedela uyoboko noma ayoshwe
ahambe e ma bomvu, yagcina.

Izimbongi lapho zase zibonga zize zi
shintshane.

Wasukuma u Mutwan v wabonga into
abantu besigwe sika Ngwane abayenzile

496 Inkosi iqinisa isizwe sayo 18
K13/158

Kwanyakaza isibaya zikhuya u banyede
Induna yakhe enkulu kwaba ngubibindin
ka Nduluzana ka Mkhutukeli. Ngakusasa
achitheka ama bomvu, kwasala abafu
wabo noyise kanye naye u sibindi, beboni-
sana naye umntwana izinto okufanele
agenz u kuzo u base kahle ahlonipheke
futhi. AmaNxasa ka Mhomozi agda
inyanga, kanti awase Mvoti agda
amasonto ama bili kuphela.

Euva kenyanza bachitheka bonke
no sibindi waya kwake. Umuzi omkhu-
lu wakubo Epiphindelweni kwa kungathi
umuzi weNkosi nje. Naye u sibindi
wayengo wa ka Ngubane, ngo ba phela ama-
bomvu laba sithi ngaba kwa Ngubane.

Ewehlo ekhatiphile abantu bonke bene-
liswa u kuba abeyinduna enkulu ya-
ma bomvu onke.

Wakhojiswa bonke onina nabafu
wabo noyise u Mntwana afanele u kubo
ndla, ba beyizintandane za khe, nempela
kwabanjalo esebusa wabondla.

Mkwanda kwa Ma bomvu 19

K13/158

9 Ukubusa kuka Mawele

Kuthe iNkosi isitakiwo bonke abantu balindela izwi lokugala iNkosi ezolisho kubo.

Kwathi ngenyanga yesithathu yaki za bonke ababincayo, yathi kubo ifuna ukwakha umuzi wayo Msinga ezinkalweni. Ama bomvu akuthoko zela lokhu, ngoba nawo ayethanda ukubona umuzi weNkosi. Yathi iNkosi ifuna ukwakha umuzi wayo ezigodini ezibili, iNgubeeu kanye no ginga ama bandea okuthiwa u Thame, okusona sigodi esikhulu. eMsinga.

Ama butho agala ukugawula izintu ngo eziwelisa u khukela. I Nkosi yaba mba yafike yakhomba lezindawo zombili. Umuzi wabo Thame yawugamba igama lokuthi kusekhakhaklanbeni, nanamhlanje u Mfowabo u Mfongosi kanye ne Ndodana ka Mtsobi basakhe khona nanxa kungahlange ne ngemphe.

La ukuthi umuzi ubon' unye njengoba kwakunjalo. Kodwa zonke izinto zisemi njengoba zazinjalo. Kwathi umuthi wayo iMhosi wase Ngubwa awag' waba nalo udumo ngoba uKhahlamba lwasa ke lwathanda ukuyolinganda neNgoleni.

Umuzi uKhahlamba wanikezwa kuMhlawengome kanye nesigodi sasotha me ukuba abeyinkhloko yaso, njengoba uKhahlamba lwakhelwa unina. Ngokunjalo noMakhasane ozalwa iMhosikazi yakhe yokugalwa wanikwa isigodi saseNgabeni ukuba abeyinkhloko yaso nomuzi wakwabo wanikezwa kuyena. Unina kaSigeze wangeniswa kwabo kaMakhasane ngakho ke ba kha ndawanye. Unina kaMabomvu uMasonyangwe wangeniswa kwabo kaMhlawengome, nabanye uMntwana wabanika izindlu ngokomthetho esaphila.

Wabusa kahle kokhulu kagange ajikhombise ukuthi yena uyimhosi

K13/158
496

Ukufika kwabafundisi

21

na phambi kwabo fowabo, ngishona
ko yise. Abantu banke bemhlonipha.

Ngalenkathi kwafika abafundisi
abaningi ezweni lakhe kodwa kaza
nge akhombise umoya wokungezwani
na bo. Wabonika izindawo zo-
kwa kha. Ngala ukwanda amasonto.

UMwangelisi odumileyo uSimon
Khumalo ozalwa u Ndengezi wafika
ngaso lesikhathi, elethwa yi bandla
lezi Kotshi (Church of Scotland) ukuba
azoshumayela izwi le Nkosi kuba
ntu. Nabo bamemukela ngokhulu
ukuqabula. Ngalesikhathi uMjoka
Somashi okuthiwa u Pitela waphenda
ka wakholwa, naye futhi wakholisa
abantu abaningi izintombi nezinsi
zwa kanye nawo wonke umuzi wa
khe wamlandela.

Ngalesikhathi abantu babengakleli
kakheli yindaba yesibalo esasina
mandla, kungathi kuzosuka
uthuthuva phakathi kwabo bo-

496

Ukwanda kwa Matomvu 22

K13/158

dwa njo. No kho iNkosi ayizange ikunake lokho ngoba kwa kwenzi wa amaphoyisa ka Hulumeni.

Abelungu base Nkantolo bancela ukuba abatshele umntanake uyaku ba yi Nkosi emva kwakhe. Wabatshele ukuthi usgu Nyonizwe abathi u Mazingo, umnawakhe wathi ngu Ma khasane. Wabatshele futhi abofwabo kanye nojise ukuze abantabakhe bangabangi uma engasekho no Nkomoyi wamazisa ngoba wayesekhona, esabusa futhi.

Ngokubusa kwakhe kahle uMawele kwa kungathi yi Nkosi yokwetshele kwa ema bomvini, kodwa abantu noma ayinjalo abazange banedelele. Indodakazi yakhe eyay Nkosazana ema bomvini u Nomadlangala ye qagcela ku Nkosi u Dinuzulu, ijinga kho, iNdodana yakhe u Majizkanize kade ifunda khona ka zulu ngoba ku kadade wabo ka jise owelanywa

Amuzi we n kosi

23

K13/158

Na kho umuzi waso Kha hlambeni.

496

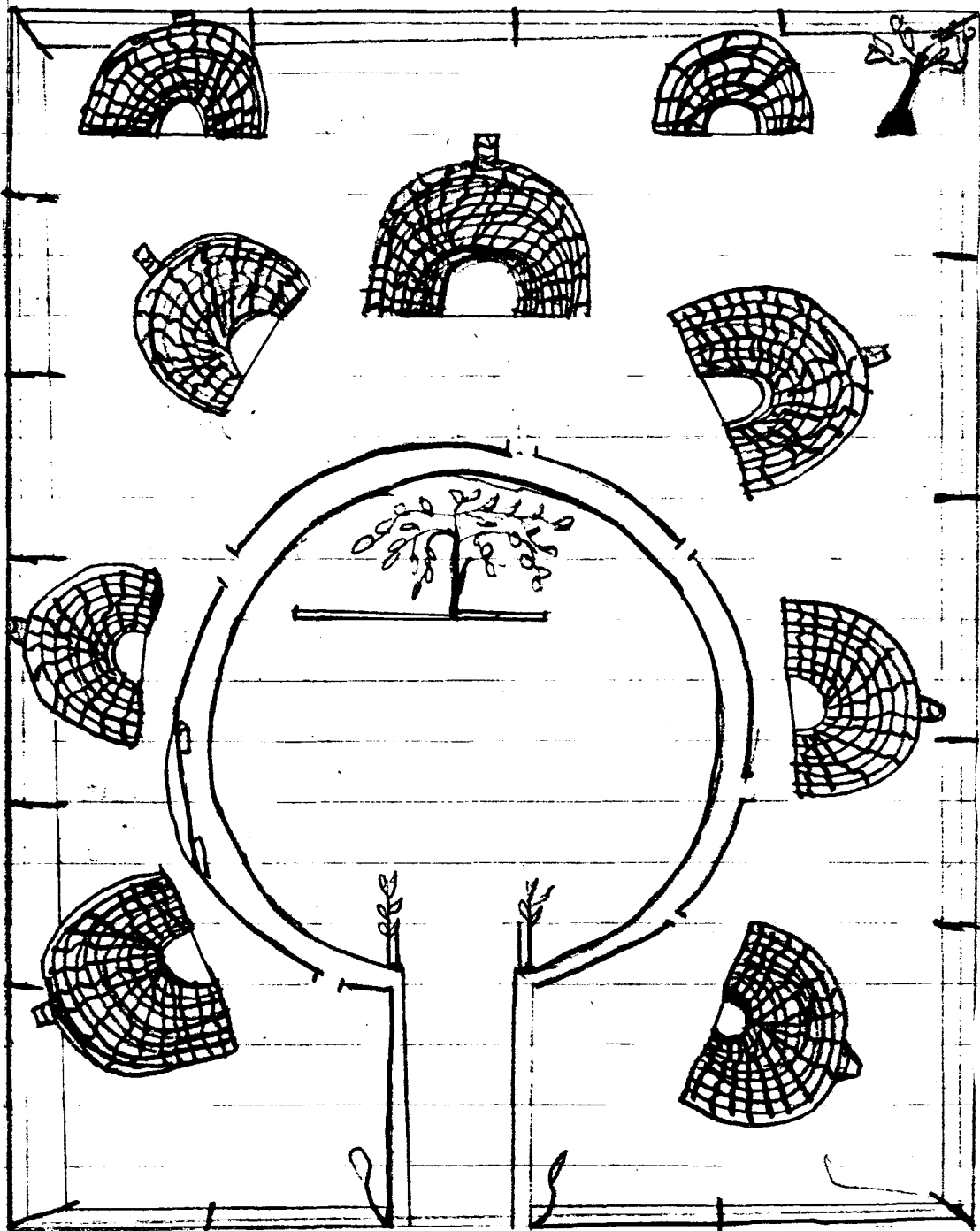

496

Mkuanda kwa Mabomvu 29

K13/158

Muzi wase Ngonyameni ka Nyoniyezwe

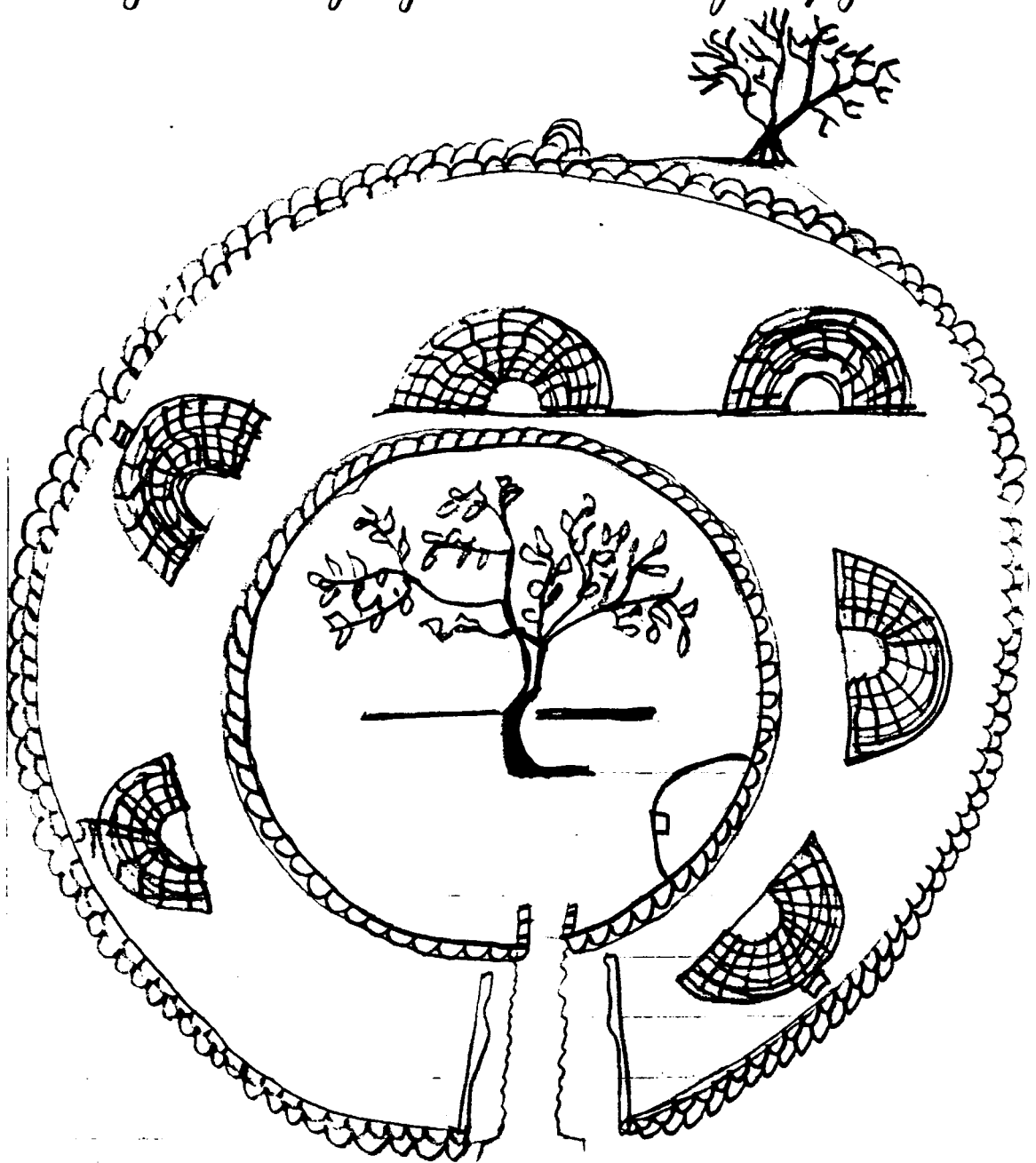

I Nkosi nesidumo

25

496 K13/158

u Nyoniyezwe. Wabamkhulu umgi do wale Nkosazana ya Mabomvu, futhi nawo ayengangokhonyane

Kwathi ngomnyaka ka ~~1900~~¹⁸⁹⁸ iNkosi yase izwakala ukuthi iyadunguzela nempela kwathi ngo Nhlaba zijintathu kwaya nela iNkosi. Kodwa yashirya izoi lokuthi ubibindi ay anibekele zijintandane zakhe, kuzo kubhulu u Nyoniyezwe. Nempela ama bomvu amvuma onke ngokhulu ukuthokozisa ngoba emazi ukuziphatha kwakhe iNkosi yase Nkantolo u lwalaqwalwa watonga kakhulu into eyenziwa ama bomvu ngoba no Makhasana waysemncane onga kafanele ukuba yi Nkosi ngalizo zikhathe.

Kuthe ngomnyaka ka 1901 u Kulumeni wabutha onke ama (Chief) Khosi wa watshela edwaleni ukuthi kuhle abantu bathelele ikhanda. Ama khosi onke ala kodwa u Dimigulu yena akaz asho lutho. U Bambada swaba ngu

496

msusi walendaba. Ahlangana onke
ama khozi enge kho u Dinuzulu azilungi
selela u kulwa no Hulumeni.

U Nkosi u Sibindi wathi esesekhaya
wabuye wacabanga ngokusha, wawu
shintsha umgondo wokulwa na belungu,
abanye bathi wakhumbula izwi lika
Mawela, ngoba wathi uzungiphathe
le kakhle ijintandane zami zize zikhule.
Wabona ukuthi ukulwa kuzomgenisa
eyi kathazweni. Abanyeke bathi wa-
thengwa a belungu. Ngisho namabombu
awanaloligqiriso lakhe ngempela ela-
gugula umgondo wakhe.

Kuthe ngomnyaka ka 1906 yasuka
impi wayesebula a belungu abaningi
uBambada begibele amakhashi. Ipar-
ke wayese thumela emabombwini ase Mooti
naka S. Bunge u Ithutkuthu ukuthi yna
usengakubelungu bangaz balwa bona.
Kodwa ama bombu ayengathandi ukwe-
le kelela u Hulumeni, kodwa u Sibindi
wathi uyombulala umuntu ongamlale

KiSindi nempi

27

K13/158
496

li: yena. Nempela abantu bemesaba
benza yonke into abatshele yona,

Wayiphaka umfoka Nduluzana,
yaphuma kukubi bekhalabengathandi,
futhi wabuye wamthatha u Nyoniyeze
waya naye empini, lapho ke kwasuka
isililo u Mdun'kulu ubona ukuthi
useyombulala. Yabambanake lempi
yase Mpukunyoni ama bomvu nabe
lungu bamchitha u Bambada.

U Nyoniyeze wathola izibongo zobungwa
zi ngoba naye wahlabana nge sibamu
eshaya emi ngemuva kukadi bindi.

Izizwe zonke zibanjelwa a Makhozi
ngalempi kodwa onke ama bomvu
a Makhozi asunda, ngoba nabanga
lwanga babanjwa ngoba bengansiza
nga u Hulumeni. Igama lika
Si bindi lagwaliseka negama lika-

Nyanuizeze lathandwa u Hulumeni nga-
ngo kuba u Hulumeni wamethenibisa
u kuthi uma efuna ukulwa akom-
tshela naye amelekelele.

Ukwanda kwama Ngwane 28

496 Ukungu kuka Nyaniyeve (ed) ebukhosini K13/158
kanye nokubanjelwa kwa khe uSibindi

Kuthe emva kwempi yase Mpukunyoni uSibindi wakabiza bonke ojise bonntwana wabatshele ukuthi isikhathi sesifikile soku ba angene ebukhosini. Nabo bathokoza kakhulu nxa beywa ukuthi yena onphathele usembona ukuthi usekhulile.

Kwathi ngomnyaka ka 1908 ngo-Nhlangule ziyishumi nanye wambeka eNkantolo. Kuthe ngo 1909 kwenziwa onkhulu unqondo wokubeka iNkosi, uSibindi wayinika izinkomo ezingama shumi amana nezinkomo ejine kanye no pondo abangama shumi amahlanu.

Lokhu kwakombisa ukuthi uSibindi wayembambele ngusfela engazidleli yena nyengama nye aMakhosi. athi ebambile ashwabadele zonke izinto zijtholayo zomntwana, abonga ngoku sho u bayede kahlanu ama bonwu.

USibindi uMulumeni wayesentshela

Ukuhamba huka Sibindi

29

K13/158
496

ukuthi uzomthatha amnike indawo
lapho ezoba yiNkosi naye. Kodwa
amabomvu akwala lokhu athi
woia awafuni ukwehlukana no
Sibindi kumle ahlale noMntwana
amfundise izindlela zokubusa, ko-
dwa u Kulumeni wamthatha
waye wamnika izigwe sase Mambedwi
ni ukuba abuse lapho abusa
khona waye wafela khona.

UNyonizwe wasala inhliziyiso ili-
mkhohlisa sengathi uSibindi uzobu-
ya kanti cha kwase kuwukubona
na kokugcina. Wabusake naye
uNyonizwe ngobuciko obukhulu.
Wagawa uNkosi kazi yakhe u
Ma Bengu ka Hlangabeza owa-
nzala u Mayizkany iNkosi.
Umuzi wakhe omkhulu kwakuse
Ngonyameni nase Msinga lapho kuzo-
lwa khona uMadvana okuyena
ezalwa uMambuzo. Owagagela iNkosi
kuzala ingakabi na Nkosi kazi.

496

Ukwanda kwama Ngwane 30
K13/158.

Ukwanda kwempi yase Nkandla

Umangwane ngalesi khathi ayenga ziwa nokuthi asakwazi yini ukulwa ngoba izimpi azigcina ku Khwayimba.

Kodwa kwathi kusuka lesidumo aMakhosi onke ezimisela ukulwa no Hulumeni no Mntwana u Dini'gulu kabanga esaba namandla ngoba bathi bonat' bayozilwela, baze bagcine. Ngomnyaka ka 1905 ubikind' wa biza inyanga okuthiwa uMswazi yawadlisa inyama ingaklinziwe isi khumba ana bomva, yosiwe futhi.

Kulempike usibindi wasebenzisa umgondo wakhe yedwa ngoba bonke abantu babelindele ukuthi naye uzo galela ku Hulumeni. UMyonizywe wamfaka ekhwapheni lakhe u kuba angaphindi akhulume lutho alubonayo noma lungafanelle alalele yna ku phela. Lento yabaphatha kab' abafowa bo kanye no yise, bethi usefuna uku mbulala ukus' angabe esokhuma

X13/158

496

U Myoniyzwe nempi

31

ebukhosini, lokhuka kwakufike ku
bakhanyele impela ngoba zonke izi-
zwe zazingabelekeleli abelungu yena
waphuma yedwa nje.

Kodwa ke u Sindi yena waynikiwe
amandla okubona izinto ezizokwe-
nyeka ngoba akazange agqulwe
umuntu kulokhu aykungondile ngi-
shonam fowabo u Mmeli wehluleka
izwe lonke lambona esey Ngonyama
engenamngani.

Wathi ukuba ayiphake wathatha
u Myoniyzwe wahamba naye, kuthe
besi Mputkungoni zadumelana izi-
ngqungqulu kwangathi iyaxoshwa
eya khe cha kwashoshwa eykwa
zulu. Wayesecela u Mvungeli u
Khumalo ukuba akathandaze ne-
mpela wathandazo, wathi ewugda
nje umthandazo yadumelana.
Wayikhuza u Mswazi, yadumela
na bawabaziziqwaba ngesikha
shana nje esincane, bewiswayizi

496

Mkwanda kwama Ngwane 32

K13/158

banu, yadumela eka Bambada yaze ya
thanda ukuzhlula izibanu, Washo
uMjoka Nduluzana wathi "Ayibambe
improfu; lapho ke baphela a bantu ba
ka Bambada abelungu namabomvu.

Bayichitha eka Bambada kodwa
yena akazange abonakale ngisho
nanamkhanje akaziwa lapho
ashona khona. Emva kwalempi
ama khosi abanjwa onke ngisho
no Mntwana uDinuzulu, kodwa yena
wayengenacala, nokho uHulumeni wabo
na ukuthi wayeparele ukuba akhu
ze abantu bakhe bangalwi noHulumeni.

Emva kwalempi uSibindi wahamba
waya enzansi lapho afike wanikwa
indawo ukuba abuse. UMyonipzwe
naye wabusa emabomvini.

Kuthe esefile uSibindi isizwe sakhe
saphathwa uMmeleli noMavovo uNdusa
ukulu. Nokho washeshe wafa naye,
kwathi ukuba abelungu babone kunge
kho muntu ozlwe uSibindi ongathatha

K13/158
496

U Sibindi no Masekwana

33.

Ubukhosi bathi kulle iNkosi yondaba
ibuye izolthatha isizwe sayo, ngoba
uMwadi okuyona ayfanele ukutha
tha ubukhosi abelungu bambona
ukuthi akafanele ukubusa.

Ngakho ke kwathi isizwe saMabonwa
sesine esasesizombekile saphinde
saphela ngenxa yokungabikho
kwabantu abakuthalele isizwe.

UMasekwana yena wayebusa
esakwa kwak kwaz kwafika
iNkosi ya khona wayesephindela
eMabonwini kanye nabaningi aban-
ntwana bakhe, noma abanye basa-
la khona njalo.

12. Uku busa nokufa kuka Nyoniyeze.

Sesizwile ukuthi uNyoniyeze wa-
ngena ebukhosini emva kwezikhulu
iziphithiphithi kukubi izwe lonke
lisadungekile. Amakhosi onke
ebashiwe ngendaba yempi. Ngakho
ke kwadingeka ukuba naye abuse kahle

496

Mnyonyezwe ebekwa

34

K13/158

ukuze u dulumeni angambeki ngesolibi
ngoba ulitandi wayeschambile.

Wabekwa induna yakhe enkulu
kwaba nguNajiji wa kwa Ngubane
Ophisweni kwesase Nzala isifunda.
Wabusa kahle impela kodwa kabange
esafana noyisi. Ngoba wavama
ukuba namacalana angagondile.
Isizwe sonke sama bomvu sambuka
samhlonipha noma enzani, sazi kahle
sonke ukuthi uyena iNkosi yohlangu.

Kuthe ngonyaka wesithathu wathume
la amabusa akhe ku Sibunge ka
Komoyi oyesibekwa ukuba ayomcha
wulela ku yise, nempela shamba
ephe the izinkonkoni zeNkosi.

Mnyonyezwe wakha iniizi eminiuzi
esabusa, emikhulu kwakujilelwa
eNgonyameni nase Msinga neninze
emincane engabalulekile.

Itonkholakhe alibutha emabonwini
kwa kuji Mpisi, yena eyi Mprofu.
Mnyonyezwe wayebhale kungathi anga

Ukwanda kwama Ngwane 35

K13/158

496

ba yi Nkosi engawathethi amacala. Kwathi ukuba abone ukuthi abantaba khe sekengale basuse umsindo, wayse biza bonke abafowabo noyise, kanye no iyse mkhulu, wabatshele ukuthi uMaizye kanye uyena syakuba yi Nkosi uMa wakhe uMadvana, nabo ayise babonga bonke impla naba fowabo.

Kuthe ngo 1918 ngozihandlela ziyishu mi nesithupha kwezwakala ukuthi iNkosi ayisekho. Ngalolusuku kwa shona ~~so~~ iNkosana ka Maobi kate nye ne Nkosazana yake uNomzila ba ka Nonoyi. Kwaba sengathi igwe lizobuba, izinkungu zabonakda phezu kwezintaba, bava omuncane uMkhizo. Bajikweza iNkosi emzini wayo eNgonyameni, abantu bonke badungeka inigondo ba khohlwa nje ukuthi kwenzwe ijani kanti kwakurwukufika kwe-Mfuluwenza eyaqeda abantu.

Ukungu kuka Majizikanye kanye, nokubange
lwa kwakhe u Makhosana.

Kuthe ukuba i Nkosi u Nyonizwe
ife amabomvu asehlanguana ambeka
u Makhosana ukuba abambele u -
Majizikanye njengoba no Nyonizwe
wayaleza kanzalo esefa.

Kusukela ngomnyaka ka 1918 ngo
Ngcela zimbili u Makhosana wamuke
lwa ukulumeni, no Mabomvu amem-
kela ngokukhulu ukuthokoza.

U Makhosana kwakuwumuntu
ovama ukungaphatheki kahle nguxa
ya Majizwe, eza khipha njalo, nokho
wabusa kahle impela eugakutha
ndi ukulwa. Ngasikhathi sakhe kwake
kwasuka isidumo a Makhabela
eshisa izindlu zamabomvu kodwa
kwathi abantu bakhe sebekhanye
beyozi phindisela wala yna wathi
u Kulumeni uzomphindisela yna.
Abantu bakhe baki uysaba benxela

MMutwana ungqina ebukhosini 37.

K13/158

496

naka lokho lokho kukhuluma yna ngoba waye khonzile ku Hulumeni.

Kuthe ngomnyaka ka 1921 kwasuka impi ya kwa Mabaso naba Shembu; iyathi iyophela sekuthethwa icala la benza kabi abo Shembu ngangoku ba u Makhasana wanikwa indawo enye yaba Shembu kanye na kwa Majosi. Ngakho ke ukuziphatha kalle kwenza ukuba u Hulumeni amcaba nge kulendaba, futhi nezikwelentu ze Nkosi u Nyonyeywe walwa nazo wazigeda ngobazaziziningi.

U Masekwana wafika ama bomvu kubusa yna u Makhasana wama mukela ngokukhulu ukuthokozisa.

Kuthe ngomnyaka ka 1928 u Makhasana wacela ukuba u Majjekanye abunge azothatha ubukhosi bakhe, nenipela ama bomvu kanye nojise nojise mkhulu bavuma ngomnyaka ka ka 1931 ugo lwezi wangena ebukhosini u Majjekanye. U Hulumeni na

K13/158

mabomvu bamamukela ngokhulu uku
jabula. UHulumeni wameluleka ukuba
amphathe kahle ayise uMakhasana,
wathi uma emhlophe uyomkhipha
ebukhosini ba khe. Wathi futhi kule
shuze zonke izinto angazagi nezime
hlulayo.

Kuthe ngesonto lesithathu iNgenile
iNkosi kwase kuzwakala ukuthi
iNkosi uMakhasana iyadunguza,
kanti kade isanda kukhipha ama
zingo okuyiwona ayeyihlophe
kuyo yonke impilo yayo.

Ngokwe nsonbuluko zingamashu
ni amabili nesikhombisa kwezwa
kala ukuthi iNkosi uMakhasana
ayisekho, kodwa kungakezwakali
umuntu wabona nje kuhlwa
ekuseni ngo ba kwafika izinkungu
ezinemvula kwangathi lizoduma.

UHulumeni washaya ucingo ukuba
ibo kisi lakhe balehlise emgungu -

U Mntwana ungena ebukhosini 39

K13/158

496

thumela ngoba laze la tholakala
ngo Mgqibelo ama bomvu elokhu
eyilindele i Nkosi.

Ngakho ke yaze yangwatsywa
ngo msembuluko ama bomvu
onke e phelele. U Mawundlu
hamtshela sijise nojisenkhulu
akuthi yena sekufanele dphatke
umuzi kajise, basigane no Halijana
bezwe sama bomvu sazama uku
ba simelakelele ngakho konke
esina kho u Nkosikazi ka -
Ma khasana.

Ngakho ke sijibona ukuthi u Maji-
zekanye wangena ngesikhathi esi
dabur kisayo athi engakabuzi luthe
nakuyise ebesemshiya, engaka
mtsheli nejindlela zoku busa.

U Ma khasana wagama ukuthi
amfundise u Majzekanye, kodwa
ama bomvu engakhandi no kho wa-
zama ukuthi aze akwazi ukujifun-
diba ijincwadi nokujibalela.

Ukubusa kuka Majizekanye

Njengoba sesizwile ukuthi wangena kwase kulimala uyise uMakhasana siyabona ukuthi kwakufanele athole umuntu ozomeluleka kuzonke izinto azizayo, kodwa akaka mtholanga.

Ekungeneni kwakhe wanikwa uMajji abe yiNduna enkulu yakhe. Ukwanda yena ngisho namakholwa efana noyise, nawo azama ukuthi amenzele zonke izinto azizunayo. Kuthi ekubuseni kwakhe wavelelwa amacala amaningi noyise futhi akazi abonakalisa uthando nabafuthi nabobaphelwa amandla.

Ama bomvu akubona konke lokhu kwenzeka kodwa awazange azame nokwenza isu lokuba babo nisane naye uMntwana. UMafetha iikhonzi sakhe simovumela kuzo

Ukubusa ko Mntwana

K13/158

41

496

le nokungalungilo. U Masekwana kanye no Eliam, ka Mrobi ozalwa u Khomoyi bathi bayazama kwa bona kala ukuthi amabomvu awa khuthalele ukusiza u mntwana futhi ngalesikhathi u Masekwana engasenamandla okuzihambela. No Mqhawe futhi ungomunye wabo labo ababazama ukuthi bayelateke i Nkosi.

Kwenzekile ukuthi ngo 1937 u Hulumeni wayesemthatha u Mntwana, wathi uoafuna akayomfundisa yena izindlela zokubusa e Mgunge ndlovu la pho ekhona. Uyise u Sigefe ka Mawele uoambambele esikhundleni sakhe.

Siyithemba ukuthi uyothi uma esebuya abesizibonile izindlela zokubusa. Munzi wakhe u Mntwana ku kwa Mandlakazi u Ngase Ngoleni.

Ukuhamba ko Mntwana

phakathi kwesizwe kukhombisa ukuthi amabomvu awakabi nabo abantu abafundile, abakwaziyo futhi ukubeka izinto ezengekayo phakathi kombuso wawo.

Musebenzi omuhle wenziwa wu Eliam no Masekwana ababuyise bamxosha u Mafutha njengomthetho umuntu otyalo wayefanele ukudingiswa.

Udizege naye ubesaphethe kahle impela. UMuzi wakhe use Ngabeni igama lawo ku Selawini ubekene no Mzingathi (Buffalo River) ngaphansi kwentaba uMsinga. Naye ke uthe ukuba angene esikhundleni so Mntwana wafica izikweletu eziningi, nokho wazama kanye nesizwe soke sanelakelela zayaphela.

Silindele usuku lokubuya ko Mntwana nozama yisiphi

4
H96

Akha enzansi amaNgwane 43

K13/158

16 Mkwakha kwezizwe sika Nkomozi

Kwathi ukuba uNkomozi afike eNlimbithwa nabantu wayesakhe khona izizwe zonke eziseduze kwa khezimesaba ngobawadlula kabi eMakhabeleni. Sanda isizwe sakhe futhi nabelungu bashesha baya ndisa indawo yakhe ngoba bengafuni ukuba azasuse izidumo.

Zonke izizwe zamemukela ukuthi kuhle naye abe yiNkosi ngokwakhe angabi ngaphansi kukabomashi. Sanda isizwe sakhe sabanesithunji esesabekayo. Wawabala amadoda na akhe izigodi zawo azokwakhe kuzo. Abantu abaningi abanye basuka kwezinye izizwe beza kuzo na befunda zonke izinto ezenziwa ama bomvu befuna nokutho la izikhundla futhi ngoba, na khu iNkosi yakisafika ingaka ijwayeli indawo yayo, abanye bazi hola izikhundla.

16 Ukubusa kwa khe u Nhomoyi.

U Nhomoyi wayyi Nkosi yo kuzalwa engakabekwa, ukukhosi babuse gazini kuyena. Wabusa kahle ngango ku ba kwathi a Mabomvu ngisho nahgekho esizweni sakhe wawezwa efunga yena e Nhomoyi.

Ukubusa kahle kwakhe kwane nza ukuba a thandwe abantu bo nke futhi kwamenza ukuba abuse isikhathi esidi ngaphezulu kwawo wonke amakhosi ase Ma-bomvini. Wabusa kwaze kwaga nwa abantabakhe futhi kwaze kwakhona abathi babamkhulu kuyena. Waze wabusa kanye naye indodana yakhe u Bunge Shushu.

Uthe uma esekhulile impela isigwe sakhe sangcela ukuba akhombe okuyena eyoba yi Nkosi. Agqana wonke amabomvu, kwathi uma selibantu bahle waphuma wange na esibaveni umsoka Matomela.

Mkubusa kwa Matomvu

45

K13/158

496

Yakhuza iNduna yakhe eNkulu
a bantw basho ubayede kwazamaza
ma phansi. Wayese phakamisa
isandla kwathula kwathunya.

Yayisisukuma iNduna yakhe ye
batshela ukuthi namhlanje ku
zo khethwa okuyena Nkosi ye
sizwe Nzonbane sika Matomela
ozala isilo. Yasukuma imbongi
yakhe yambonza kwathula
kwathi du esibayeni.

Wasukuma umfoka Matomela
kwasho ubayede kwangathi kukho
na okuzokwela kuvela phezu
lu kungazirwa, kwashaya umu
obandayo ngasoleso sikhathi.

Kwathi uma sekuthe nya kunga
sanyazi nuntu, nofinyayo, nohleka
yo, nohlebayo, sekuthule kutheni nya
Waye seshilo wathi "Matomvu
iNkosi yenu engiyibekayo si
S. Bunge." A Matomvu angamuke
lana phakathi ngasoleso sikhathi.

496

Mkwanda kwa Mangwane

46

X13/158

Waphinda wathi "MMnawe wakhe
uMsobi". Kwasuka iziphithiphithi
bengamvumi uS, Bunge nokho u
Nhomoyi wathi akasashintshi yna,
noma kwakungeyena owayifanele
ubu khosi.

Kuthe eova khokufakuka Mawele
no Nhomoyi kwase kuzwakala
ukuthi akasekho, ngesikhathiku
busa udibindi eMabomvini asenkla.
Washiya amadodana akhe euga
pethene kahle.

Amabomvu asuka izindawo
zonke, ngoba akasheshanga
ukulahlwa ng'isa yizwe zonke
za Mabomvu zonke ezase zimbu
ka abe uyise wazo, ngoba uSo-
mashi wayengasekho, noMawele
engasekho futhi. Mkufa kwakhe
kwavela ngani elingqwa umuntu
esanda kumbeka nje uS, Bunge,
sengathi wayeseqhutshwa iykho.

Mkosi ingentukhosi

49

K13/158

496

16 Ukungena kuka S. Bunge ebukhosini

U S, Bunge ukuzo akhethwe yingoba
iMkosana ka Nthonyi yayingakona
kalisi ukuhlakanipha ofufanele
ku yise. U S, Bunge wayengomca
ne utukhosi tokude naye kodwa
kwathi ukuhlakanipha kwakhe
menza uyise u Nthonyi ambone
ukuthi uyena ofanele utukhosi.

U S, Bunge uthi u kuba angene eba
khosini, babukana kabi nabafo
wabo ababengamvumi. U Msothi
no Nomangozolo yibona abatoke
la kuzala ukuthi kuhle bahambe
keze eMabomvini a senhla nempe
la, nabo bashesha baenka. Wathi ko-
dwa una kaphatheke kabi babuy.

Bafika eMabomvini wabemukela
ngokukhulu ukuthokoza u Nyoniyzwe,
bakha imizi yabo emikhulu. Ko-
dwa u Nomangozolo isithunzi sakhe
sahlala sinjura ngango ba waye
wayiswa kwazulu kaphoaze afela

498

Ukwanda kwa Mangwane

48

K13/158

khona. ~~Nabafswabo bakhe naye khona~~
ngoba wayingumuntu ongabuceli ubu
khosi wawambona nje ungamazi
ukuthi uzalwa izingonyama. UMsobi
yena wakha khona eMabomvini waze
wofela khona, nabantabakhe bakhe
khona bonke.

Kwathi ukuba bahambe eMsobi
noNomangozolo iMkosi uS. Bunge
yazala naye ukuzinga. yalungisa
zonke izindaba, nabantu ababenga-
mfuni wabuyisana nabo baze bade
la ukuthi uS. Bunge kase nakubhi-
ntshwa njengoba becabanga.

Nga kholo ke kwathi ngomnyaka
ka 1910 eMabomvini ablangana onke
awamukela uS. Bunge, noma ama-
nye awazange akunake konke lokho.
uS. Bunge naye wazama ngawo wonke
awandla akhe neupela baze ba-
klangana abantu bakhe ngoba eno-
musa eugakhambisi ubukhosi ku-
bona noma nini.

Mkubusa kwa Mangwane

49

K13/158

17 Mkubusa kwa Bunge

Ms. Bunge ukubusa wakufunda kuyise u Nhomoyi engakafingoba wahla, ebusa waze wakhula impela sebusa bobabili. Ngakho ke uthe ukuba angene ebukhosi wazazi zonke izinto afanele ukuzenza ukuzi abuze kahle.

Ms. Bunge ukubusa kwakhe ku fana nakho kuka Nhomoyi ngo ba ubathanda bonke abantu bakhe ngokufanayo. Akazithandi izimpi njengoba amakhosi akithi aye phila ngokuhlasele. Izwe lakhe nanamhlanje uliphe njenge Nkosi efundisiwe, uthando lwakho kubantu bakhe ngomnyaka ka 1930 ulubona kalise ngokuba khela isikole sokufunda. Lesi sikole siyohlala sike yisikhumbuzo kubantu bakhe noma engasekho.

Uma bonvu amthanda wonke ngangokuba nenpilo yakhe ibo-

44
496

nakala isezandleni zaso sonke izizwe sakhe, ngisho nazo ejinye izizwe za Matsomvu zithi uma zibekisa ame hlo kuye zibone ukuthi uyi Ngonyama ya Matsomvu esephelile ngoba sebafana Mawele no Nyoniyezwe.

Yena uyabathanda bonke abantu na babafowabo, ngangokuba, nalaba baka Msobi uyababiza uma efuna ukubabona, noma kukhona ozogca gca uyahambe ayobonana naye.

Mkubusa kwakhe kwanelisa bonke abantu bakhe, futhi naye seku fanele ukuba abuse nayo indodana yakhe ezoba yiMkosi emva kwakhe. Ukuzi nayo ukwazi ukuthi uma ifuna ukubusa kahle ibonele ku yena, kuzozonke izinto azuzayo.

IMkosi uS, Bunge sinikeza kowa mdala amphathe kahle afundise abantwana bakhe yonke inhloni pho uMthomoyi afundisa yona angummeli abantwana bakhe borabane.

Mkwanda kwa Mangwane

57

496

K13/158

es amasiko ayo zonke

Siyazi sonke ukuthi zonke izigwe
znamasiko ayo awehlukene. Na
Mabomvu anamasiko awo nawo
omdabvu.

Isiko lawo elikhulu ukuthi wo-
nke uMntwana wabo bangqune
umunwe omuncane esandleni uciki-
cane. Lokhu kungaphawu (aw)lwabo
bonke, zonke izigwe zabo ziyaluhlo-
nipha, futhi lubukeka lubafanele.
Umntwana onganguniwe aka
bonakali kahle ukuthi swakhona
ngoba bona ubabona ngendiki.

Ngakhoke angenayo uze utbuzwe ufa-
ne nezincwadi zakhe ukuze ukho-
lwe. Ngakhoke sengathi amabomvu
angeyi ke ukungama izingane zawo
njengoba amanye angasihloniphi
izigwe sawo esegalile ukungazinguni
izingane. Ukubulala amasiko esigwe
kubulala sona isigwe ngobolwaso.

Isiko elinwe elisemthethweni

Uzwe lwano lwa Mabomvu 53

K13/158

496

wesigwe sonke ukuthi iNkosi
uSomashi ihlonishwe ipisigwe sonke
ngenxa yokubusa kwayo kahle.

Ngakho ke eMabomvini akushiwo
ukuthi yi "hhashi" esikhundleni sa
lokhulu bathi yi "ple", beshongoba
behlonipha iNkosi. Njengoba na-
kwaZulu akushiwo ukuthi yi Mpande
esikhundleni kuthiwa yi ngoba,
beshongoba behlonipha iNkosi u-
Mpande swabusa kahle kwaZulu
isikhathi eside. Ngokungabusi isikha-
thi eside nokungabusi kahle sekwenze
aMakhosi alandelayo angayitholi
lenhlanhla enkulukazi phakathi
kwezizwe zonke.

Maningi ke amasiko awenziways
njengezambo, amakhubalo, ukubu-
yisa, lokhu kwenziwa uma kulima
le umuntu endala wesilisa.

Isiko lika Nomkhutbulwana nalo
lisekhona, ukwehekela, kodwa
aseqela ukunophangana abasawakandi.

21 Ama butho esizwe sika Somashi

Maningi ama butho alesiwe sika
Somashi amanye asegala nokukho
hlakala nakwabadala, abakwazi
ufakazonke izinto ekhanda banga
zikhohlewa. Lamabutho alandelayo
ngiwathole nje nami ngihambe ngi
buza kwa badala ngakhoke awazu
landelana ngobudala bawo.

Umdlondlo

Izimfene

UMkhathazwe

Ama Ngqwazi

UMagolwane

iSiziba

IMbanyande

IMvaba

Impofu

Impisi

IMkungu'dlilanga

Ama butho ase Matomoni una beko
bathi angamashumi amabili, nokho
kodwa akukho muntu osawago
nda kahle wonke.

Ukuqhutshwa kwa Mahomvu

65

K13/158.

496

22. Intuthuko yase Mahomvu asenhlaleni.

Abantu sebegalile ukuba nejinto zabo abathengisa ngazo, abanye batshelile amahlathi ka watela. Izimoto sezibo nakala zingena kweninye ini zi zithwe lwe izimpahla.

Umhlabaathi abantu base Mahomvu bayawuvile ~~phela~~ ukuvulima. Nokho ama kholwa nabalimi bayazama ukuthi kuhle umhlabaathi use thengi swe ngazo zonke izindaba. Ngakho ke abase msinga phezu sebegalile ukuthenga zonke izinto zokulima, seke nomhlangano waba futshi wokuthi uma befuna izinto zokuvundisa ba khiphe imali bonke, bayilande kanye kanye. Abalimi impela nabo bakhuthela wokuzama kwabo ukumisa izindawo ezona kalayo (soil erosion) kungathi kuzophumelela.

Izikhole nazo sezigalile ukwanda noma bese khona atangafuni nokuyizwa nje indaba yempunda.

496

K13/158

Abantwana bakhona behevama njalo ukuthi bagcine encwadini yesine noma yesihlanu bangadluli. Babonaka la namhlanje kukhona abadlulayo bafunde imisebenzi ehlukeneyo gempucuko. Into edumazayo ukuthi abantwana ba Makhosi abaningi abafundiswa, ngoba kuthiwa bazokona kalasuma befundile.

Phezulu eMingqa abantu sebekaningi kakhulu ngangokuba izindawo zamadlolo nokwakha azisathola kabi kakhulu. Futhi amakholwa asegalile ukubuya zonke izindawo zawo zingangenwa lutho.

Umthetho omuhle wempucuko wabekwa yiNkosi u Majjekanye wokuthi abangakholiwe kuhl'abanike ithuba ama kholwa emgagweni wawo; nawo ama kholwa abanike lelo thuba abangakholiwe. Izindawo zebola iMkosi u Makhosana yawanika amakholwa, no Majjekanye futhi wagenutela

Ukughubeka kwa Mabomvu

K13/158

55

496

Wathi kulle am akholwa ayozibala
e Nkantolo nempela hafite abela.
ngu bayuyibona indawo leyo bayw...

Imigwaga isigalile ukuba ivela kuzo
zonke izindawana ezisemahlane.
Izwe lase Mabomvu lahluka swe wu
shukela phathi elinye lighubeka ka
hle, masinga futhi elingase Mzinga.
Elinye lighubeka kancane futhi
na ma kholwa abukeka engawa
ningi. Ngalokhu ke sekubona kala
sengathi isigcino bonke abangase-
Mzinga bayoba am akholwa bonke.

Izindawo zamabandla nazo seza-
nde nalo lonke izwe, nazi ezinye
zazo ezibandla lase Scotland:

(Collessie)	Elmakhandeni
Overton	Oshame
Buxhill	Ogqwa
Nocomboshe	

Ezibandla lase Duthela (Duthen)
kwa Manggashaza.

Ezibandla lase Thopian sinye.

23 Limo selizwe kanye nezinto ezitsha
lwa kulo.

Lelizwe lase Mabomvini lahlukani-
swe u Thukela phathi. Improfane futhi
ilahlukanisile, (moor River) kanti ne
Nadi ilahlukanisile. Sike lihlale iji-
nsuku eziyingi lingavakashelani,
imifula igewele.

Ngale ngase misinga lahlukani swe
iNgubovu, no Thame okuyona mfu-
la emikhulu kanti ikhona nje
neninye kodwa nincane njengo
Mbono okuthiwa uMtshukwini.

Izintaba zase Mabomvini ziningi
kodwa azizinkulu zincane impela.
Intaba enkulu kunazo zonke u
Msinga bese kulandela uThakwe
eyokungcina uPhisweni indeke yona
kodwa zincane impela. Umsinga
nakwa Thakwe kubanda kabhulu
impela ebusika ngoba ziphake
ne lezintaba. Umsinga uneninye
izintaba tshana ezinx incane. Kodum

Izwe la Matomvu

K13/158

496

ziphakeme nje nge Nyonyana kanye ne Hiteni lezindawo zivama ukuba neqhwa ekusika.

Izwe leli la Matomvu liphakathi kwa BaThembu, uMajazi uMabaso aMachunu, uZondi, aMakhabela kanye noZulu ose Ohudeni lapho lahlukaniswe uMjinyathi.

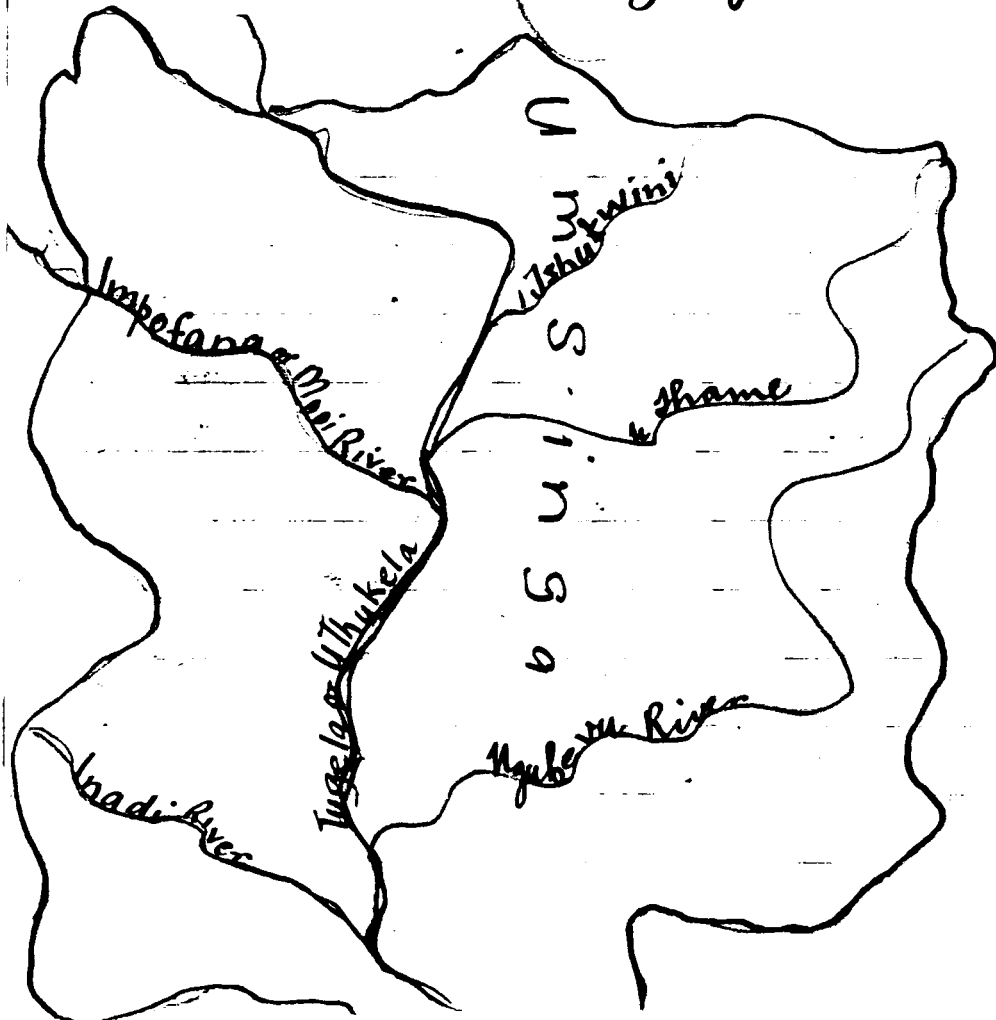

496

Ukwanda kwa Mangwane

60

K13/158

Uzinto (ezithola) ezithola kala kulelizwe
 niningana. Nazi eziye zazo nazi ezitho
 la kala kakulu. Ummbila, amabele,
 ubantshisi, amazambane, uwatela
 nemali futhi ibonakala ikhona ko
 dwa abelungu abakalitholi isu loku
 yimba. Amalale futhi kwezinye
 izindawo ayabonakala ukuthi akho
 na kodwake alinambhlanhla bali
 zwe.

Lelizwe kuzozonke lezinto esengi
 zibalile lidinga abantu abazolikhu
 thalala, balilime. Nezincomo ziningi
 impela kodwa utshani sekuyaphela
 ngoba nendawo isindane.

Izinyamazane zizazingelwa njalo
 yonke ininyaka uma inkosi
 isizivulile ukuba zizingelwe.

Mkosi izozingela izinyamazane 61

K13/158

496

zu Mkhuphuma kweNgina

Kwathi ngomnyaka wethathu
engenile ebukhosini u Mayizkany
wamema enkulu ingina yesizwe
sake sonke. Kuehla abantu abo
ningi ukuzozingela bephephe imi
khonto nezibamu. Bagala ukuzingela
la esifundeni sase mkhuphula bekhosi
sa u Thukela nyalo, nayo iMkosi
ikhona babulala izinyamazane
eziningi bengakafiki eMadi, nokho
iMkosi yathi kule baghubekela
phambile. Babala izinsuku ezine
kuthengolwesihlanu, kwavaka
isilo ngase buyeni sabulala izinja
ezijisihlanu nabantu ababili.

Sathi uma seithi siyakhwela
kowsithupha, wayishaya ngesiba
mu "MMkafulafidi umathumbu
andawanye no inyaka", Enwa
kwalesi kwaghamuka (sendoda)
ingwe; Wayishaya yaze yawela phe
zu kwesinye. Izinyamazane eza

196

496

X13/158

bulawa ngalelilanga zagaabeka kungathi zi phelile. Na bantu sebe yimilalalandle. Bedla zona izinyamazane nokudla ababekuphethi umphako.

Kwathi sebe yofika o Phisweni base bebululele izinyamazane ezinyamashumi amahlanu. Kukhona nezinkonkoni eziyisithupha. Izinyamazane zeMkosi zagzalandwa ngenoto yayo seze hule abantu ngoba nabo bengasena mande kade bakugcina ukudla okuzwana nomzimba.

Mkosi emva kwalengina yathu mela izikhumba zayo kwabakwazi ukugophi, ukuthi bayqophele iziya ya, nezinyobo zayo. Izighova ezibekakayo iMkosi yazi hola ngayo lenkathi. Oyiye nabofuthi bathola izighova bonke.

Emva kwalokhu iMkosi yabiza omkhulu uMkhosi. Akabomvu aguba izinsuku ezine, iMkosi yahlaba ishumi nenkabi ezine, kwabuswa impela.

496

25 Ukubandlululana kwa Mabomvu,

Kasizwa ndawo ukuthi u Matiwane nomama u Ngwane behlukana nabafowabo ngenxa yokubandlululana.

Kuthe uku ba u Zombane azale abantwana abaningi kanye nabafowabo kwadaleka ubandlululo.

Namhlanje kukhona abazibiza ngokuthi bona bangabakwa kwabuzela sekaganana bodwa kanti abantwana baka Ngwane bonke.

Emva kwalokhu kwavela abanye futhi bakhe u Zombane bathi banga baka Bongo inclodana ka Zombane.

Labake abavumelananga kahle ngoba kwaze kwathi e kugcineni bonke babuyela khona ukuba babizwe ngo Ngubane u khokho wabo, kwasale sekuba yisithakazelonje u Bongo futhi ne Mkosi yayingakutla lokhu.

Kuphindile futhi kwavela abathi bona bafuna babizwe ngokuthi bangabaka Matonela nabafuthi

496

Ukwanda kwakhangwane

K13/158

64

abazange ba phumelile. Kuthi ngomnyaka ka 1920 kwavela abathi bona ba ngaba ka Somashi abanye bathi bangabaka Nhomroji. A Mabomvu akhlangana onke awuchitha lomoya wo bandlulo lwesizwe sika Ngwane.

A Makhosi onke ase Mabomvini ayazama ngamakhulu amandla ukuba isizwe singehlukani, sibizwe ngo khokho waso u Ngubane njalo. I Mkhosi u Makhosane yena wayethi uyomkophha nokuba amxoshe umuntu owehlukani isizwe zombane.

Abanye bayagauana kodwa ubu hlotso obukhona kubalimazele inzalo yabo, nabo futhi bangaphatheki kahle, kuya yonke impilo yabo bahlala bezondaya. Indoda isha ye i Mkhosikazi.

Siyabona ukuthi a Makhosi azokubekela umthetho lokhu kungenzeki ngoba kubulala izigwe lawo.

Mkubusa kwa Mangwane

65

K13/158

496

26 Mkugcaga kwe Nkosazana

Kasizwa ukuthi ukhona omunye uMfana owazalwa no Mawele wa phila, no ma no Nyoniyezwe, ngisho ne Nkosi u Majizekale. Cishe ukuthi bonke abantwana baMakhozi ba ngabodwa nje.

U Mawele yna wazala u Nomadlangala swelanywa u Nyoniyezwe. Waysethanda lomntanake, esho nokusho ukuthi ufunakubona umgqaco wakhe uma esaphila

U Nomadlangala waysethanda kwazulu, iNkosi u Dinzulu. Kwathi ngomnyaka ka 1888¹⁸⁹⁸ wagcagela kuyona iNkosi u Dinzulu. UMatomva egwele eGangei khanyane naye u Mawele ekhona amnika amashuni amane em ali yokucimela kwakhe esizweni sikayise. UMatomva aguba nozulu waguba kwaphe

la izinsuku ezintathu kungathi umge-
go nya phambili. Amashuni ana
thathu ezinkomo awaphansi.

U Nkosazana yalotsholwa ngama-
shuni amane ezinkomo, u Zulu
emningi wayikhi phazonke zaphe-
lela. Phela u Nomadlangala wafika
wabe kwa waba yi Nkosi kazi
yesizwe sika Zulu. Kodwa akazange
athole inzalo yaze yafa iNkosi.

Ingakafi iNkosi yangeniswa unina
ka Nyawana kwakhe, nokho kwabo
nakala ukuthi u Nyawana kanama
adla okuphatha isizwe esikhulu ka-
ngaka kwase kungeniswa unina
ka Maphurizana u Solomon.

U Nkosazana le isekhona yona
ekhona kwazulu.

Athi ukuba afike ekhaya aMabo-
mou iNkosi u Mawle yabiza wonke
aMabomou yenza omkhulu uMkhosi
wayo wokubonga; Mbikindi wakhulu
na wabonga zonke izinto ezenziwe isizwe.

Ukubusa kwa Mangwane

67

K13/158

22 Amagama okugqibisa esizwe

496

Hlaseya Zulu

Wi, ndlu yomkhonto zikhayi zethu

Wo-ho

Hlaseya Au- hlaseya au hlaseya-

Wi, ndlu yomkhonto zikhayi zethu

Wohho.

"

"

"

Shisi, izwana zomkhathazwe

Uyazishisizizwana zomkhathazwe

Shi-hho, uyazishisizizwana zomkha-

thazwe Shi-hho ngokashisa

aba kude ngomkhathazwe

Shi-hho uyazishisizizwana

zomkhathazwe Shi-hho uyazi-

shisi izwana zomkhathazwe

Nkosi.

Yeka amadoda eziweni maningi

abuzibutho, abuzibutho leNkosi

Gumede we Nkosi Wo-hha yehhe

kanti umunqunela Nkosi.

28. Izigodi zaseMabonivini asekhla.

u Thame	i Nhlunga
u Mbono	i Wolwane
i Ngubovu	u Solo, i Ngoleni
i Ngabeni	u Mkhuphula
u Latha	
u Phakwe	
i Nkulungwane	
u Mbonja	
a Traqulusi	
u Gcobanyawo	

Zonke lezi igifunda zinezinduna zazo ezithetha amacala amancane phezu kwazo Ndunakulu othe the isizwe sonke nga phansi kwe Nkosi.

Ezinye izigodi zincane ngakhoke zingena kuzo lezi ezikhulu.

496

29 U Mhlawengome nesigodi sakhe

U Mhlawengome omunye wamadodana ka Mawele ahloniphekileyo. Umuzi waso Khahlambeni wanikezwa kuye kanye nesigodi saso Thame sonke. Ukuye u Mhlawengome a hole ichopho lapha encwadini ijingoba ukathanda bonke abantu akakhethi futhi nabafowabo zonke izinto ezikhupha mizi yabo bazibika kuye ukuba azilungise.

Akekho phakathi kwabantwana be Nkosi olung njengaye. Ulunge sengathi akasiyo inkosi. A Mahonwu suke uma esephelile udlula yna a wehlule ngokulungana nangohando lwakhe.

Uthe ngosithathi umfowabo u Ellison ka Msofi ka Mhonyazi efika kusena eela indawo yo kwakha eduze kwakhe wamnika namasimun okulima ngoku khulu ukuthokoza. Ngakhoke

496

Mkwanda kwa Mangwane

K13/158

70*

u Elliam wabona ngalo leli langa ukuthi umuntu omthandayo u Mhlawengome. Naye wagala ukuthi noma injini aye uzayo angayenzi engantsheleli yena.

Usebonakala sengathi usewa Msobi phakathi komuzi, Ngoba ngisho na bo bonke oyiye abakhokhela waye. MMntwana u Mabomvu ulungile impela naye, kuthi khona umuntu embona kube sengathi angaye omba ze ukuthi swaphi, ngoba uyihwanga. Kodwa ke indiki yona iya kuthela ukuthi u Ngubane!

End. S. 49C