

STAIRCASE SECTION
 1:50

10mm end plate welded to stringer end.

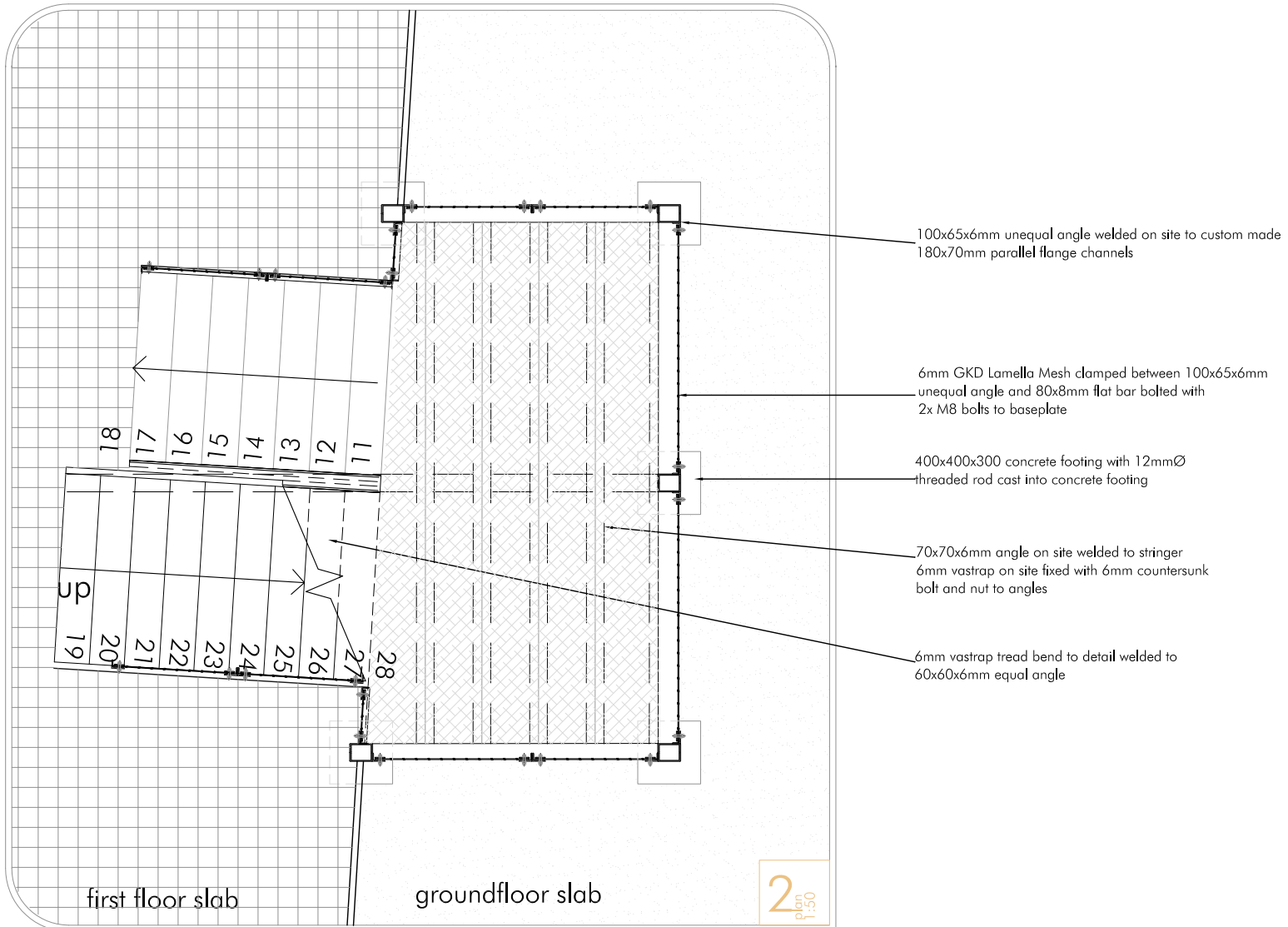

STAIRCASE PLAN
 1:50

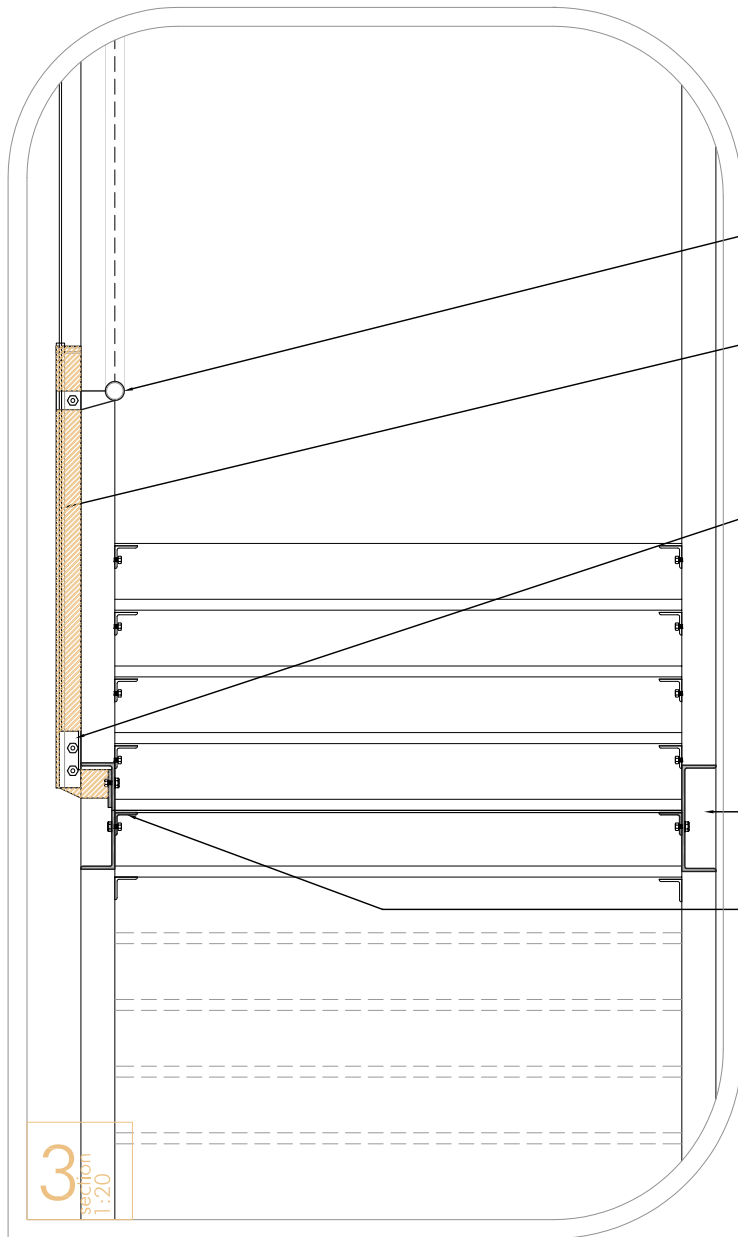

custom made hot rolled 51x2mmx2,42kg/m circular hollow section handrail welded to purpose made 10mm thick fixing plate fixed to 100x65x6mm unequal angle

6mm GKD Lamella Mesh clamped between 100x65x6mm unequal angle and 80x8mm flat upright bolted with 2x M8 bolts to baseplate

purpose made 10mm thick steel railing fixing plate bolted with 2x M8 bolts to 220x80mmx26kg/m parallel flange channel stringer

220x80mmx29kg/m parallel flange channel stringer

60x60x6mm equal angle welded to tread and bolted to stringer with 2x M8 bolts.

HANDRAIL DETAIL

1:20

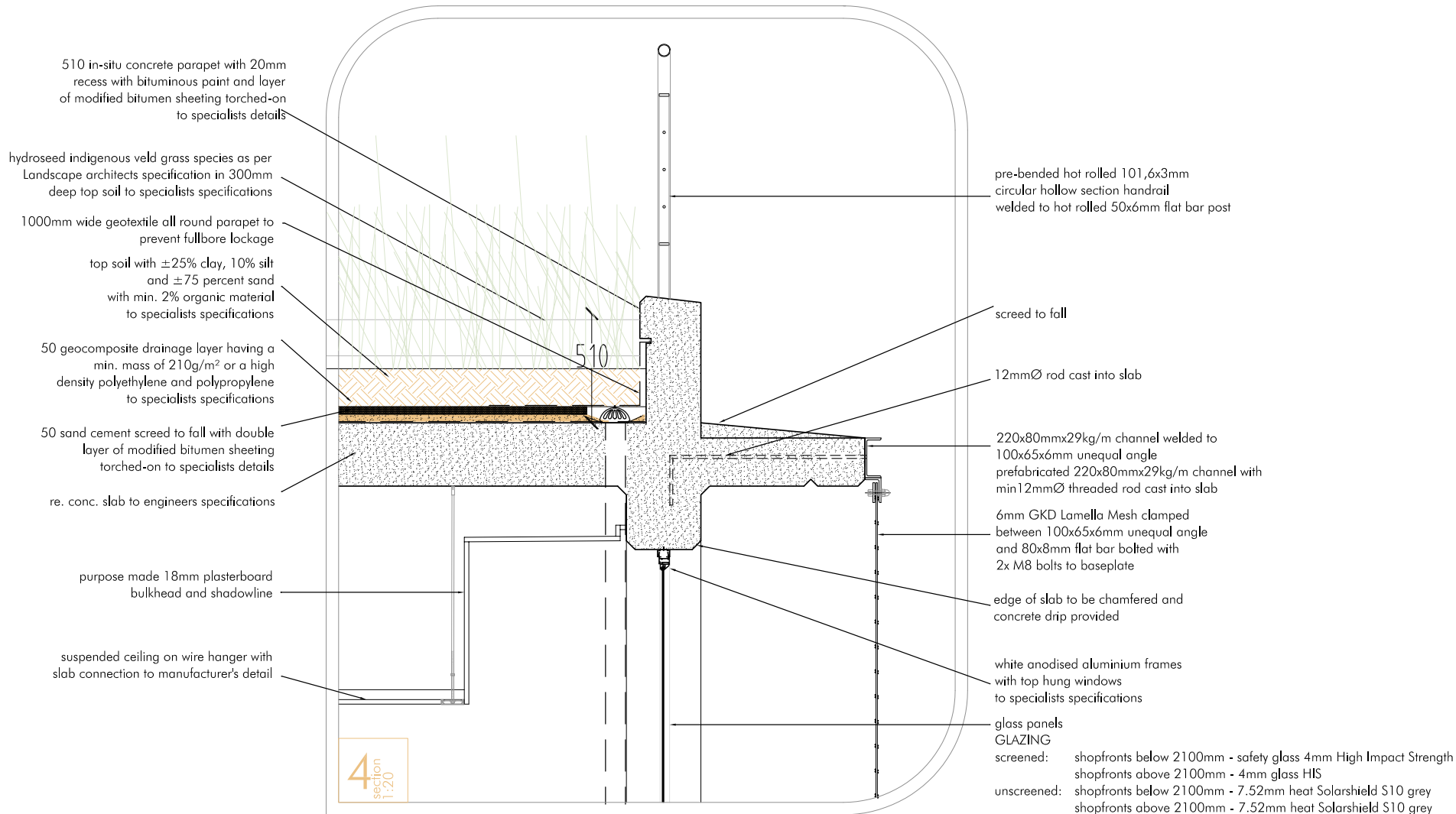

SUN SCREEN DETAIL
 1:20

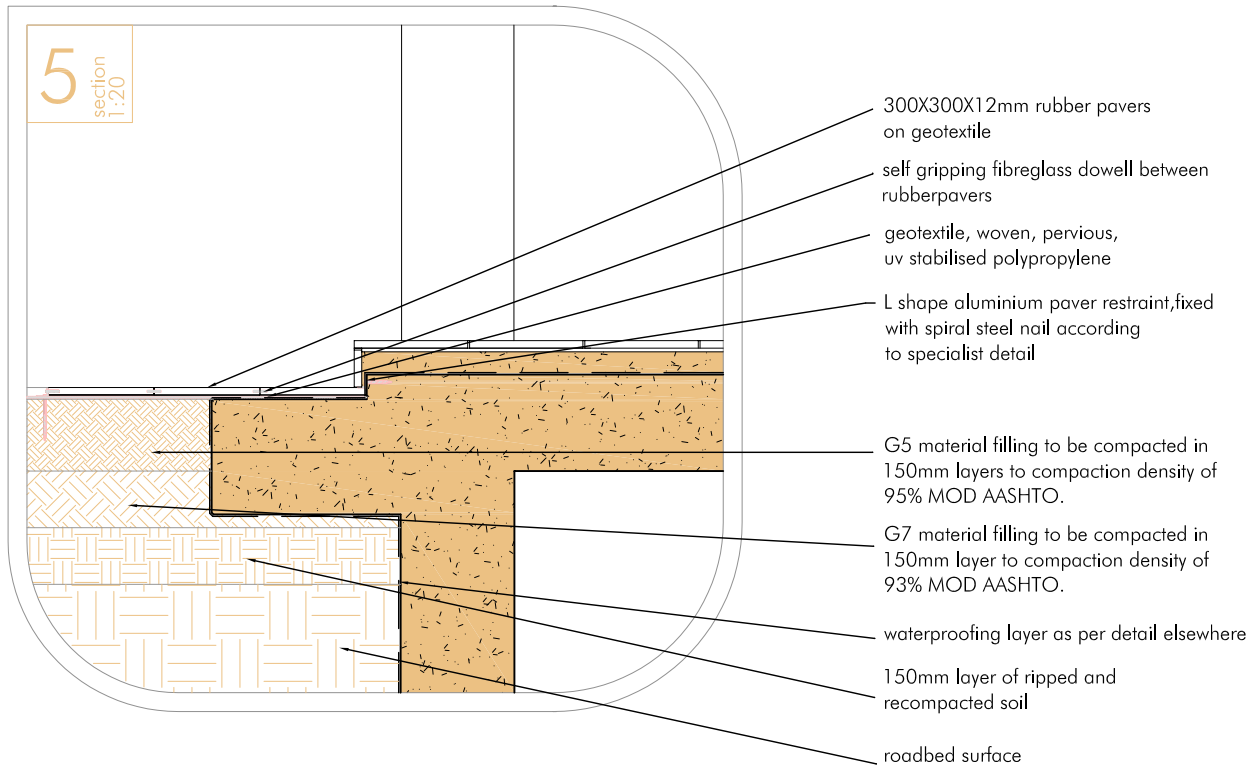

RUBBER PAVERS DETAIL
 1:20

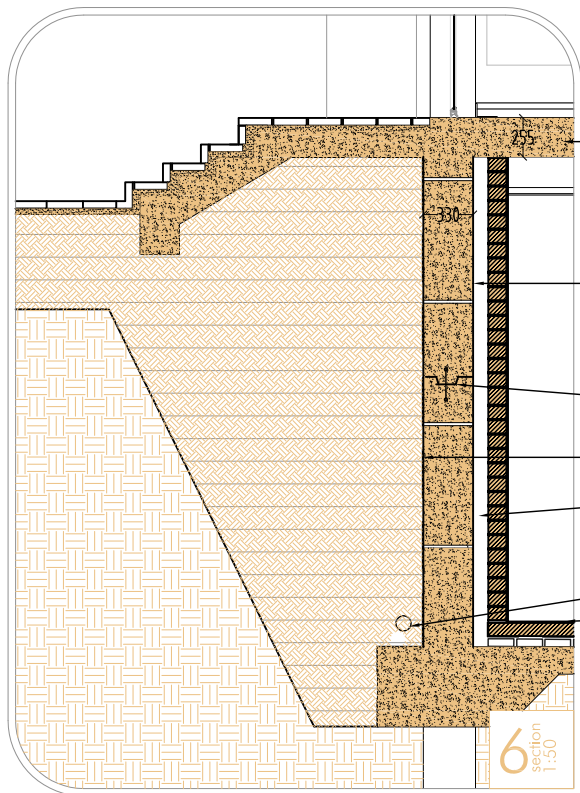

- 255 supported r.conc. slab to eng. design, on 300x700 r.conc. columns also to eng. design. slab soffit to have off-shutter finish for fixing of service pipes and ducts
- excavated ground fill to be compacted in 150 layers to compaction density of 90% aashto
- r.conc. retaining wall on r.conc footing to eng. design. shuttering openings to act as weepholes for reduction of ground water pressure
- construction joints to eng. design and spec.
- bituminous waterproofing layer
- 120 wide cavity concealed by half-brick protective layer. Air brick to be provided in wall for ventilation of cavity
- 100Ø high density Polyethylene Geopipe to drain excess underground water
- 100 mesh-reinforced conc. floor slab on 0,45 polyolefin damp-proof membrane on 50 open-jointed conc. paver cavity layer on 150 no-fines conc. surface bed. top of surface bed to have min. 1:80 slope towards sump

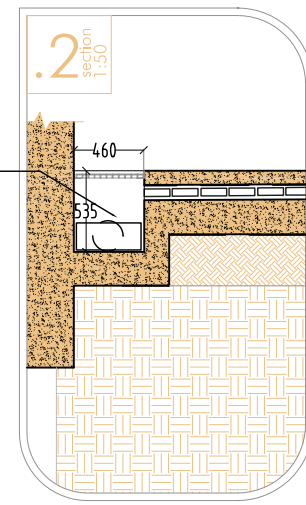

r.conc. sump with sensor-activated mechanical pump system connected to stormwater system. wrought-iron cover and grille by specialist

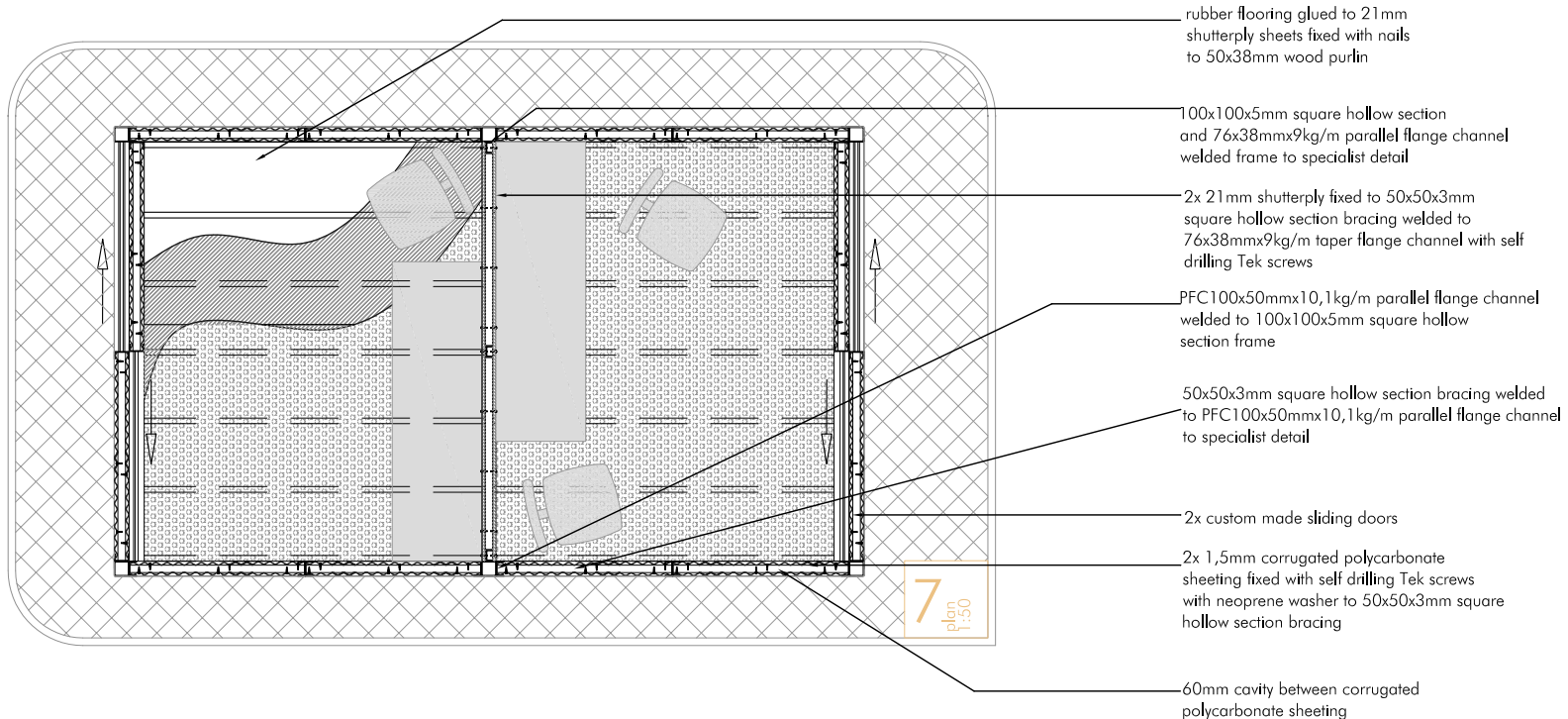

TRADER BOOTH PLAN DETAIL
 1:50

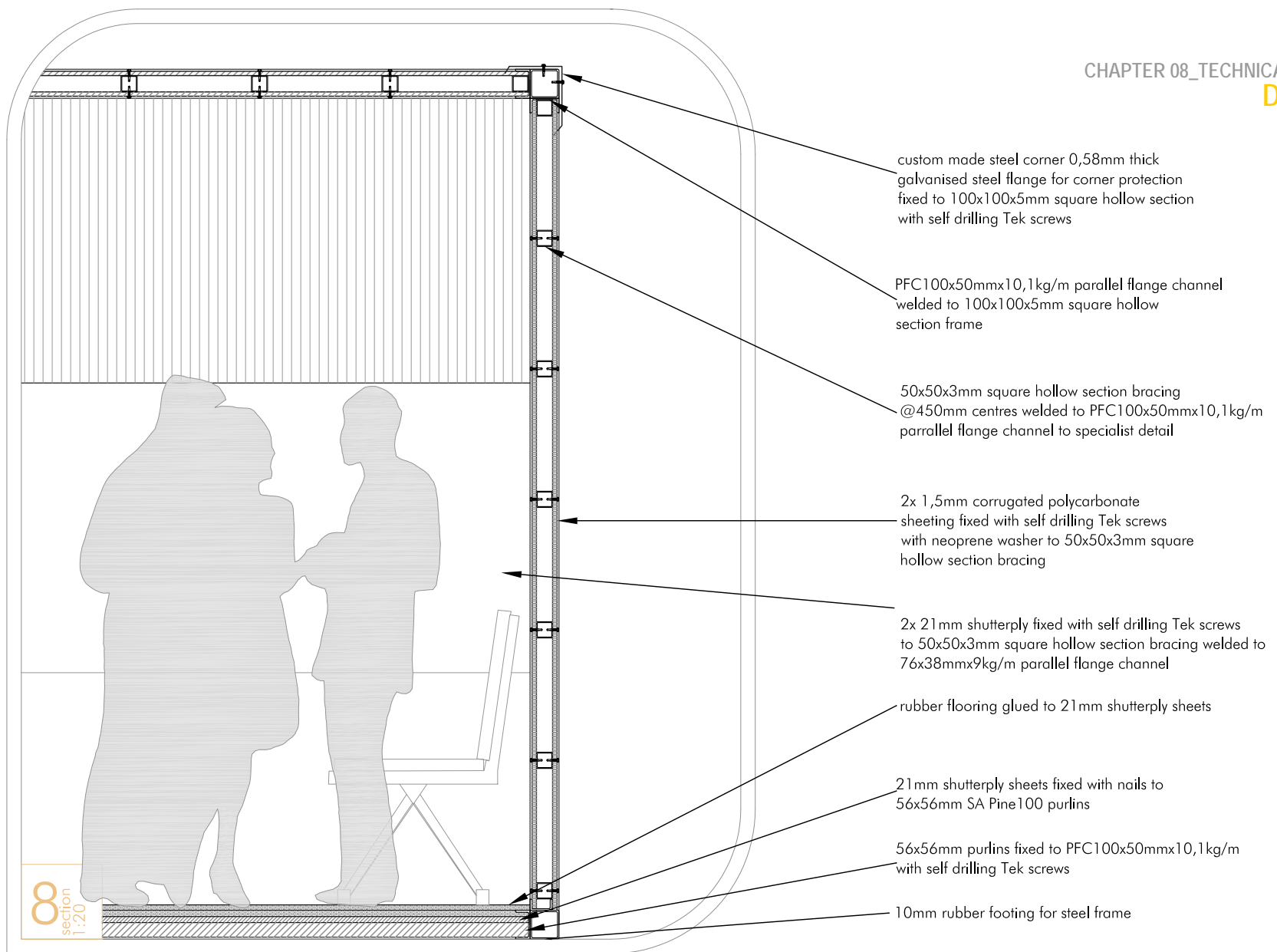

TRADER BOOTH SECTION DETAIL

1:20

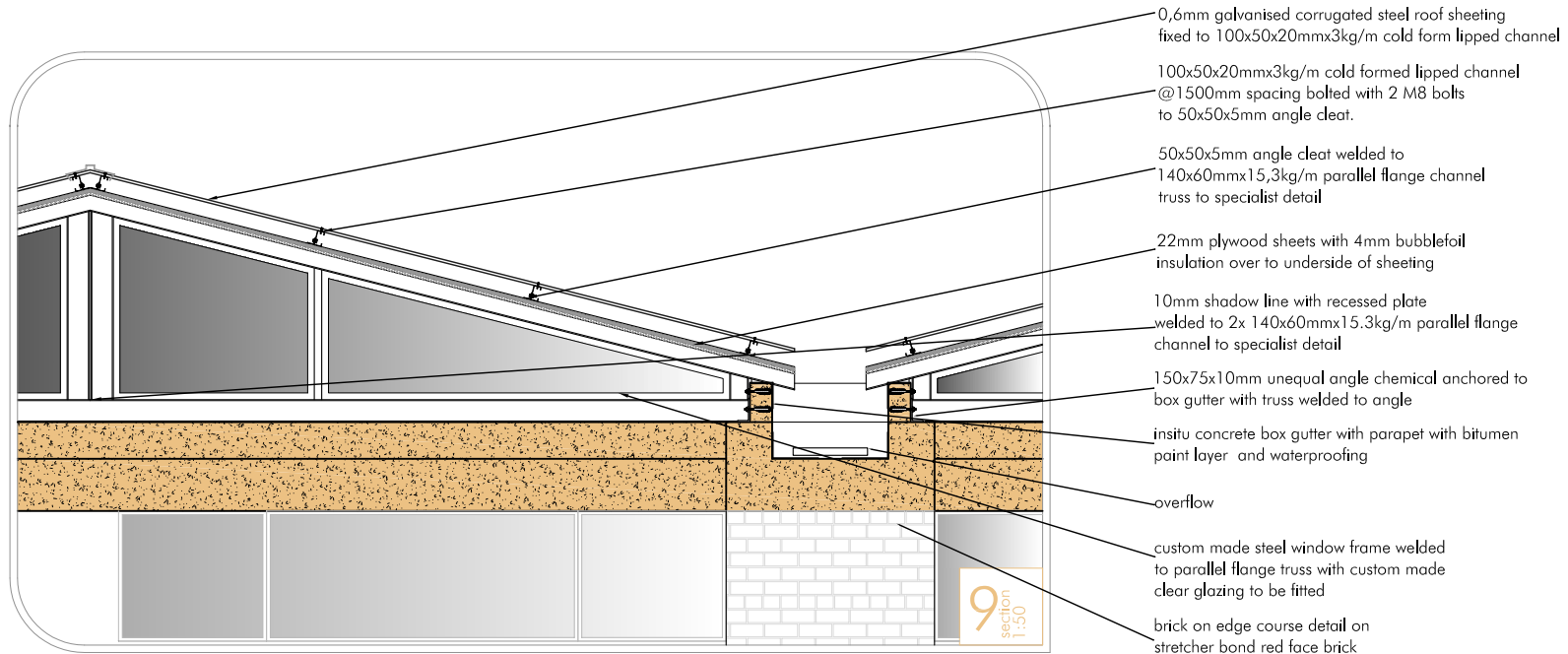

SIDE WING ROOF TRUSS DETAIL

1:50

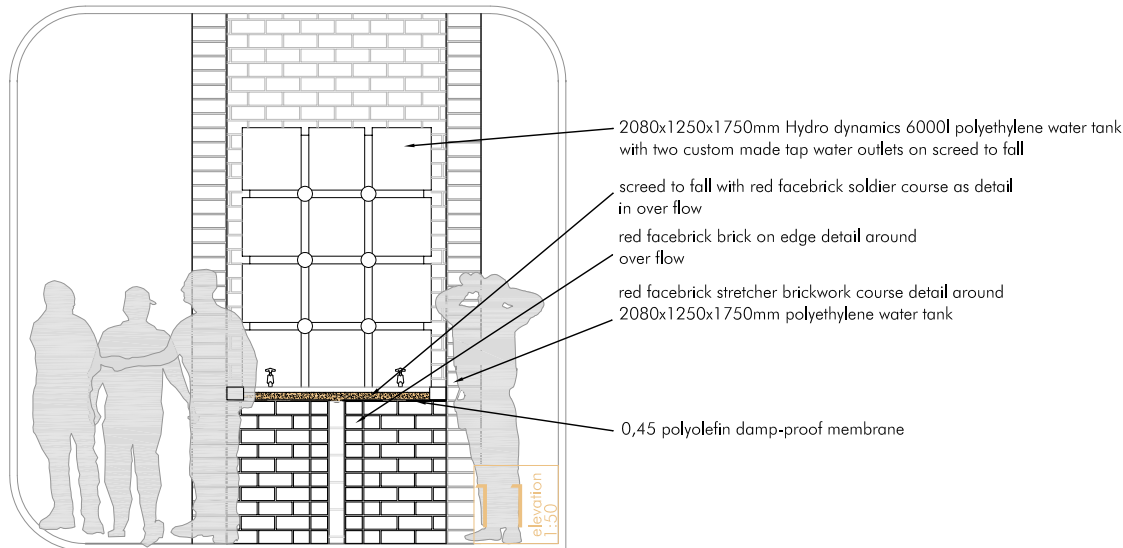
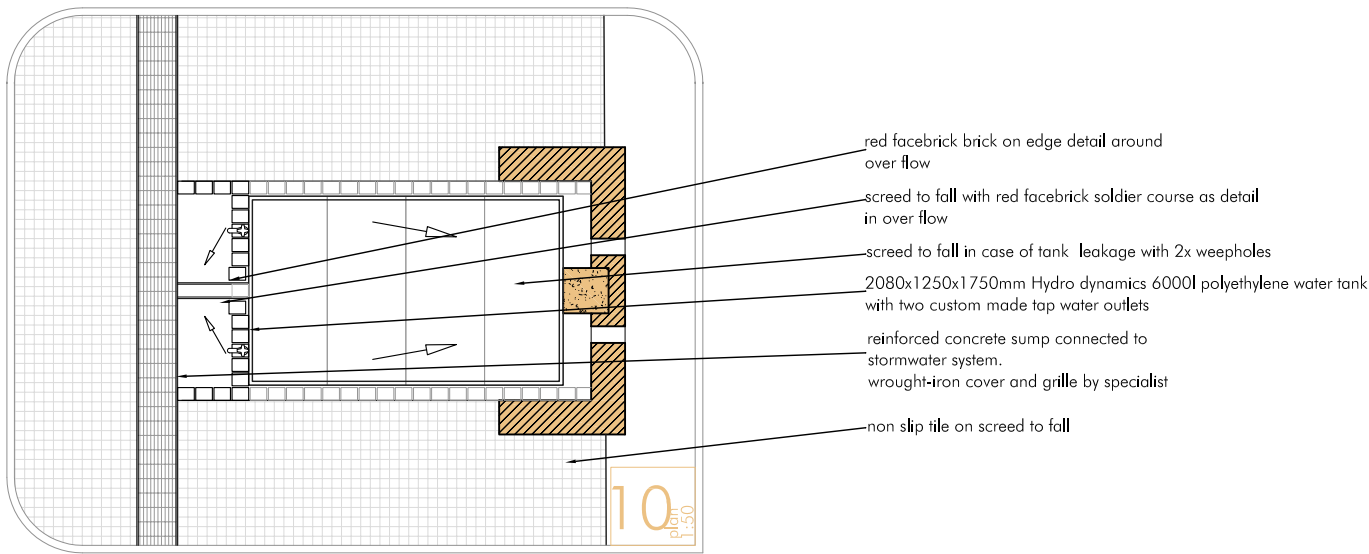

WATER POINT DETAIL
 1:50