

Fig.82

Restaurant

The restaurant “box” floats in the open, jagged edge of the building. The floor is suspended and part glass, and the glass ceiling does not touch the structure above. Visitors will get the feeling of floating in the space above the busy highway below. The box is almost disconnected from the rest of the building and this disconnectedness points at the future expansion of the building: The glass box can slide out of it’s slot and the building can keep on evolving.

Fig 81: Detail section of the restaurant ‘box’.

Although the glass walls are orthogonal, the frames holding the glass is not. The frames cut and intersect each other at odd angles, binding the restaurant with the rest of the building’s architecture.

Fig 82: Perspective of the restaurant box

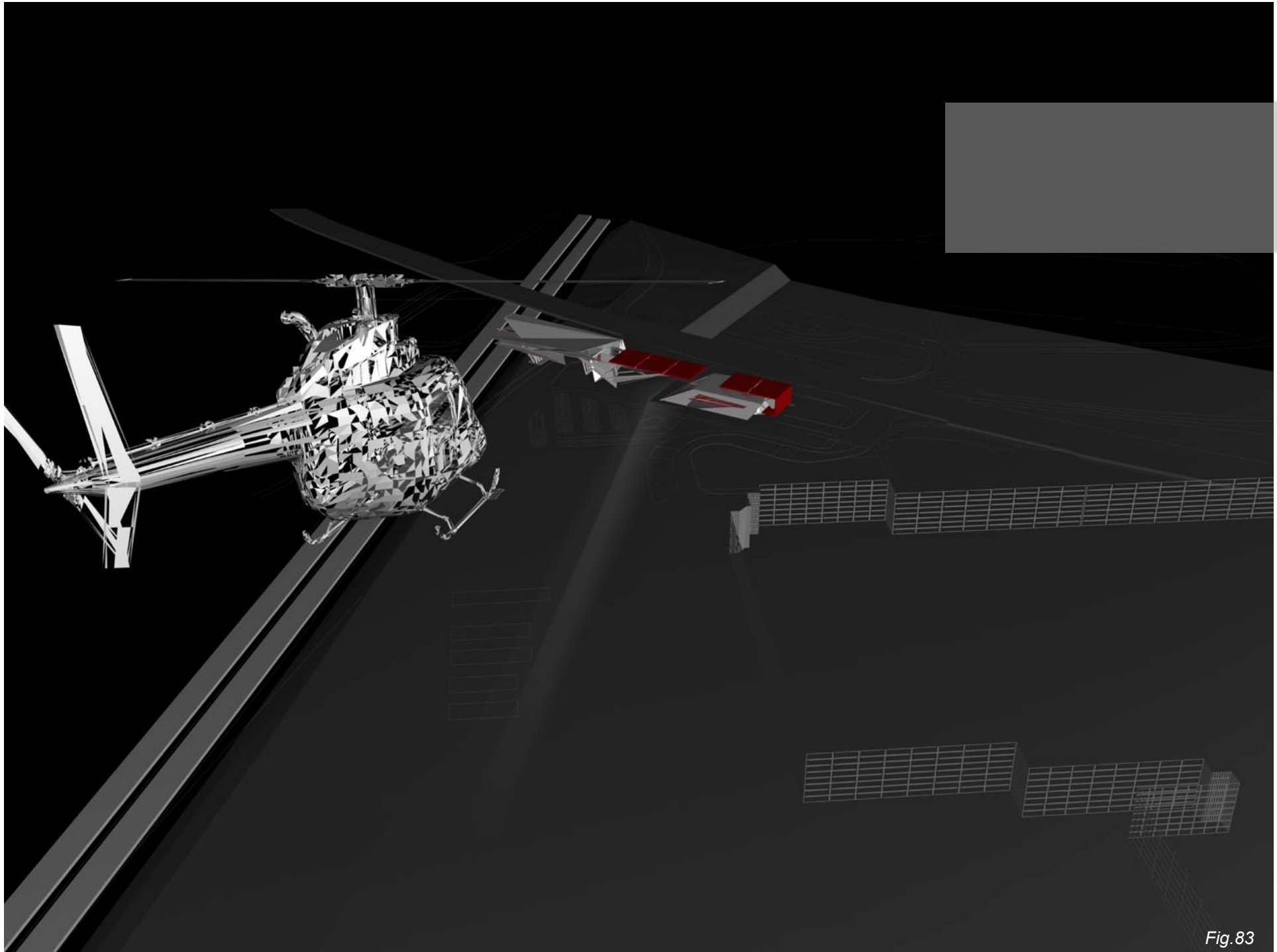

Fig.83

Red

An exclamation mark is placed over the helipads by painting them bright red. The function of the building is implied, and celebrated through obvious difference. (The rest of the building is grey) The five red squares improve the buildings visibility from the air, making it easier for pilots to orientate themselves.

Fig 83: H² as seen from the air, approaching from the south east (birds eye view)

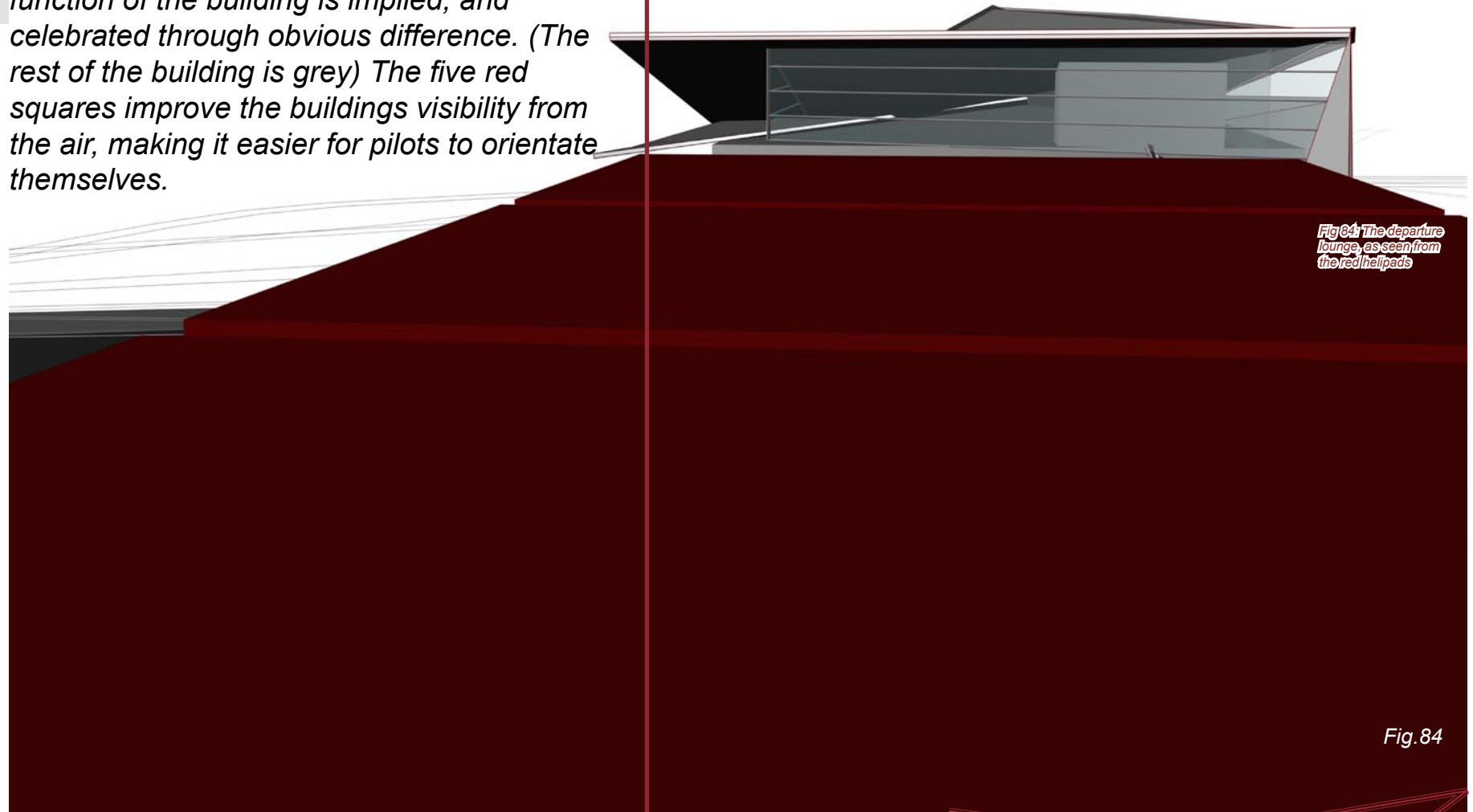

Fig 84: The departure lounge, as seen from the red helipads

Fig. 84



Fig.85

Billboard

Similar to billboard construction, the building's structure is made up of a space frame "floating" on thick columns. From far the silhouette of the building will be similar to that of a billboard, reinforcing the image of advertising and the consumer society. This does not mean that the building aim to communicate the meaning of "billboard", the comparison is purely on form.

Fig 86: H² as seen by motorists approaching from the south (south perspective)



DESIGN DEVELOPMENT

Temporary visual experiences

Motorists driving at high speed, view thousands of peripheral images that seldom enter their conscious minds. Seen in sequence these images might have a story to tell, we'll never know. The visual experience of H^2 for motorists on the N1 will be temporary, and fleeting. The building's fragments will become an indistinct blur, albeit an beautiful blur.

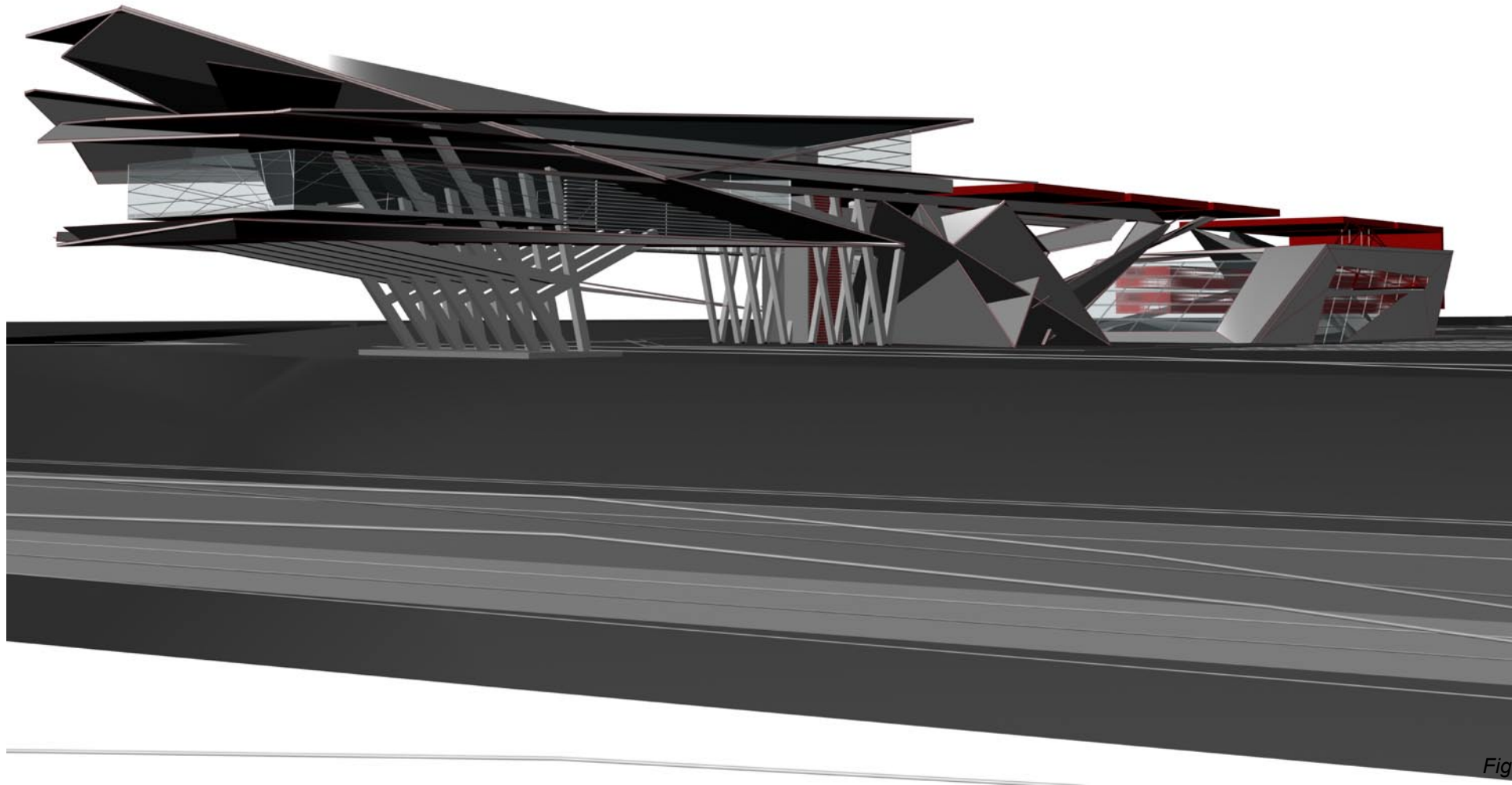

Context

The building's unusual form is comparable with placing a sign in quotation marks: Doing this changes the meaning of a given context completely; creating an infinity of new contexts in an unlimited manner. The elements and fragments of the building can be combined and recombined by the consumer to create a new subjective context.

Fig 87: H² (south west perspective)

Fig 88: H² (south perspective)

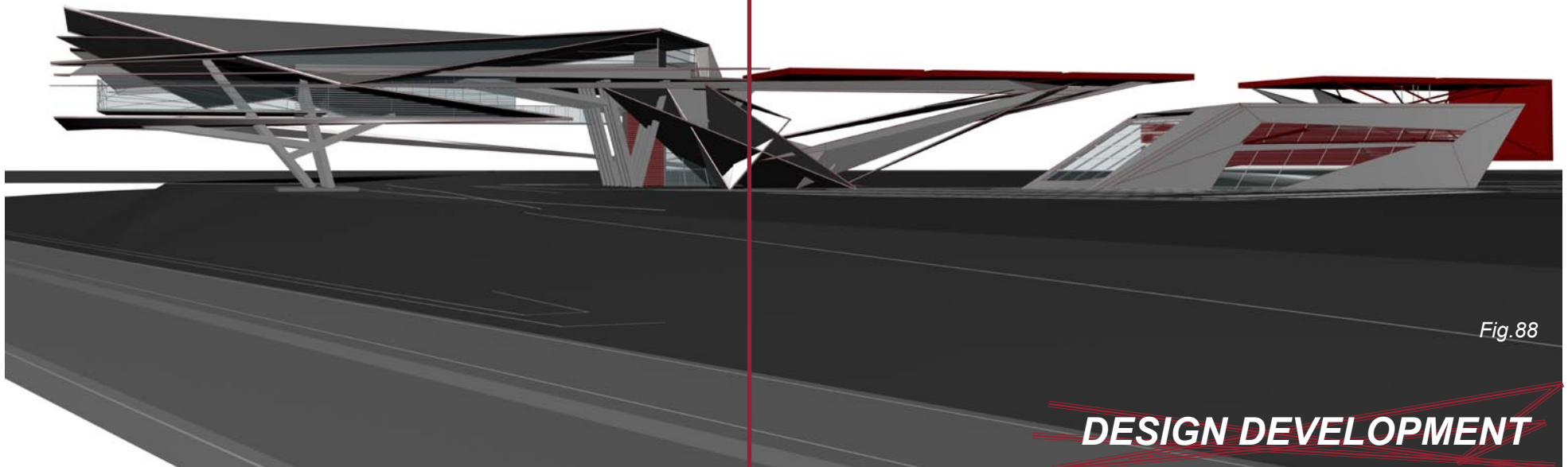

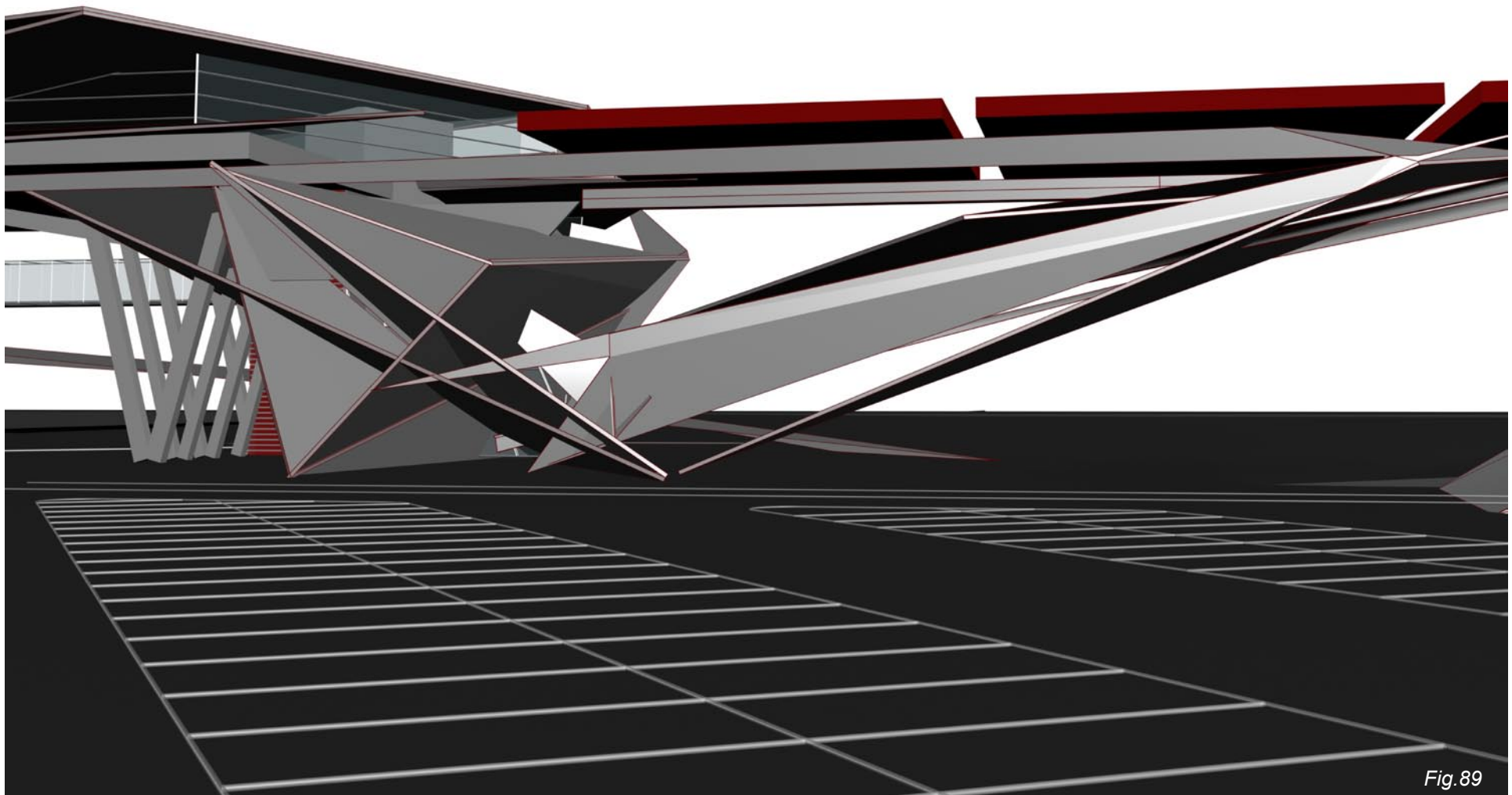

Fig. 89

Form

The building is a hybrid of form, function, and unconscious information, where neither the one or the other takes precedence. The program informs the design, but it does not dictate it. The form is open-ended and temporary (in seconds and years), eventually the building will morph into the landscape west of the N1 Highway and beyond.

Fig 89: Close up of the coffee shop and the 'space of differences' as seen from Menlyn Park (south perspective)

Fig 90: H² (west perspective)

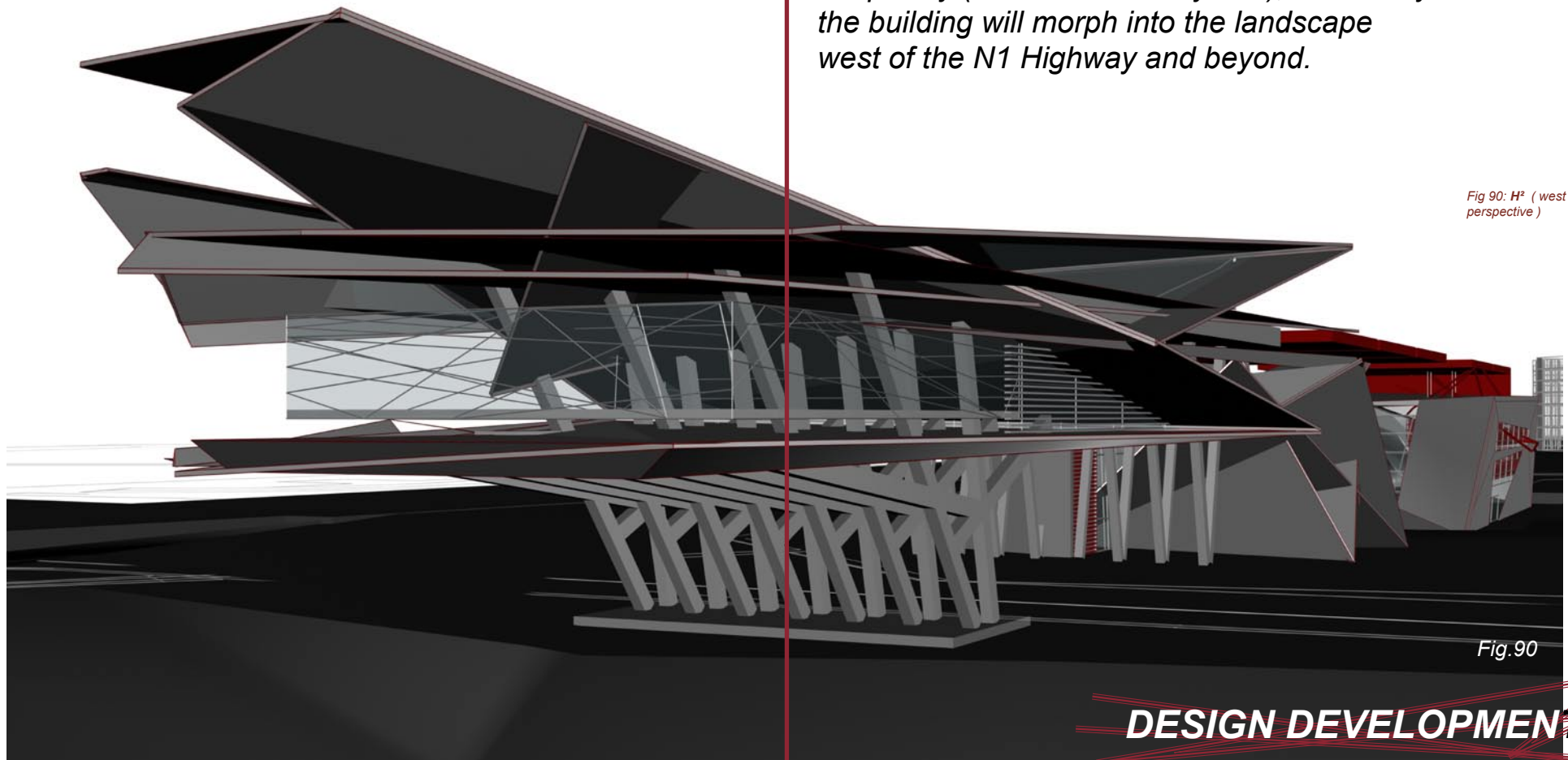
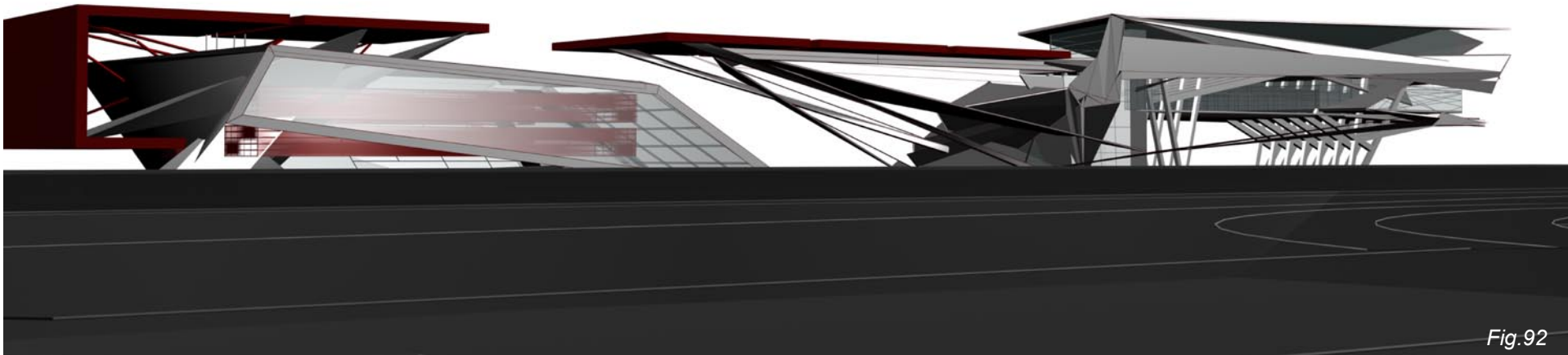
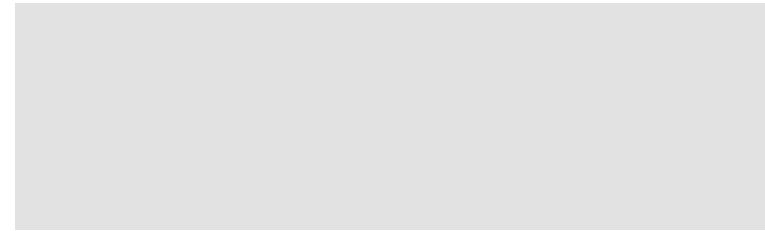
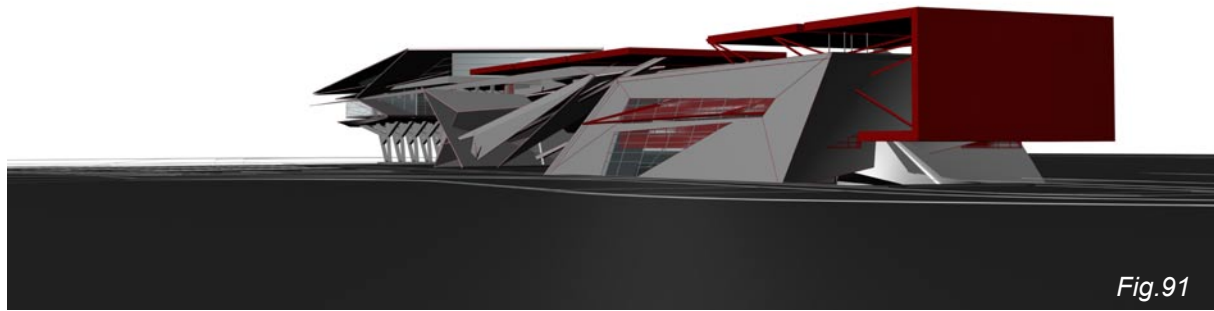

Fig.90

DESIGN DEVELOPMENT



Roof space

If the void underneath the building is understood as an element crucial to the total understanding of the building, the space above the void becomes roof or attic space. People will then only be in the building (in the traditional sense) for a very short time. Motorists will “visit” the building every time they pass underneath it, and take the same enjoyment out of it, as those in the “roof”.

Fig 91: H² as seen from Menlyn Park (east perspective)

Fig 92: H² from Atterbury road (North east perspective)

Fig 93: H² (North perspective)

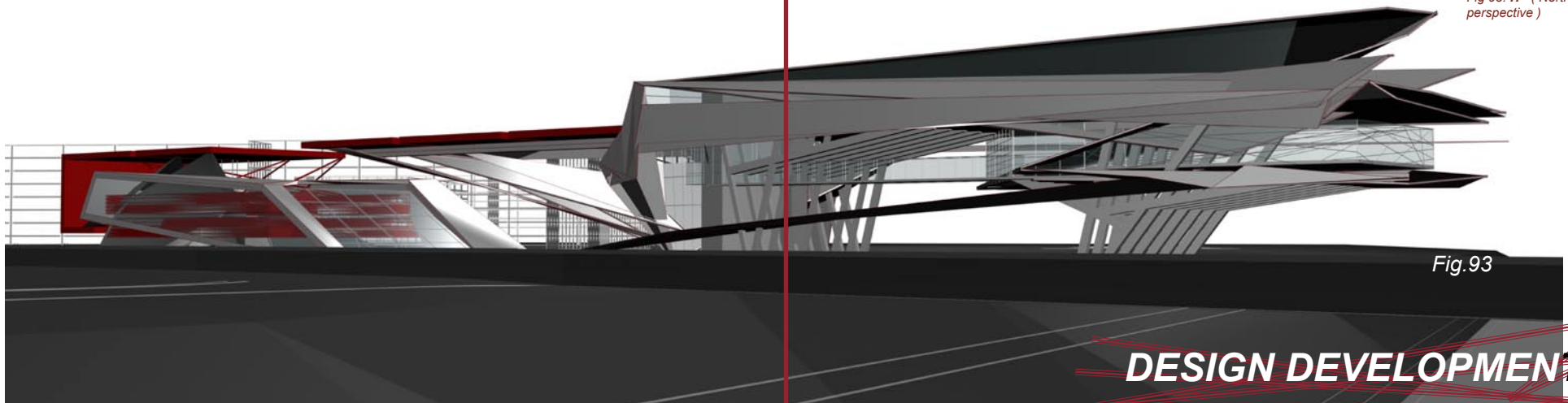

Fig.93

DESIGN DEVELOPMENT

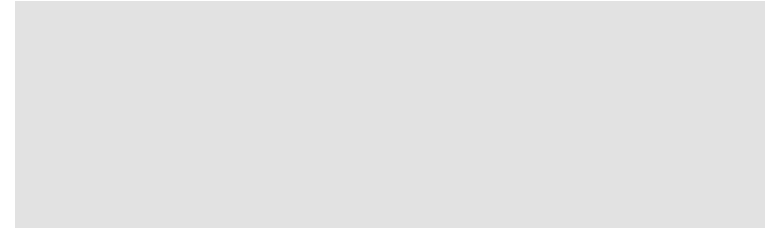

Fig.94

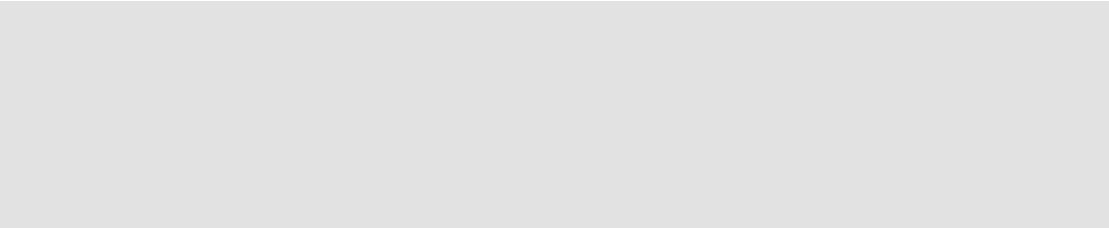

Fig 94: North elevation.

Fig 95: South elevation.

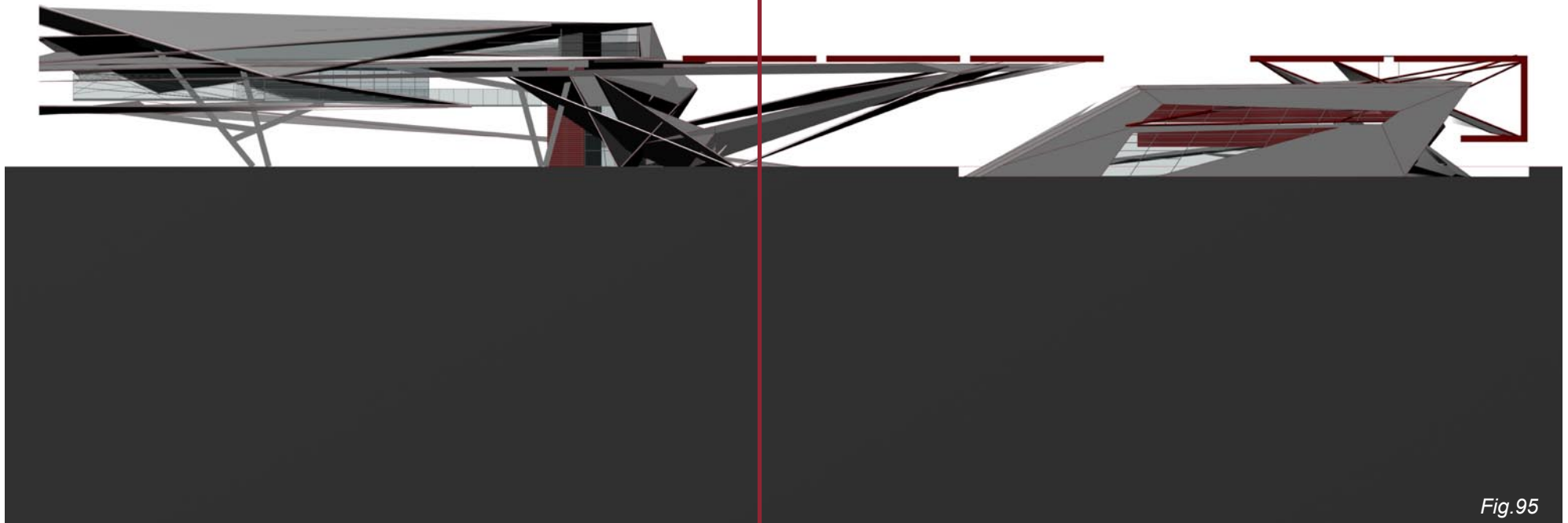

Fig.95

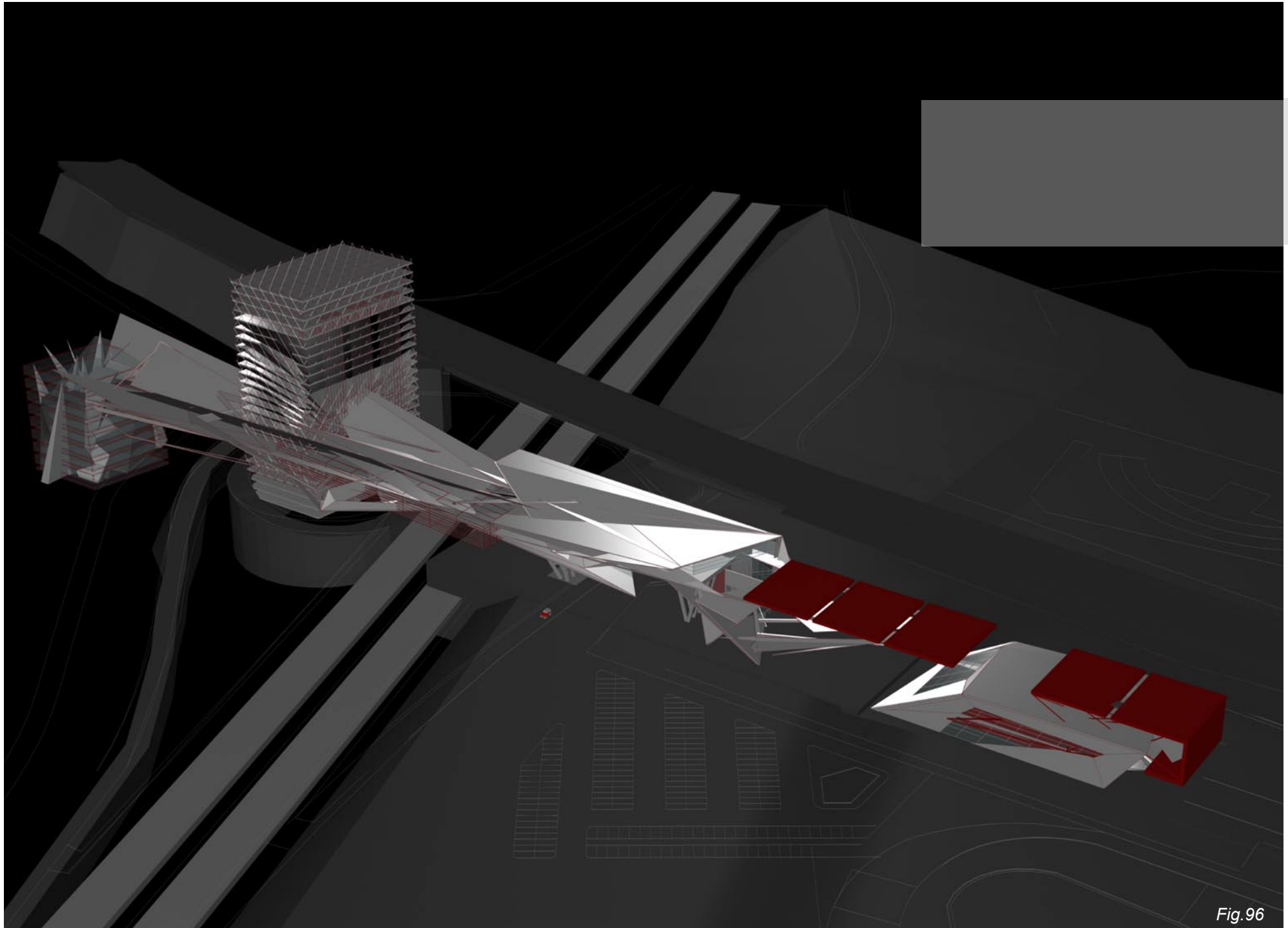

Fig.96

THE FUTURE

Ultimately the building will expand west over the highway and morph into the future Gautrain station. This envisioned mega-structure will have retail, commercial and residential components. The existing pedestrian route will be discarded for a new route through the building.

Fig 96: What the building could look like sometime in the future.

Fig 97: The mega structure as it might look in the future, as seen from the highway travelling north.

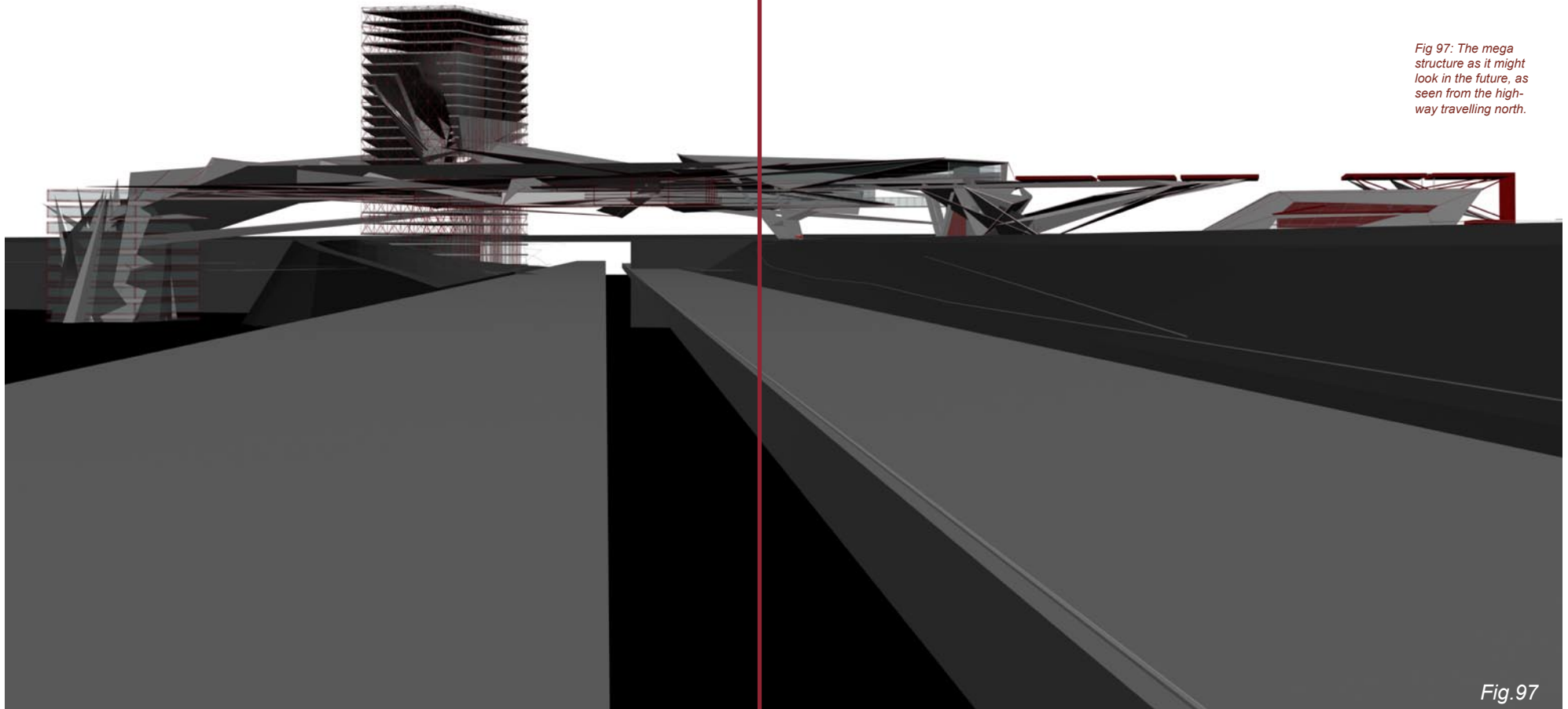

Fig.97