

001

building conception

Client:

The client is the South African government in collaboration with the Council for Scientific and Industrial Research (CSIR).

Building:

The building under investigation is a proposed design for a **centre for industrial design** for Pretoria.

Intentions for the building is to create a school of design that becomes a centre where professionals and the public can be invited to actively participate in a designer environment that benefits the quality of local product and industrial design.

Spaces are intended to be used for the design school primarily, but certain spaces are designated for training workshops for non-permanent learners that attend short design courses. Other spaces can be rented by design professionals or firms for their own private business requirements. There is a commercial component and a restaurant space required by the client.

In addition, open green spaces are required for relaxation purposes.

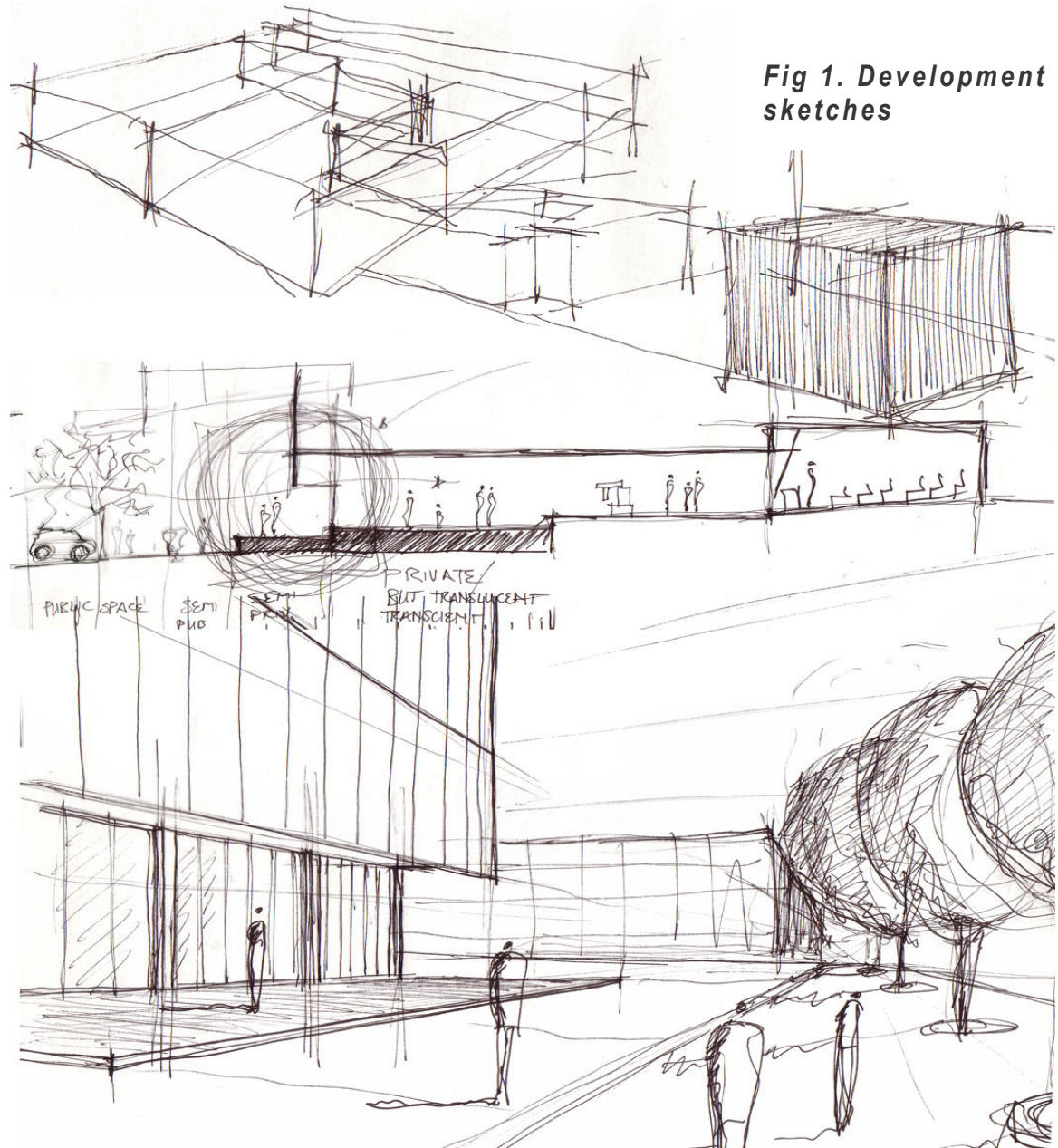
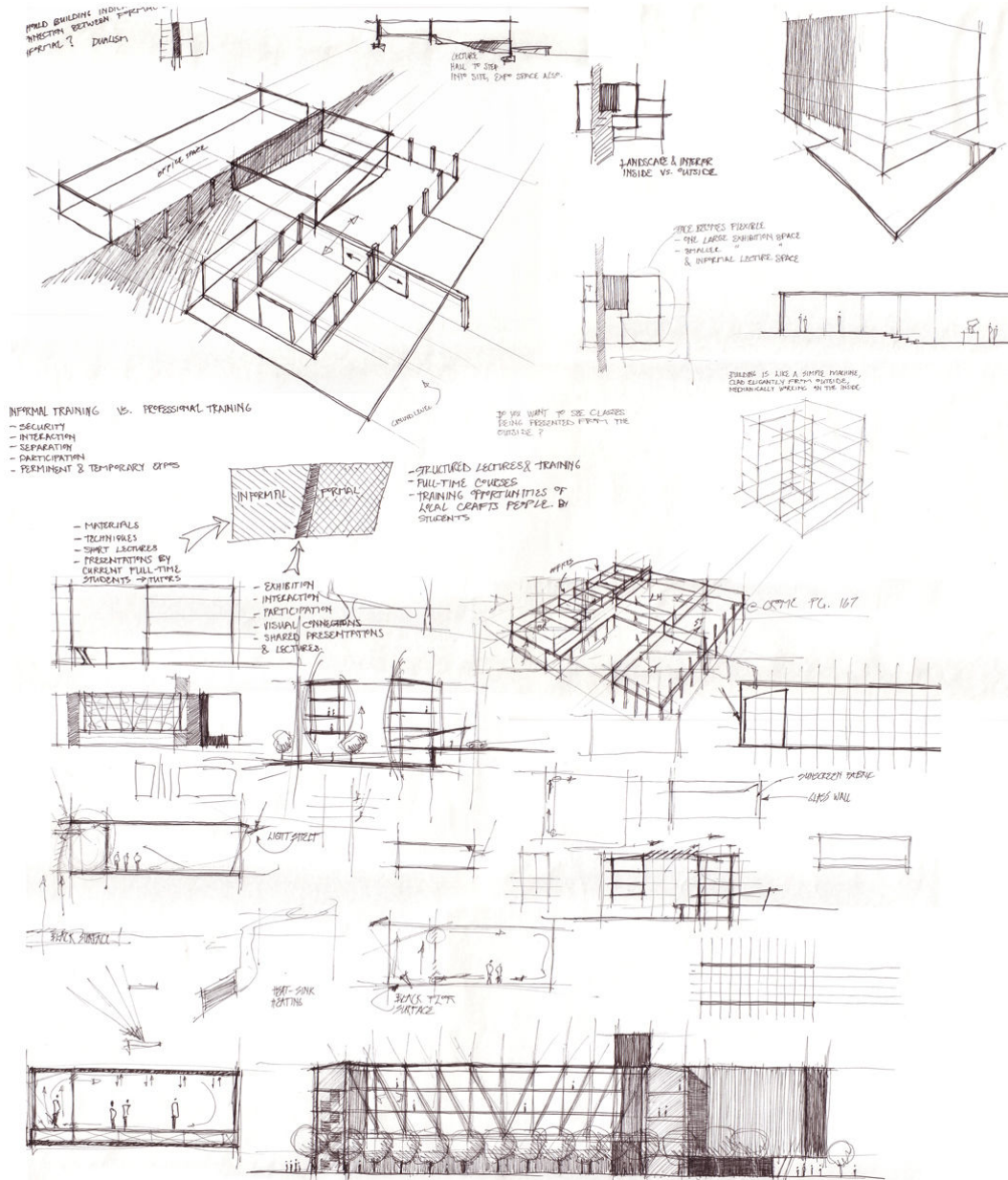

Fig 1. Development sketches

001



Design school for permanent undergraduate students:

Design studio for 300 permanent students:

- 5m² per student = 1500m²
- Space for 1 A1 drawing board and one lockable cupboard and desk

Workshop and machine shop
750m²

Library space
1.15m² per student = 345m²

Lecture spaces = 450m²

Staff office space = 800m²

Design centre spaces for training workshops:

Training workshop space / seminar spaces
1000m²

Entrance foyer and reception
200m²

Administrative office space
300m²

Lecture spaces
1000m²

Auditoriums
750m²

Canteen area and restaurant space
300m²

Service spaces:
Toilets and showers
Kitchens
500m²

Rentable offices for professional designers
1000m²

Rentable commercial space
700m²

001

Parking bays (150)

Residential units

500m²

The building is to be no larger than 10,500m² and is to portray an industrial design language in its composition and aesthetics.

The centre houses 300 full-time students and must provide space for 150 part-time students per day in spaces other than the designated design studios. Thus, spaces for workshops and seminars are required.

Being in the Museum Park precinct allows the building to boast a display of product designs of the past. Contemporary exhibitions are to be housed within the building. In order to accommodate these aspects, the building needs circulation and display area, these spaces can be combined. An outdoor floor is also required for exhibitions and launches.