

Precedent Studies

RE-IMAGINING THE DENSIFICATION OF SUBURBIA

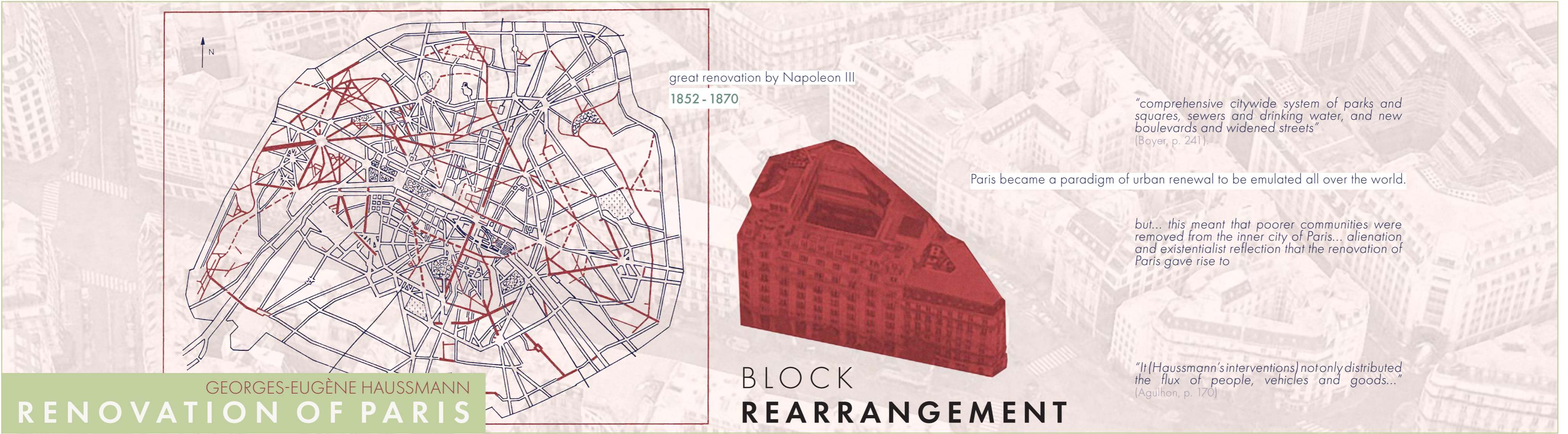
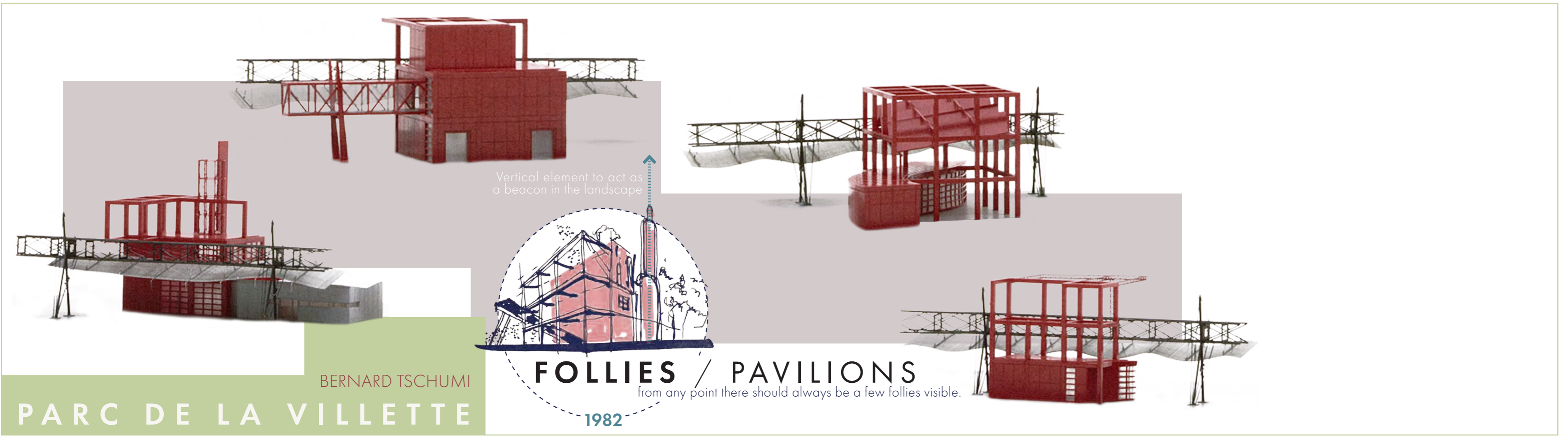

THE VILLAGE PRECINCT

coaxing suburban life into the public realm

BASE CASE + PLANNING PRECEDENT

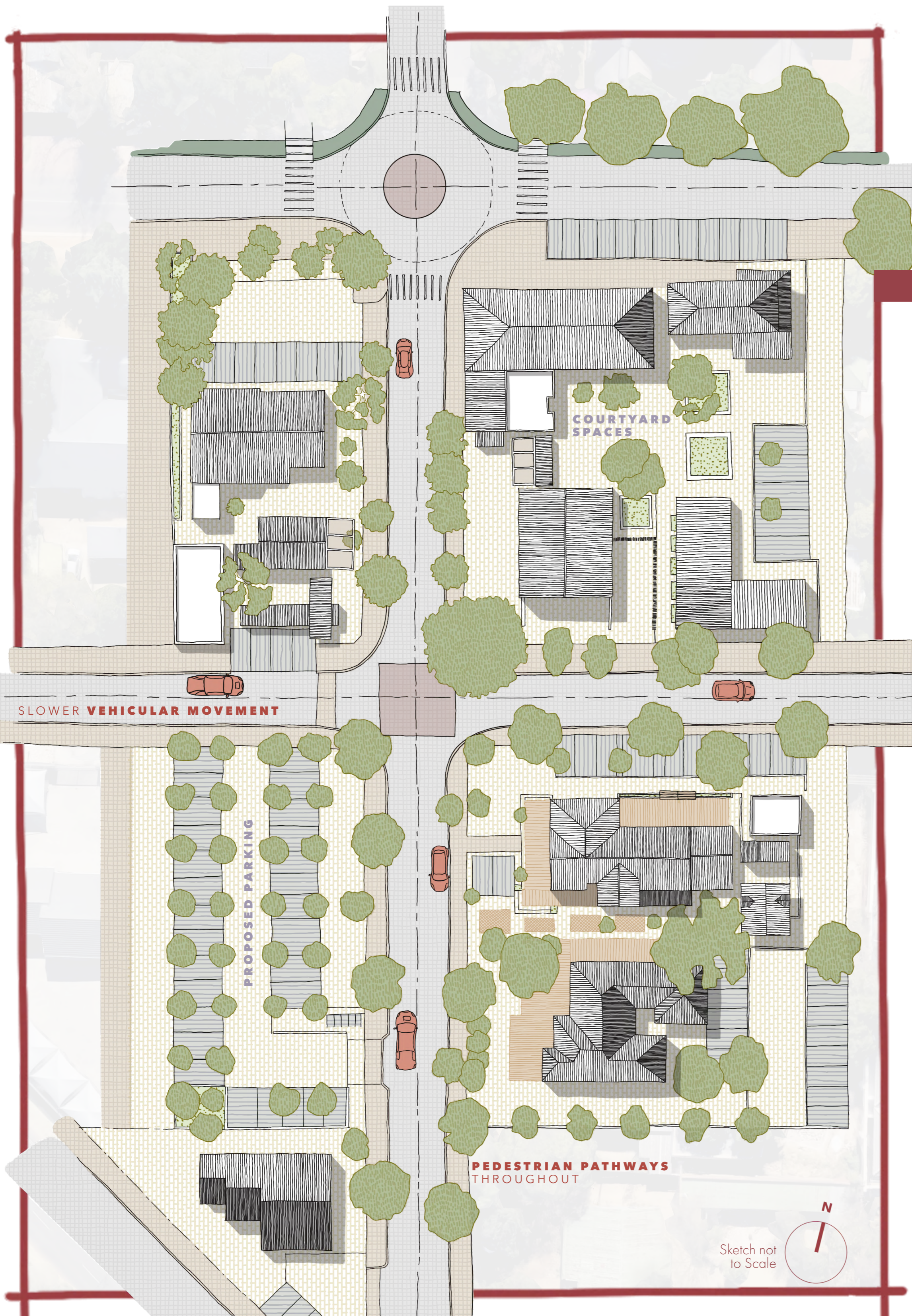
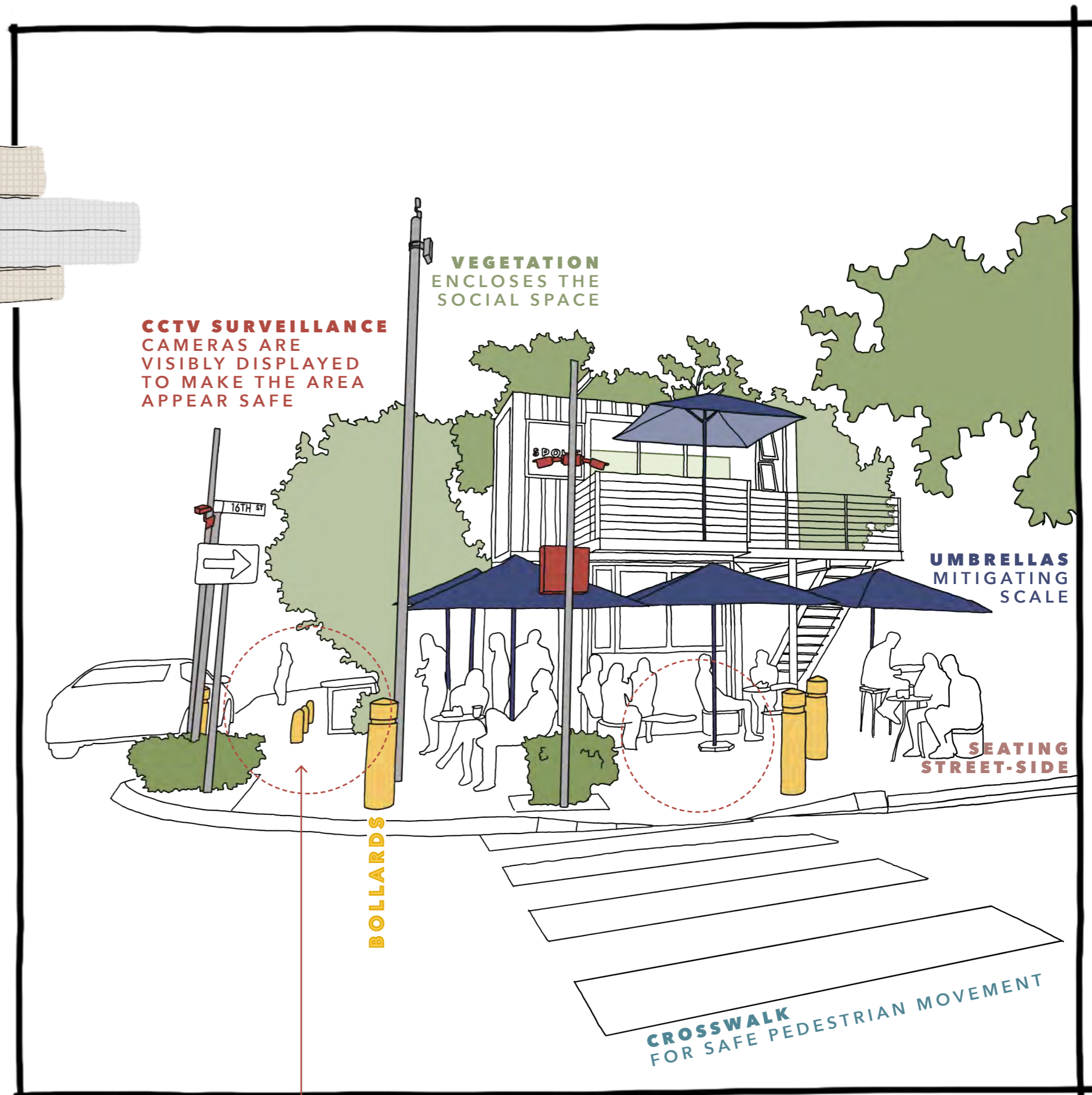

DIAGRAM 1 Bird's eye view of The Village Precinct



SOCIAL SPACE for appropriation



PUBLIC ARTWORKS creates a sense of identity within the precinct

DEVELOPMENT PLAN
the aerial view of the Village Precinct as proposed by the Atterbury Property Group

DIAGRAM 2

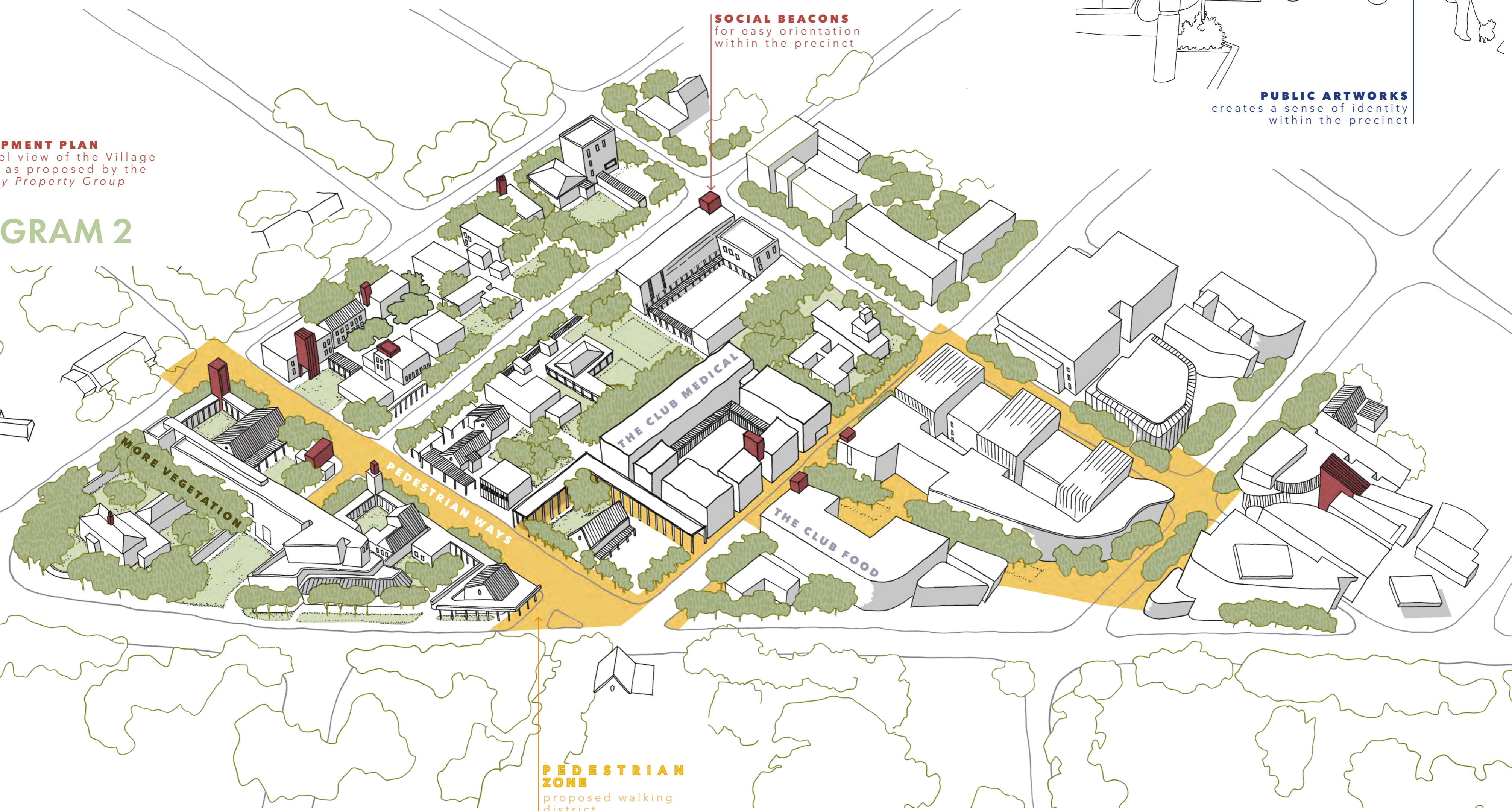

PEDESTRIAN ZONE proposed walking district

PROJECT INTENTION:

"Close to Home" is a speculative architectural and research initiative that explores the potential of architectural interventions within Beijing's city fabric to contribute significantly to the future mental well-being of urban lives. The project focuses on fortifying existing communities and neighborhood structures as a key strategy.

CLOSE TO HOME | CAMERON CLARKE

In this project, the argument posits that solutions lie within existing community and neighborhood structures. The proposal advocates for a preventive and rehabilitational psychiatric care model, centered around an urban acupuncture approach to care facilities dispersed throughout the city fabric, as opposed to the current reactive centralized institutional model. Architectural spaces and interventions form a network connected by a digital layer of communication technology, bringing mental healthcare physically and virtually closer to each city resident. This approach aims to enhance communal and neighborly interactions while reducing the stigma and fear associated with mental illness, thus contributing to better mental health outcomes.

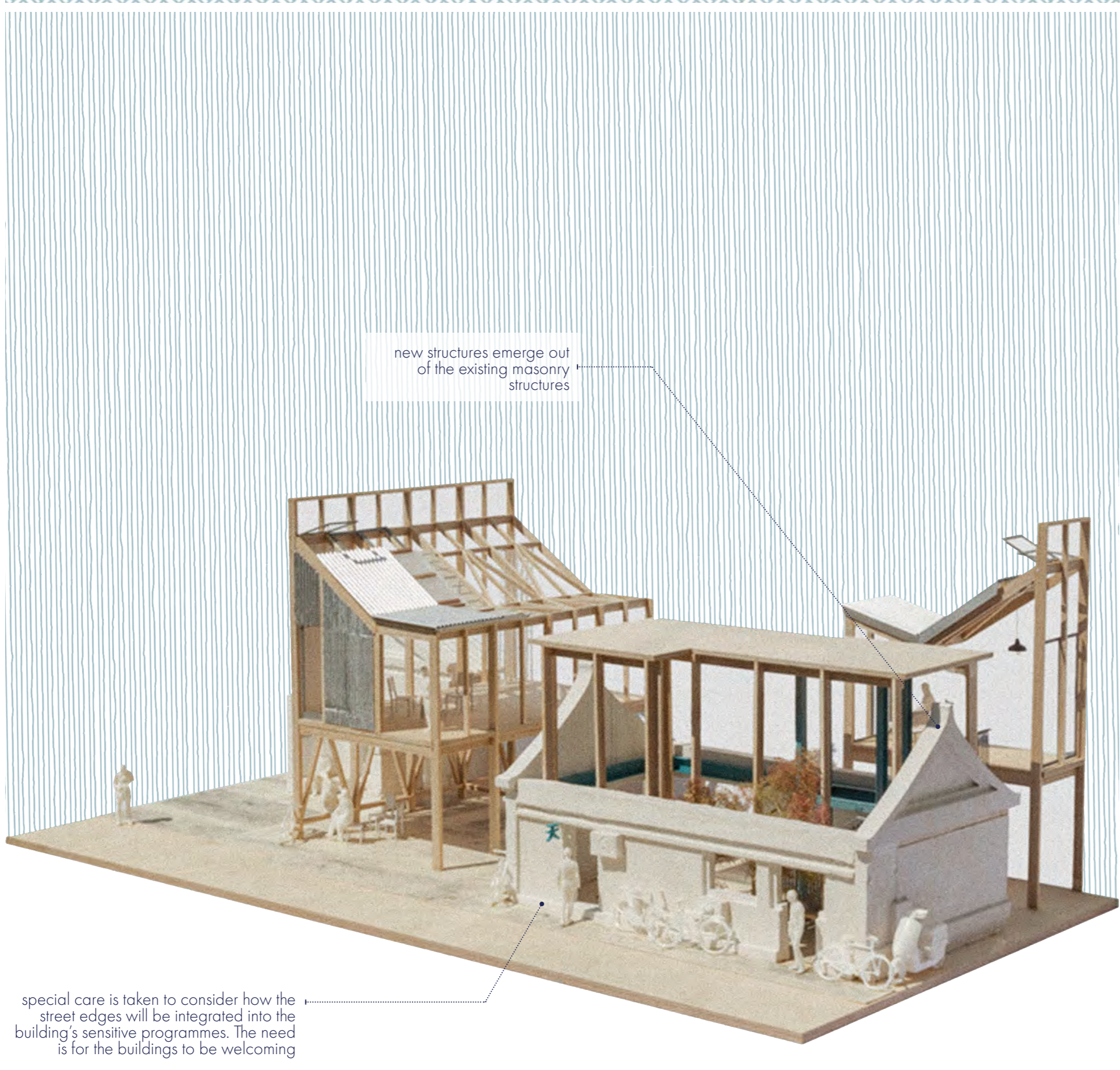
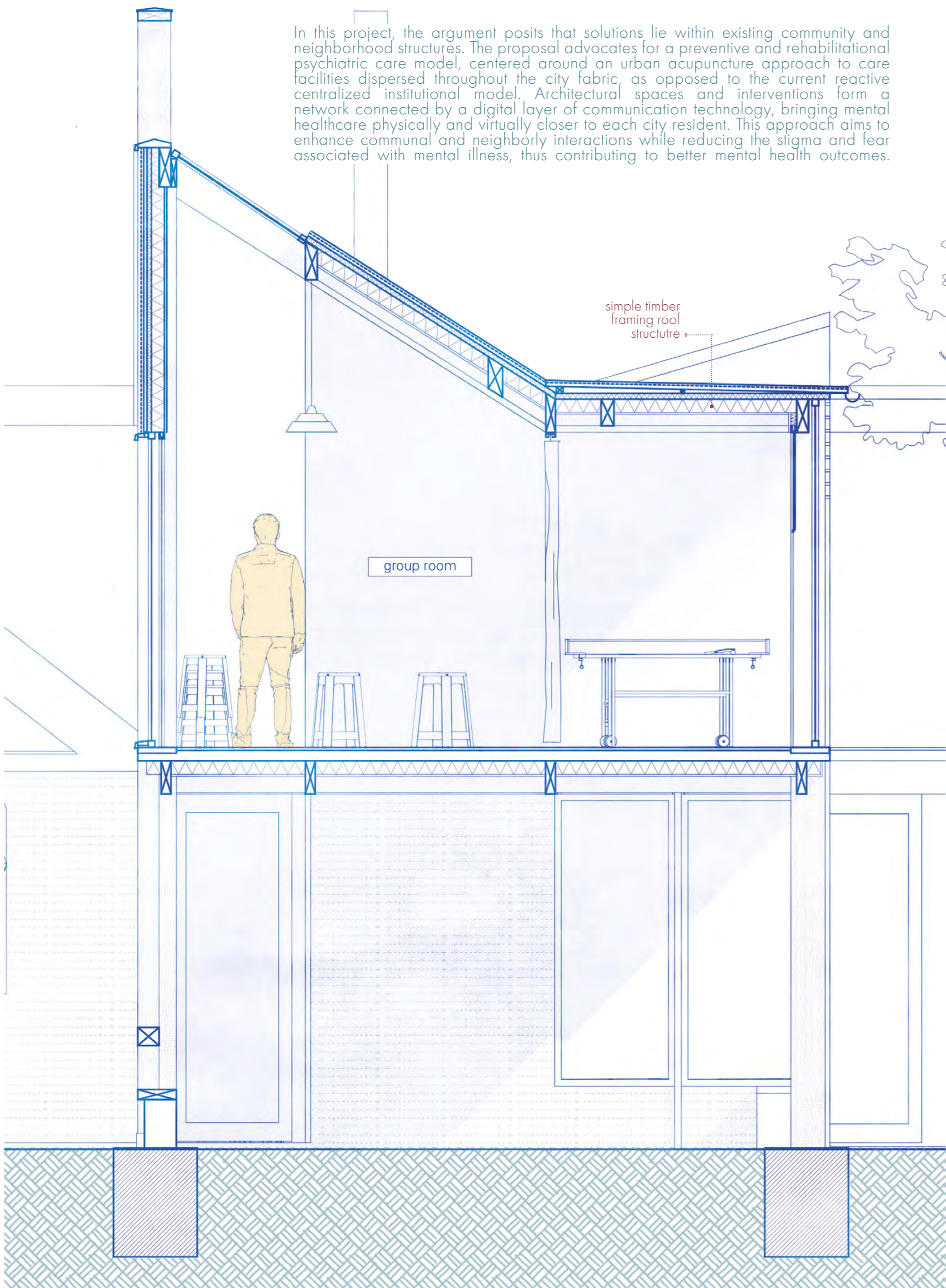

PROJECT INTENTION:

In accordance with the guidelines outlined in the design competition, Nest We Grow aims to unite individuals and food at the Lixil JS Foundation's Memu Meadows research center in Taiki-cho, Hiro-gun, Hokkaido, Japan. Smith expresses the team's aspiration for the recently inaugurated permanent structure, stating, "We want to foster a sense of community."

NEST WE GROW | KENGO KUMA

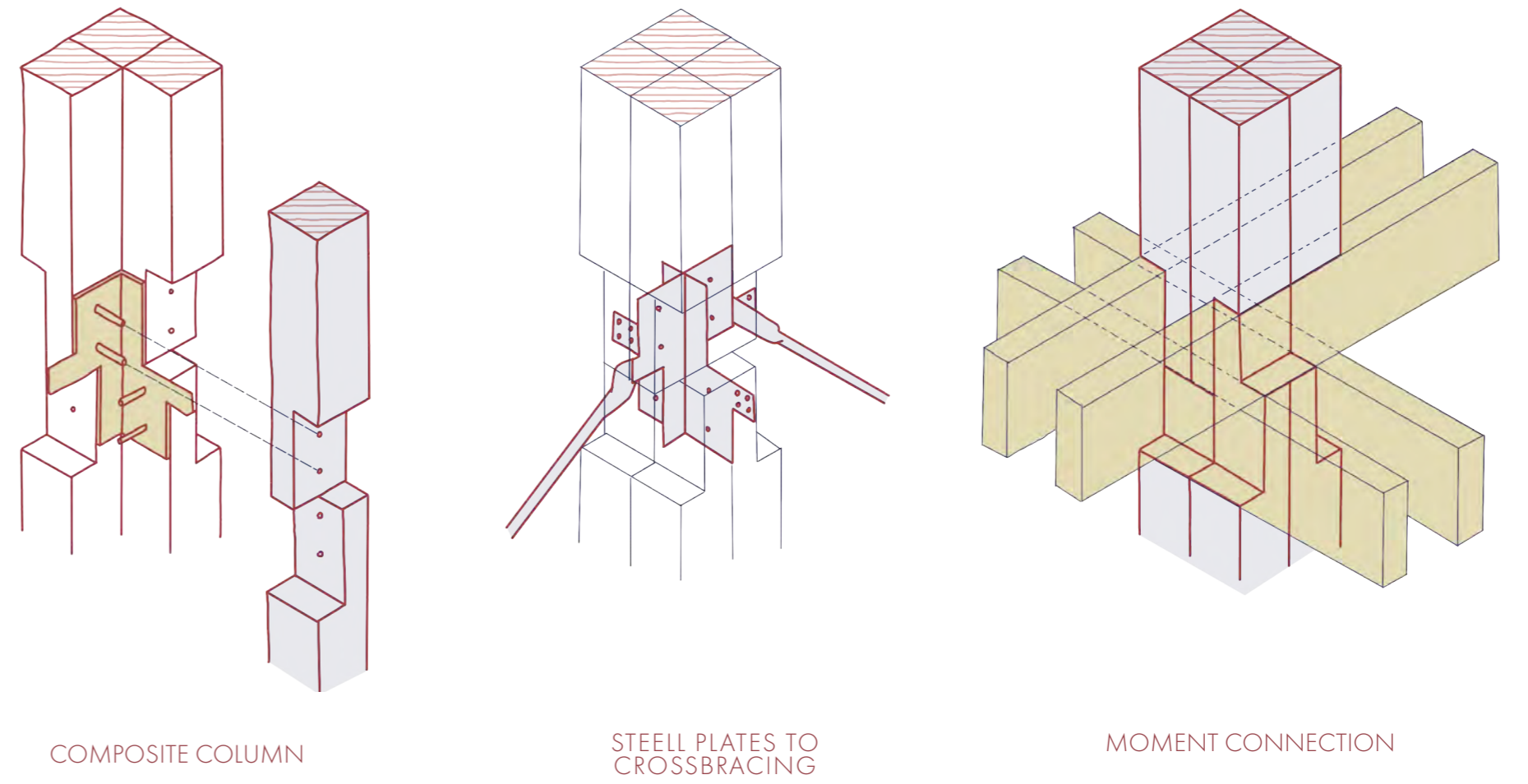

Designed as a communal space for the preparation and enjoyment of local foods, the Nest incorporates various features to ensure comfort across seasons. Utilizing translucent plastic corrugated sheets for the façade and roof helps trap heat from the tea platform fireplace during colder months. Sliding panels integrated into the façade and roof promote airflow in warmer weather. Additionally, a concrete wall at the structure's base acts as a shield against strong northwest winds.

