

NEW COUNTRY HOUSE

TO BE BUILT ON PORTION 36 OF THE FARM HARTEBESTPOORT 304 NEAR PRETORIA FOR MR NORMAN GREENWOOD

REVISIONS

ROOFPLAN

SCALE: 1/4" = 1'-0"
 DATE: 4-5-1950
 DRWG: P. 207/7

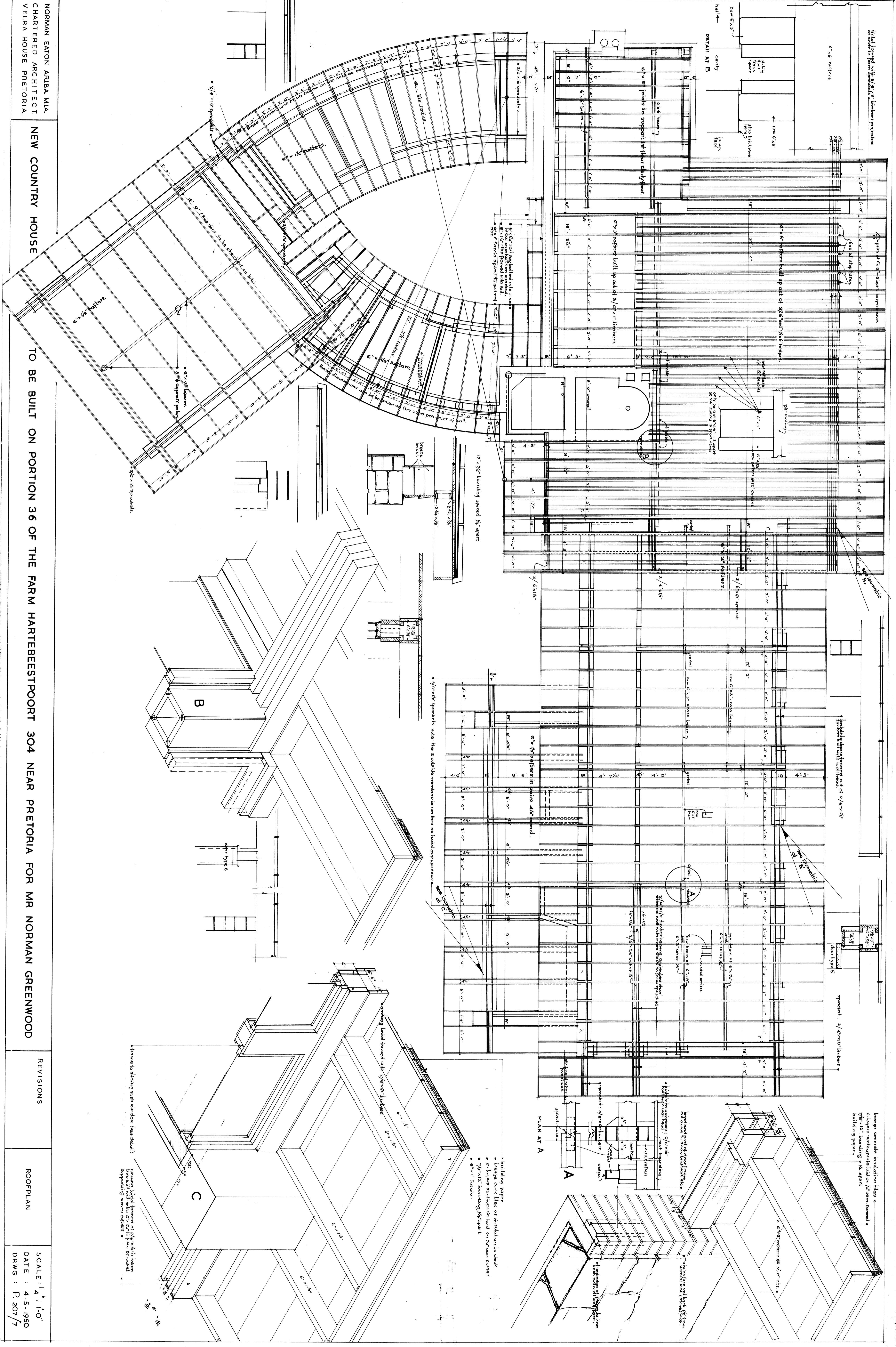

Frame to sliding sash window (see detail)

Trussing laid formed of 2 1/2" x 1 1/2" s taken from wall with extra 6" x 12" s from sprockled supporting cross rafters

building paper
 6" beams substructure laid on 1/2" oem screed
 3/8" x 12" boarding 1/4" apart
 6" x 12" boarding 1/4" apart
 6" x 12" fascia

large concrete insulation tiles
 6" beams substructure laid on 1/2" oem screed
 3/8" x 12" boarding 1/4" apart
 building paper

PLAN AT A

sprockled 3/4" x 1 1/2" timbers

laid formed of 2 1/2" x 1 1/2" s taken from wall with extra 6" x 12" s from sprockled supporting cross rafters

laid formed of 2 1/2" x 1 1/2" s taken from wall with extra 6" x 12" s from sprockled supporting cross rafters

laid formed of 2 1/2" x 1 1/2" s taken from wall with extra 6" x 12" s from sprockled supporting cross rafters

laid formed of 2 1/2" x 1 1/2" s taken from wall with extra 6" x 12" s from sprockled supporting cross rafters