

NEW HOOD, FIREBACK & BASE, ASHTRAY AND REMOVABLE GRATE for EXISTING FIREPLACE. at 356 HILL ST. ARCADIA
 for MRS ENA BENNET
 1/8 F.S. DETAILS. Norman Eaton Architect. JUNE 1957.

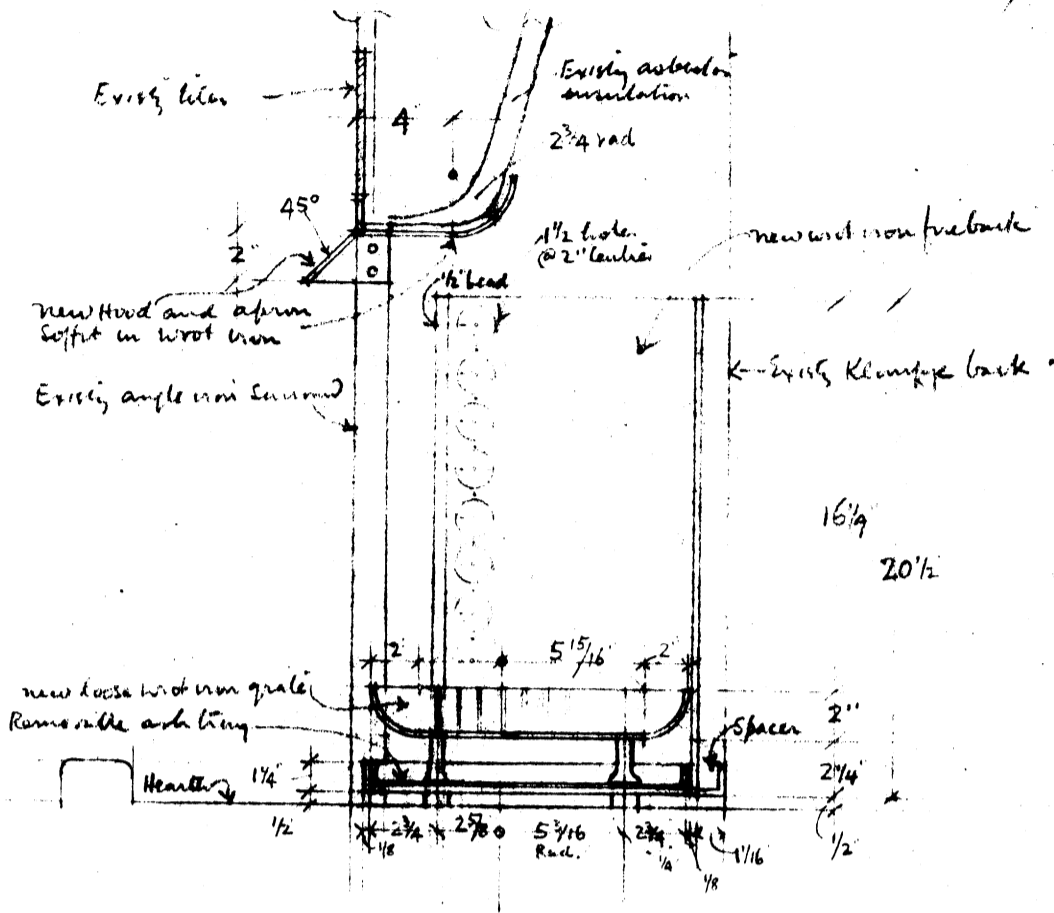

SECTION

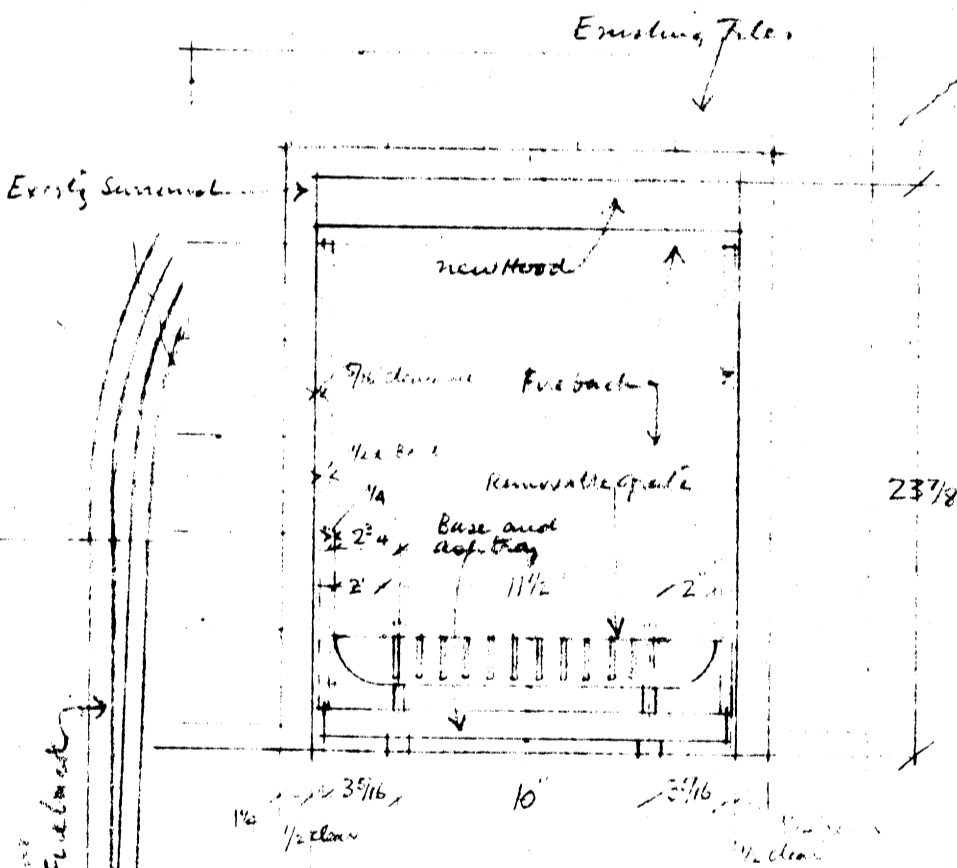

ELEVATION

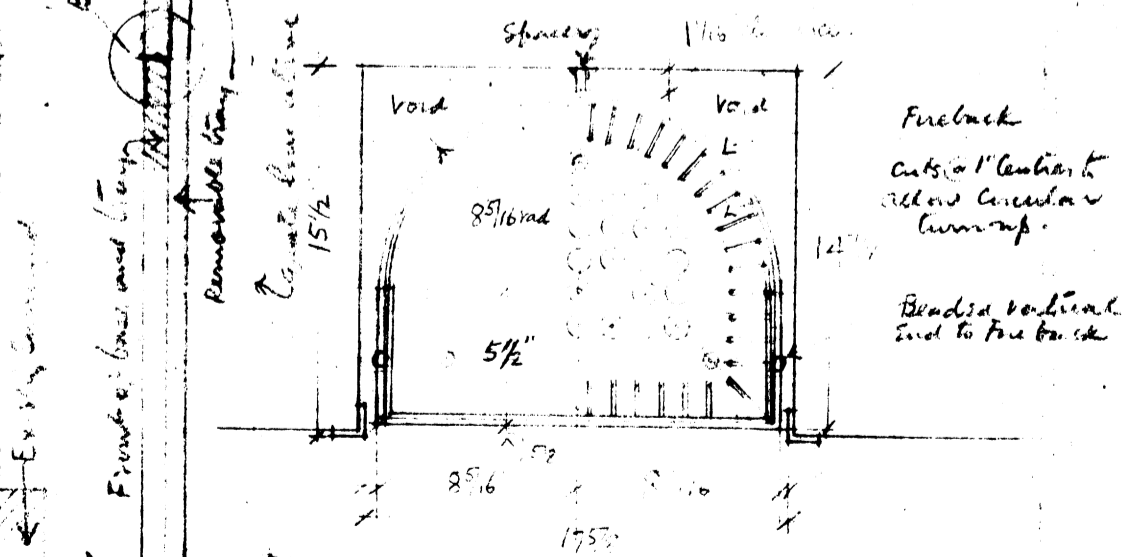

F.S. DETAIL

PLAN