

-----[VIII]-----
P R E S E N T A T I O N

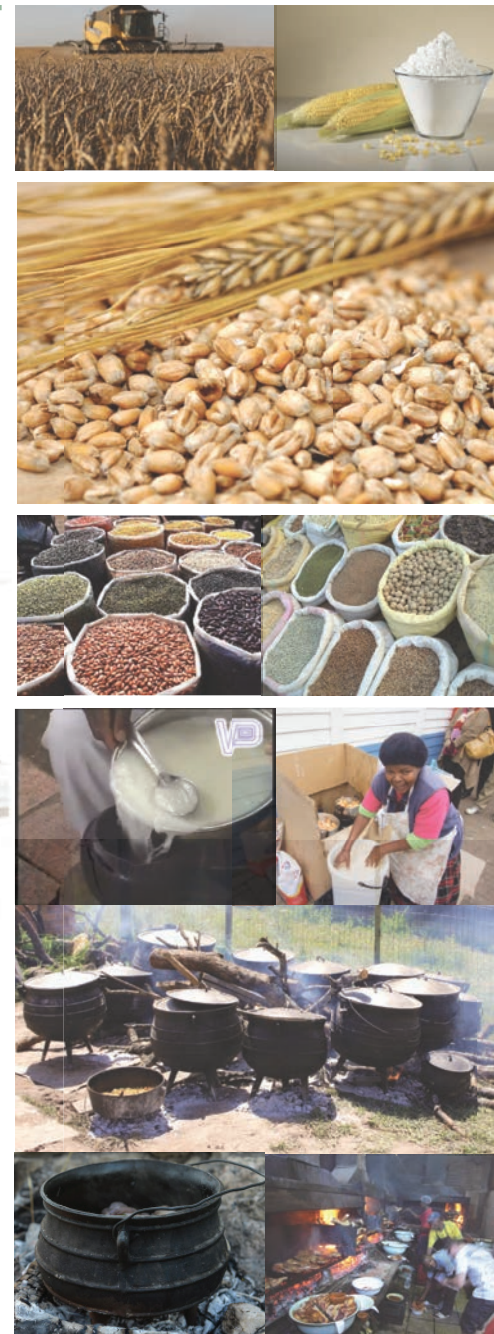

Fig. 2.21 Informal Food Collage (Collated by Author)



Fig. 2.7 Ford's moving Production line. Weber, A. (2013)



Fig.2.22 Urban infill in lower market (Snow 2012)



Fig.2.23 Road infrastructure as informal market (Battista 2017)

Fig.2.24 Urban infill in lower market (Battista 2017)

TECHNOLOGICAL ADVANCEMENT

PRE-INDUSTRIAL COMMUNITIES

Fig. 2.4 Ancient African Community (DEXTER COLOR INC.1946-1960)



FIRST INDUSTRIAL REVOLUTION

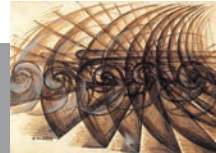

Fig. 2.5 Speed of a motorcycle (Giacomo Balla, 1913)

SECOND INDUSTRIAL REVOLUTION



Fig. 2.6 Ford motor company factory. Weber, A. (2013)

THIRD INDUSTRIAL REVOLUTION

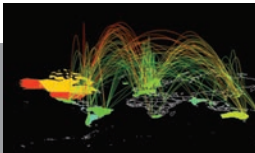

Fig 2.10 Global Internet traffic (Arabiya, 2016)



Fig. 2.2 Patterns on Mapungubwe Artefacts (Tiley-Nel, 2014)

PRECEDENT STUDIES

TSUKIJI MARKET-JAPAN



Fig. 2.15 Tsukiji Fish Market (Chris, 2017)



Fig. 2.16 Tsukiji Redevelopment Plan (Johnny, 2015)

MAPPING

PRETORIA FIGURE GROUND



PUBLIC TRANSPORT



INCOME %



URBAN USE



URBAN SHADING

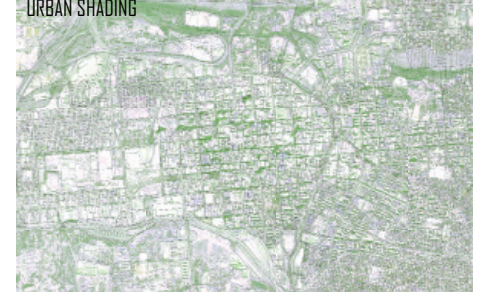

URBAN CORRIDORS



WEST CAPITAL DEVELOPMENT



PUBLIC SPACE



STREET ELEVATIONS AND URBAN ANALYSIS

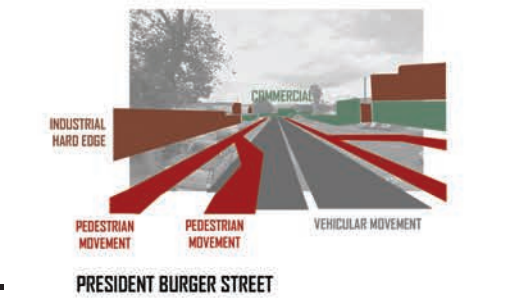
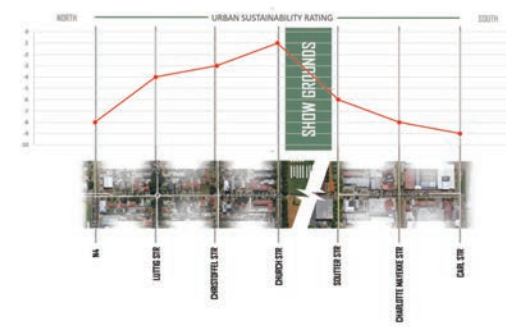
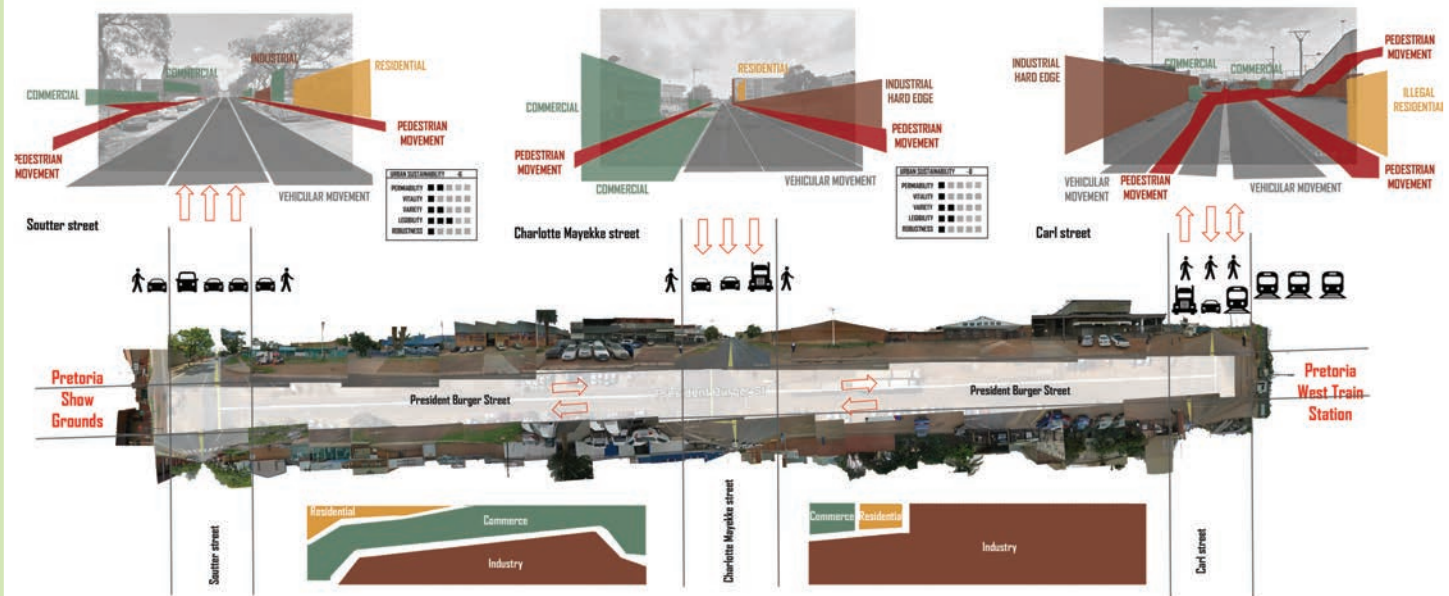
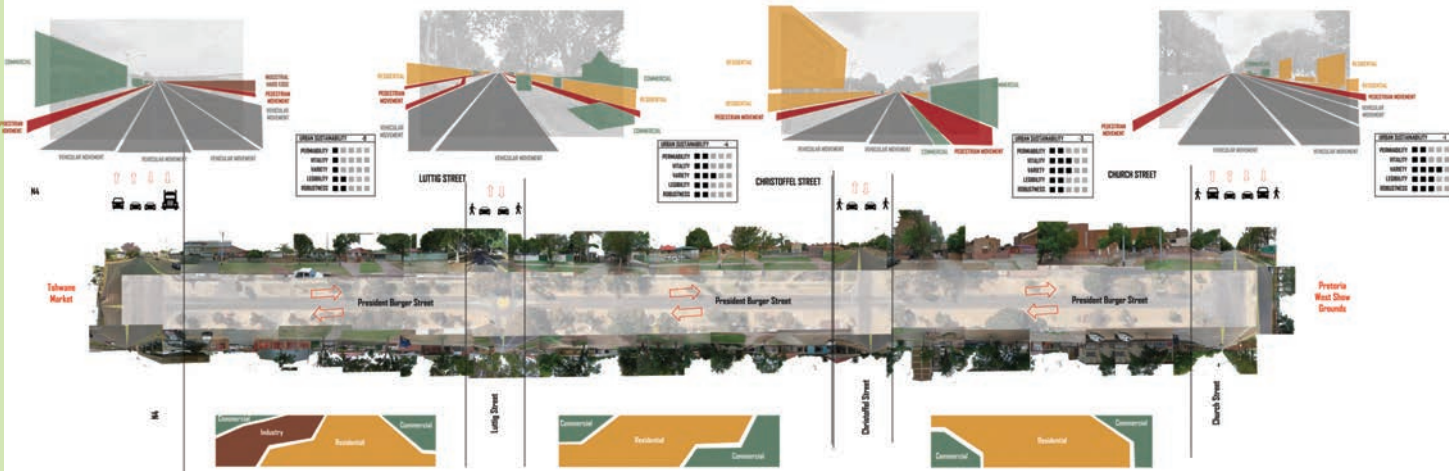

URBAN VISION



DESIGN MORPHOLOGY
FORMAL DEVELOPMENT

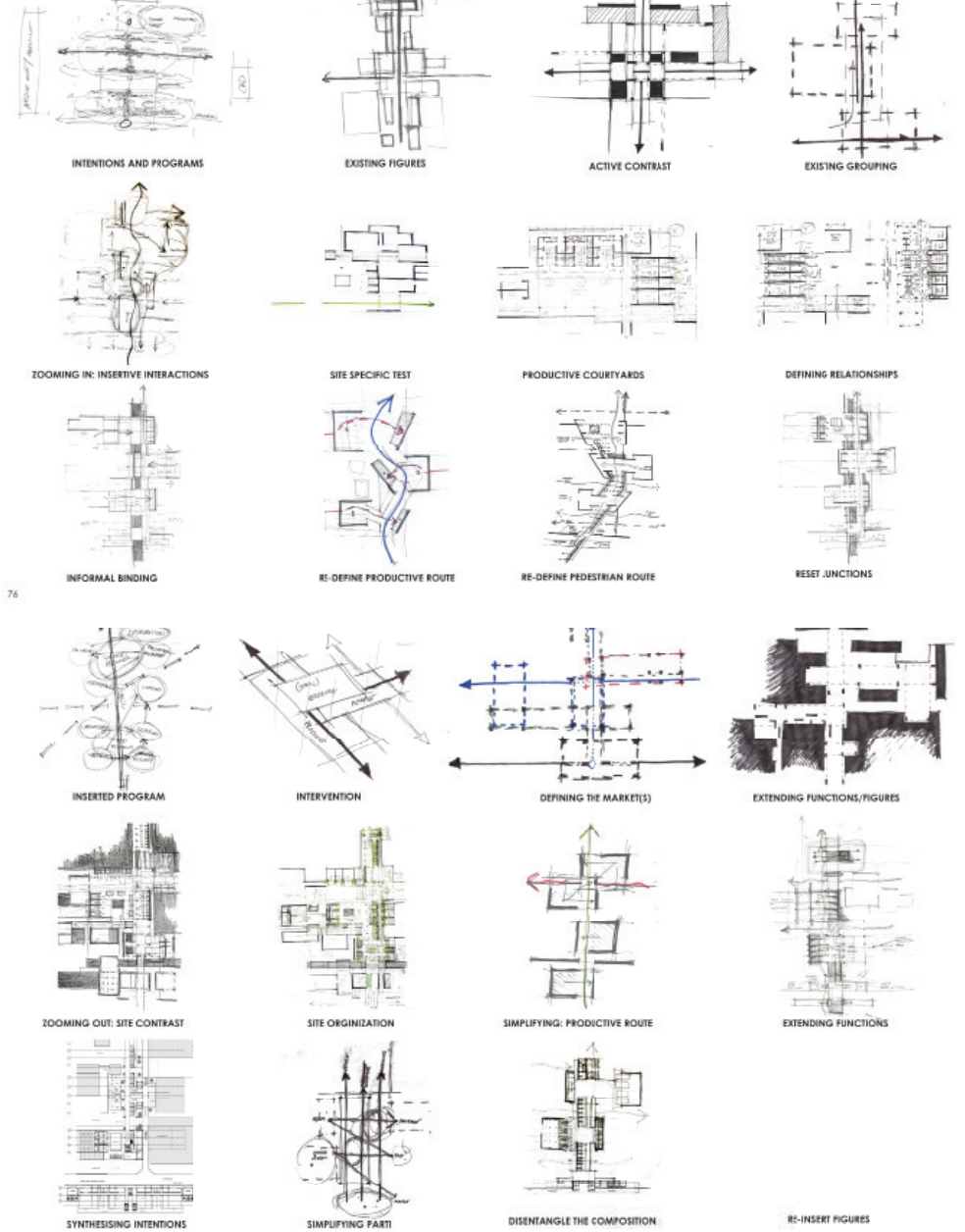

76

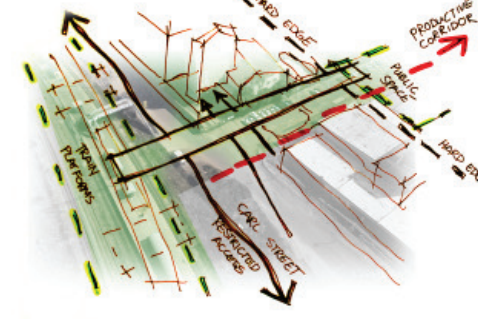
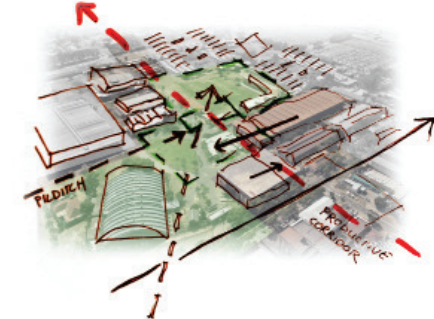
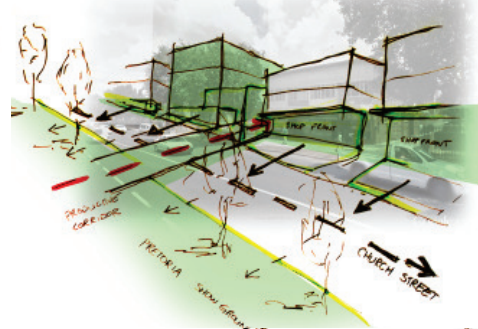
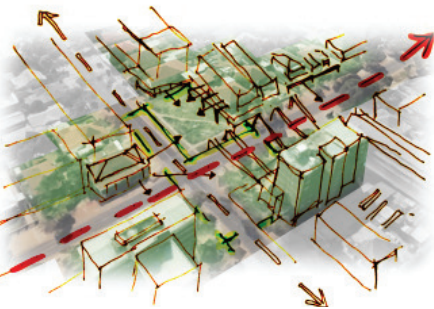

77

URBAN VISION DESIGN

DESIGN MORPHOLOGY
FORMAL DEVELOPMENT

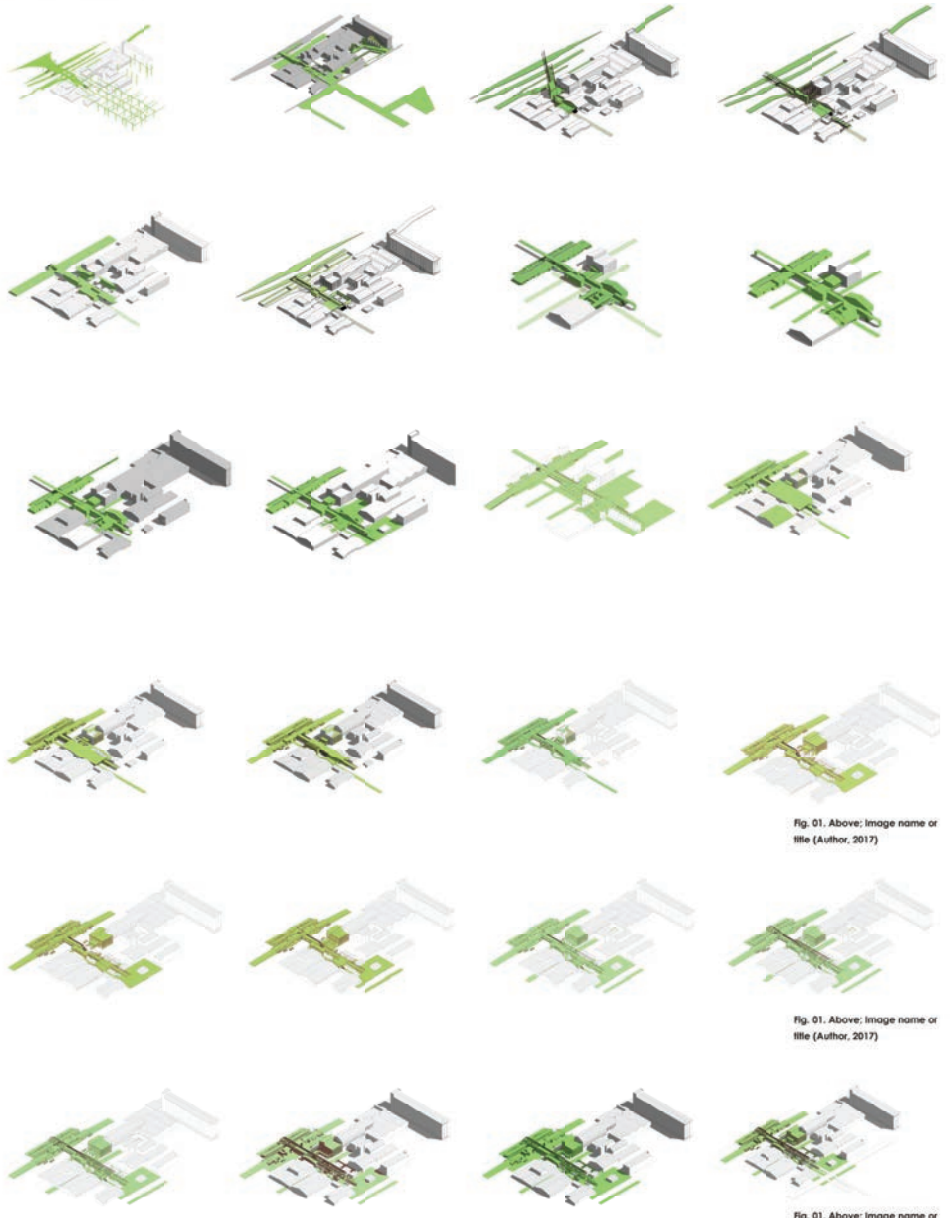
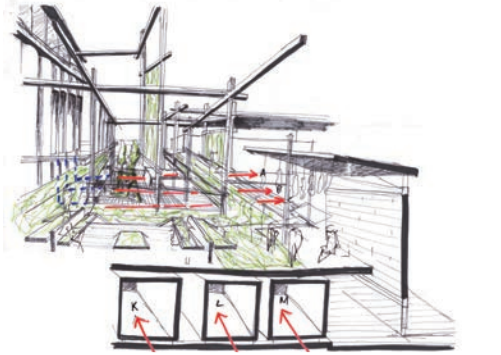
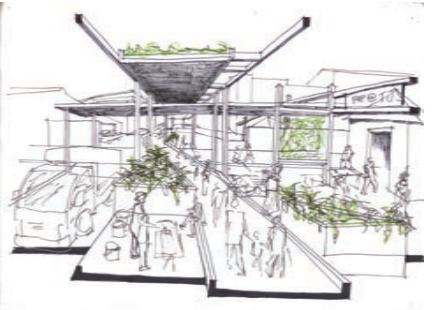
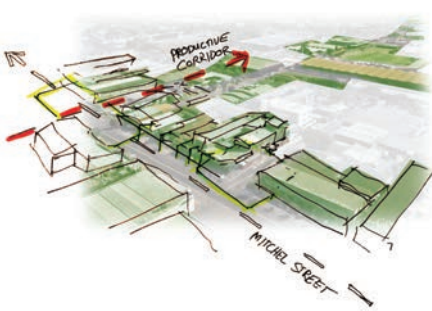
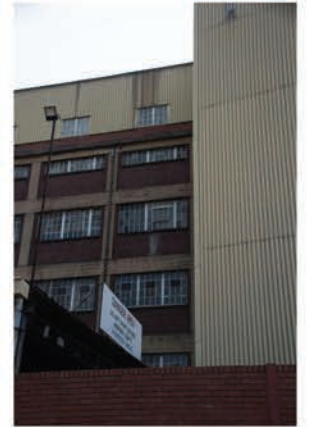

Fig. 01. Above: Image name or title (Author, 2017)

Fig. 01. Above: Image name or title (Author, 2017)

Fig. 01. Above: Image name or title (Author, 2017)

CONTEXT



MODEL FOR ADDITIONS

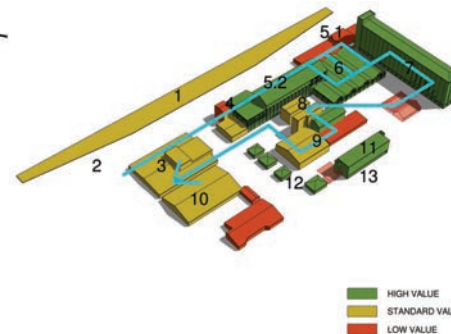
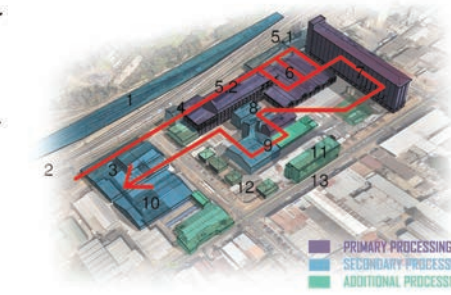
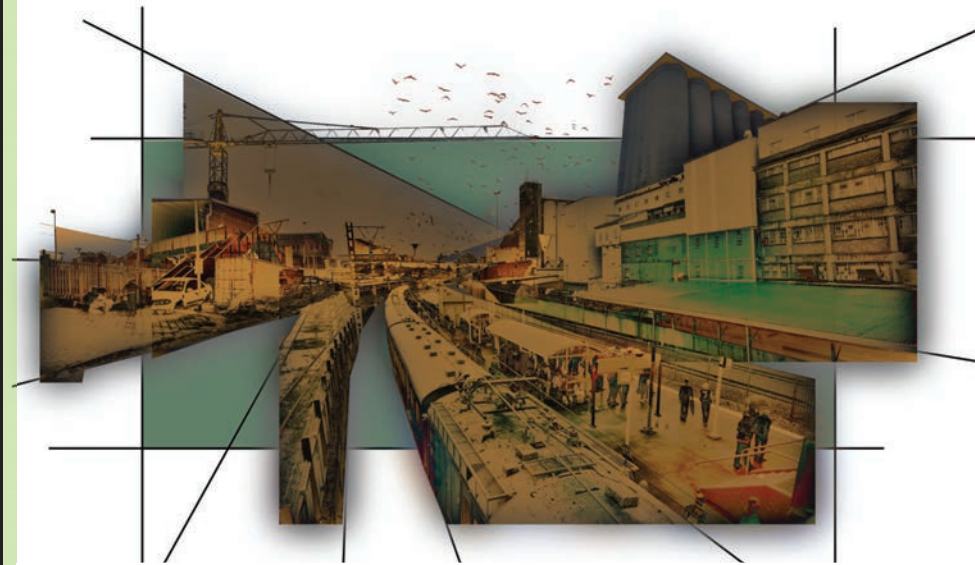

Extension of Existing Processes into New Programmes

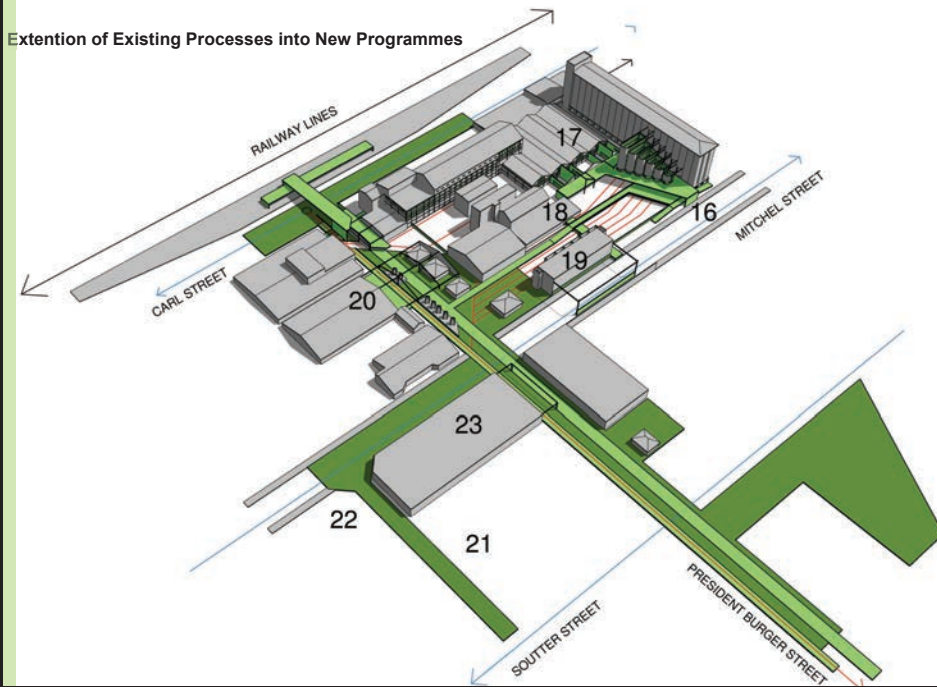

- EXISTING PROCESS DRIVEN STRUCTURES:**
- 1 - TRAIN STATION: PUBLIC TRANSPORT/WORKFORCE COMMUTE
 - 2 - CARL STREET: TRUCK STACKING & ACCESS
 - 3 - LOGISTICS: GRAIN SUPPLY & DISTRIBUTION CENTRE
 - 4 - INDUSTRIAL RAIL: RAIN-CAK STACKING & GRAIN SUPPLY
 - 5.1 - SORTING PLANT: GRAIN DROP-OFF
 - 5.2 - SORTING PLANT: GRAIN SORTING/HUSKING
 - 6 - MILLING PLANT: GRAIN PROCESSING/SEPARATION
 - 7 - SILO: PROCESSED GRAIN STORAGE
 - 8 - FEEDER STACKS: PRE-PACKAGE OPERATION
 - 9 - PACKAGING STATION
 - 10 - PACK HOUSING: PACKAGED PRODUCE STORAGE
- NON PROCESS DRIVEN STRUCTURES:**
- 11 - ADMINISTRATION
 - 12 - OFFICE SPACE
 - 13 - TAKEAWAY OUTLET
 - 14 - BOUNDARY WALL
 - 15 - PARKING SPACES
- INTRODUCED PROCESSES:**
- 16 - WASTE PRODUCTS INDUSTRIES
 - 17 - PRIVATE INDUSTRY PRODUCTION
 - 18 - PRIVATE INDUSTRY SHOPFRONTS
 - 19 - LABOURER'S DWELLINGS
 - 20 - PACKHOUSE DEPOT
 - 21 - PRETORIA COLD STORAGE (EXISTING)
 - 22 - THERON'S MEAT MARKET (EXISTING)
 - 23 - EXTENDED MEAT MARKET (CURRENTLY UNOCCUPIED)
- *INCLUDING INFORMAL STREET VENDORS

Fig. 5.3 1968 Aerial Photo of the Milling Site
<https://supremeflour.co.za/why-supreme/heritage/2017/>



Fig. 5.4 Current Milling Site (Google Earth, 2017)



Fig. 5.5 Photo of Original Milling Structure
<https://supremeflour.co.za/why-supreme/heritage/2017/>



Fig. 5.6 Additive Extension to Original Structure (Author, 2017)



PROGRAMMATIC DESIGN- CROSS-PROGRAMMING

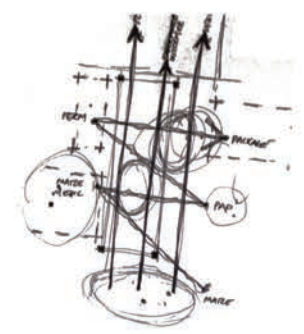
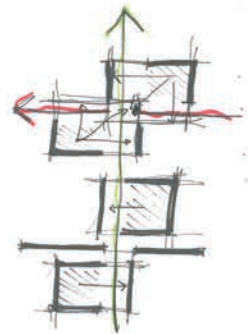
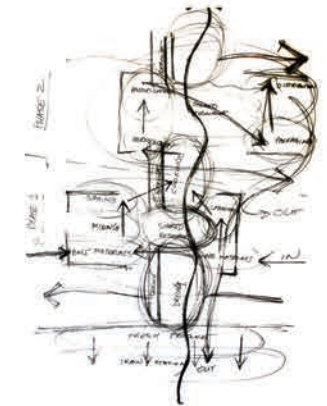
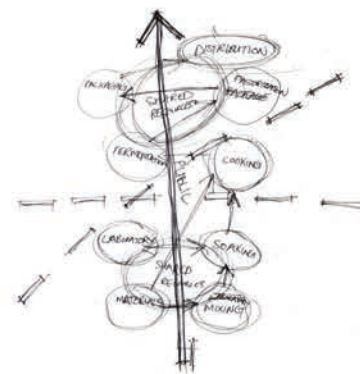
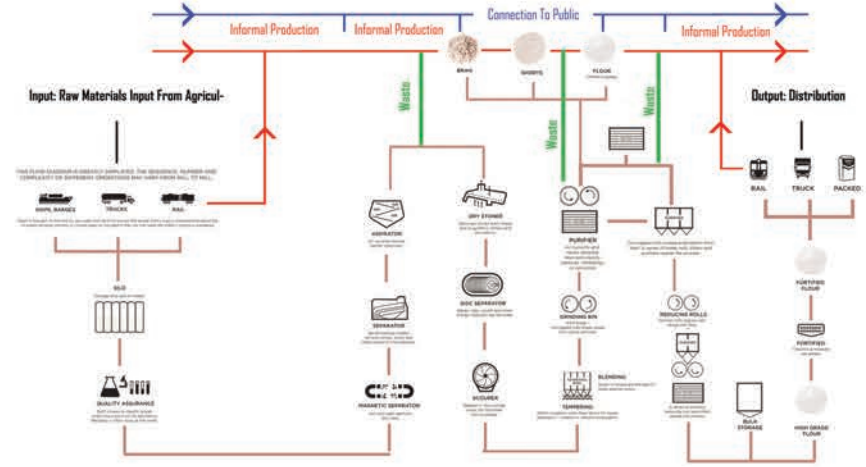
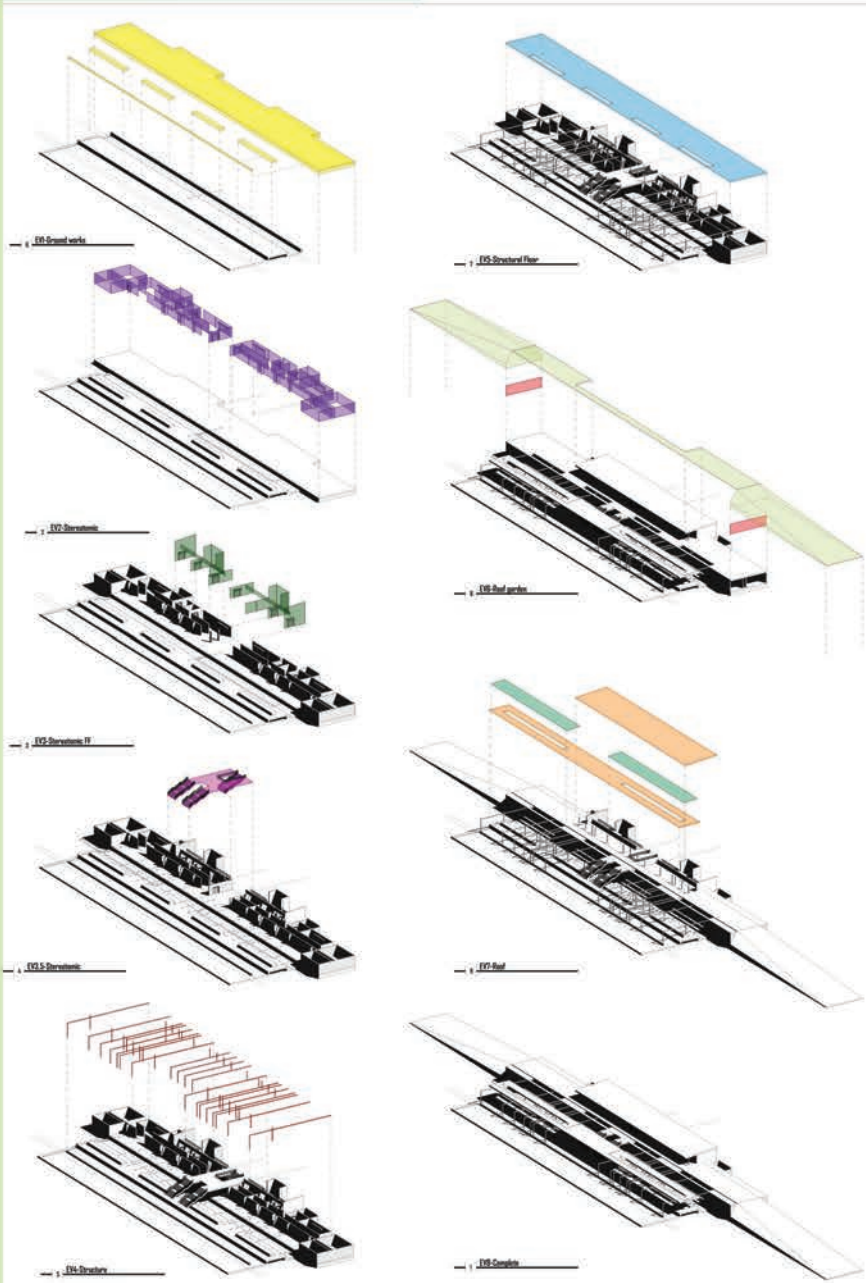

PROGRAMMATIC DESIGN- CROSS-PROGRAMMING

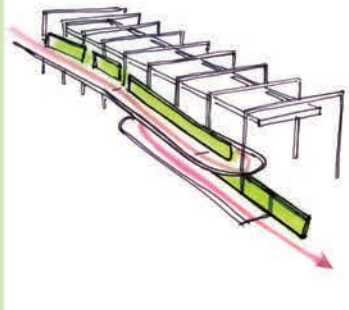
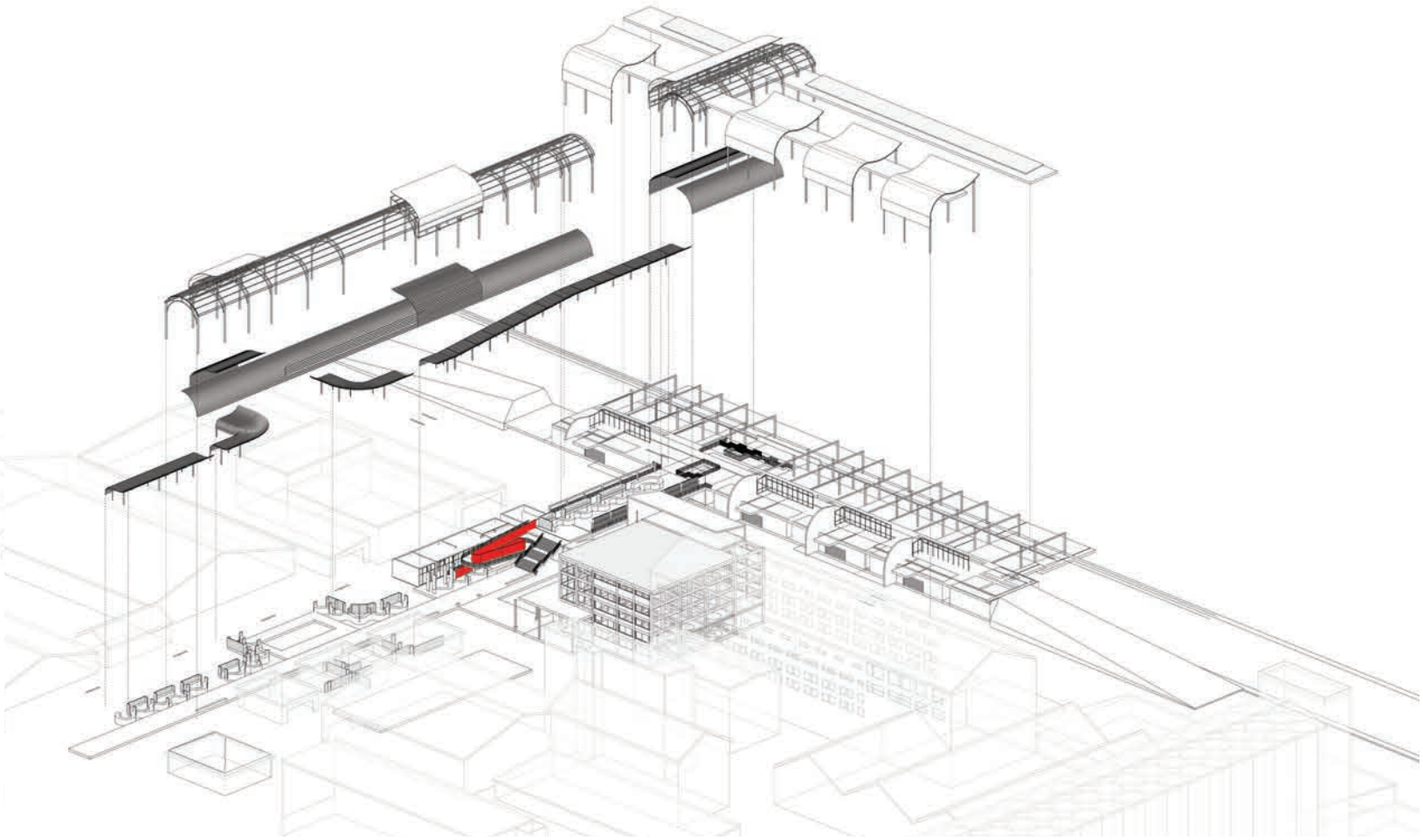
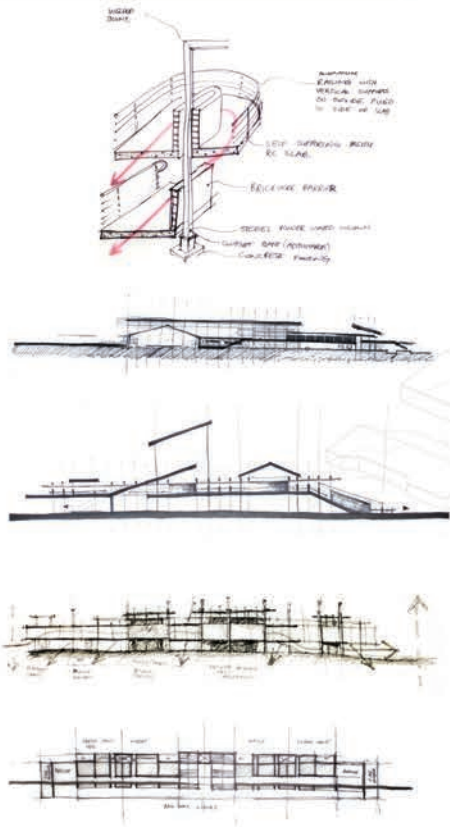

DEVELOPMENT OF FLOOR PLAN

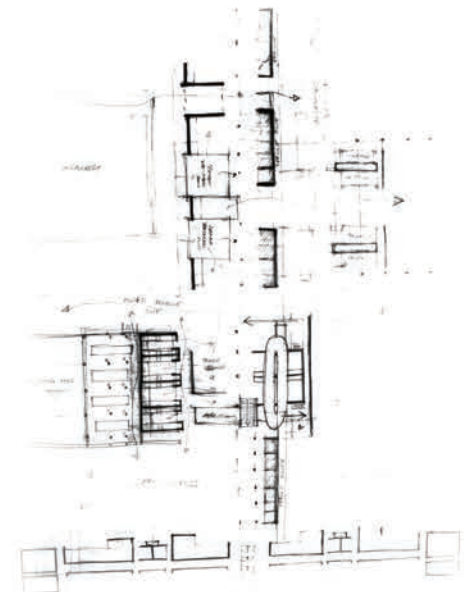
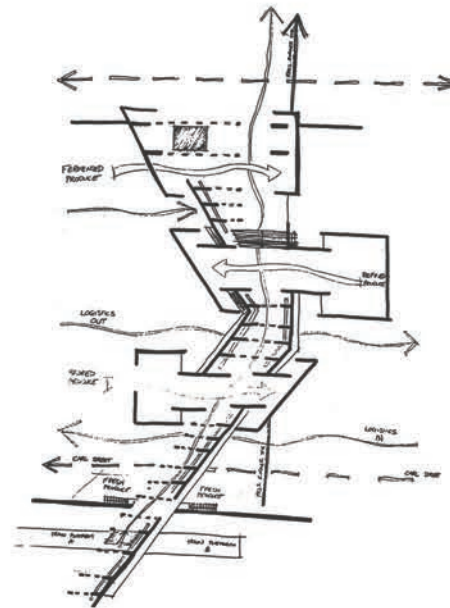
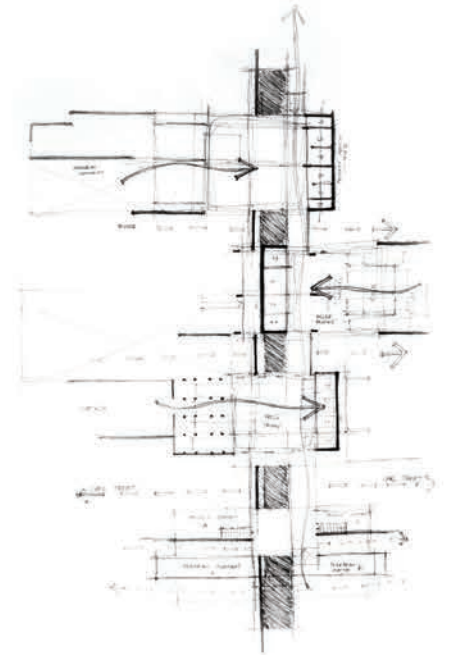
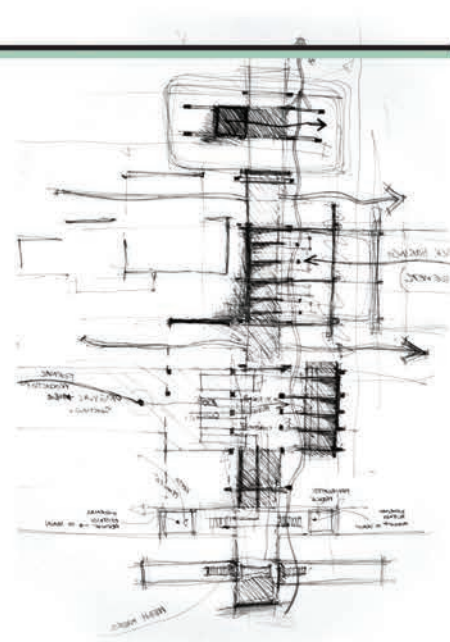
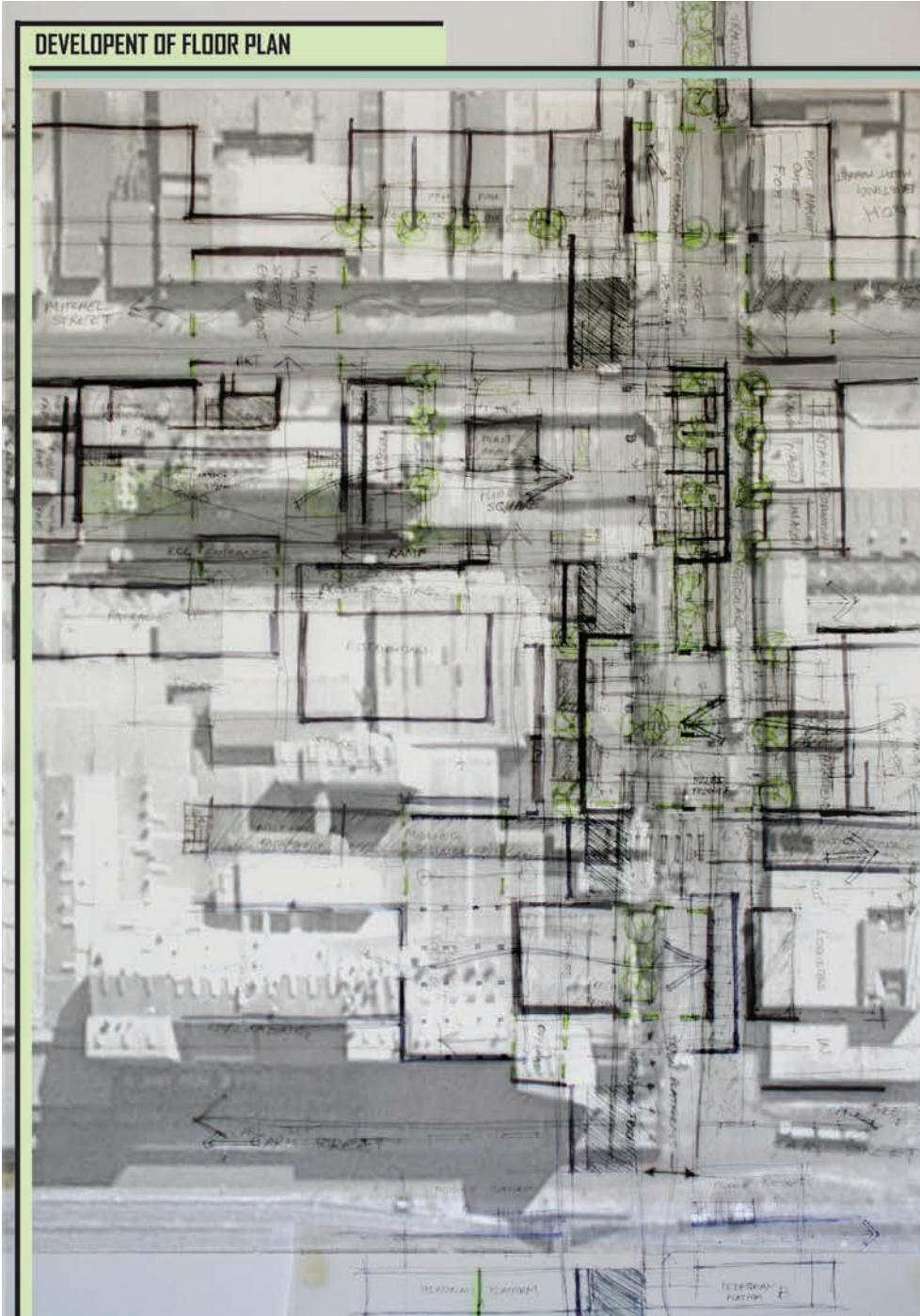

FLOOR PLANS

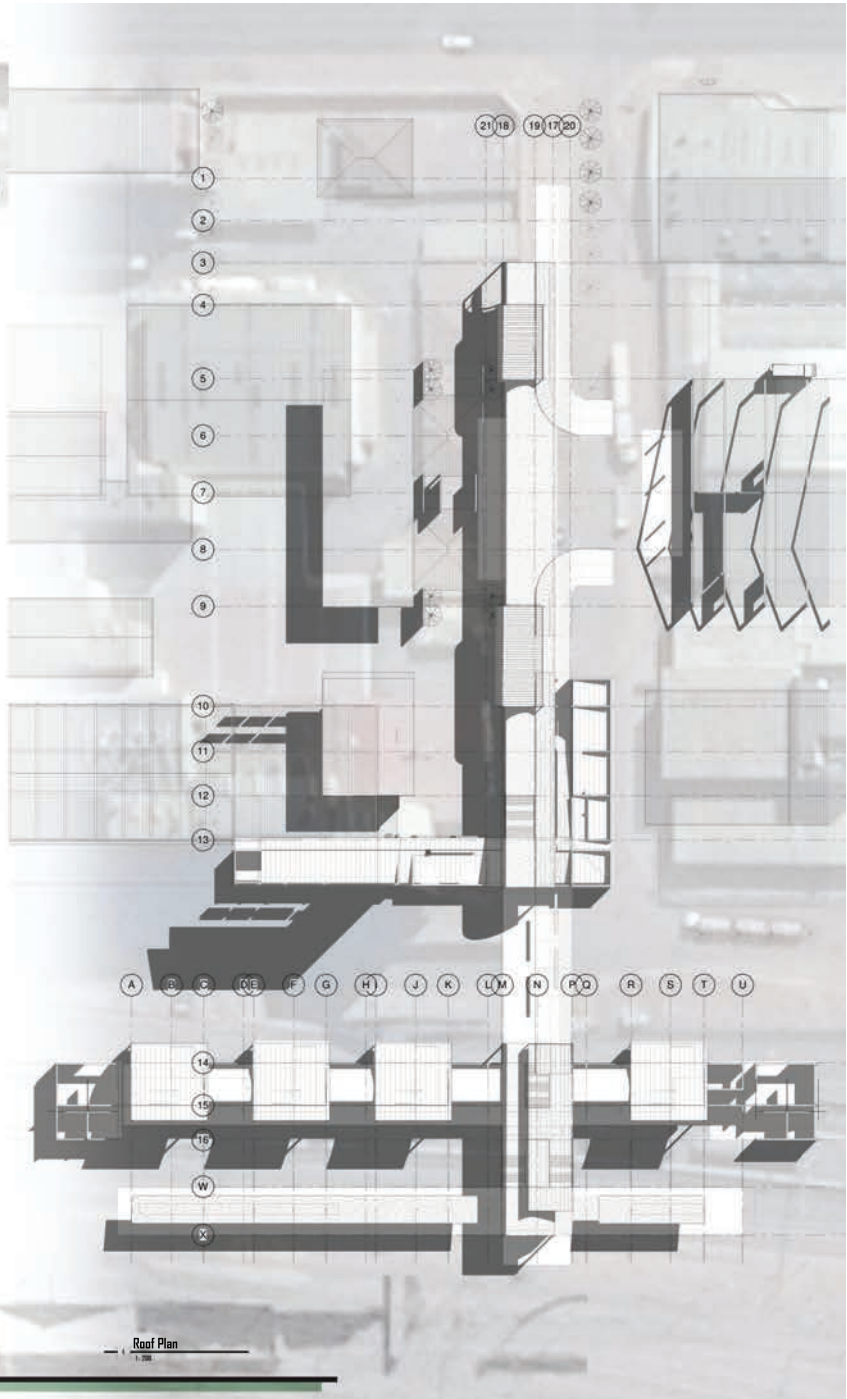

FLOOR PLANS

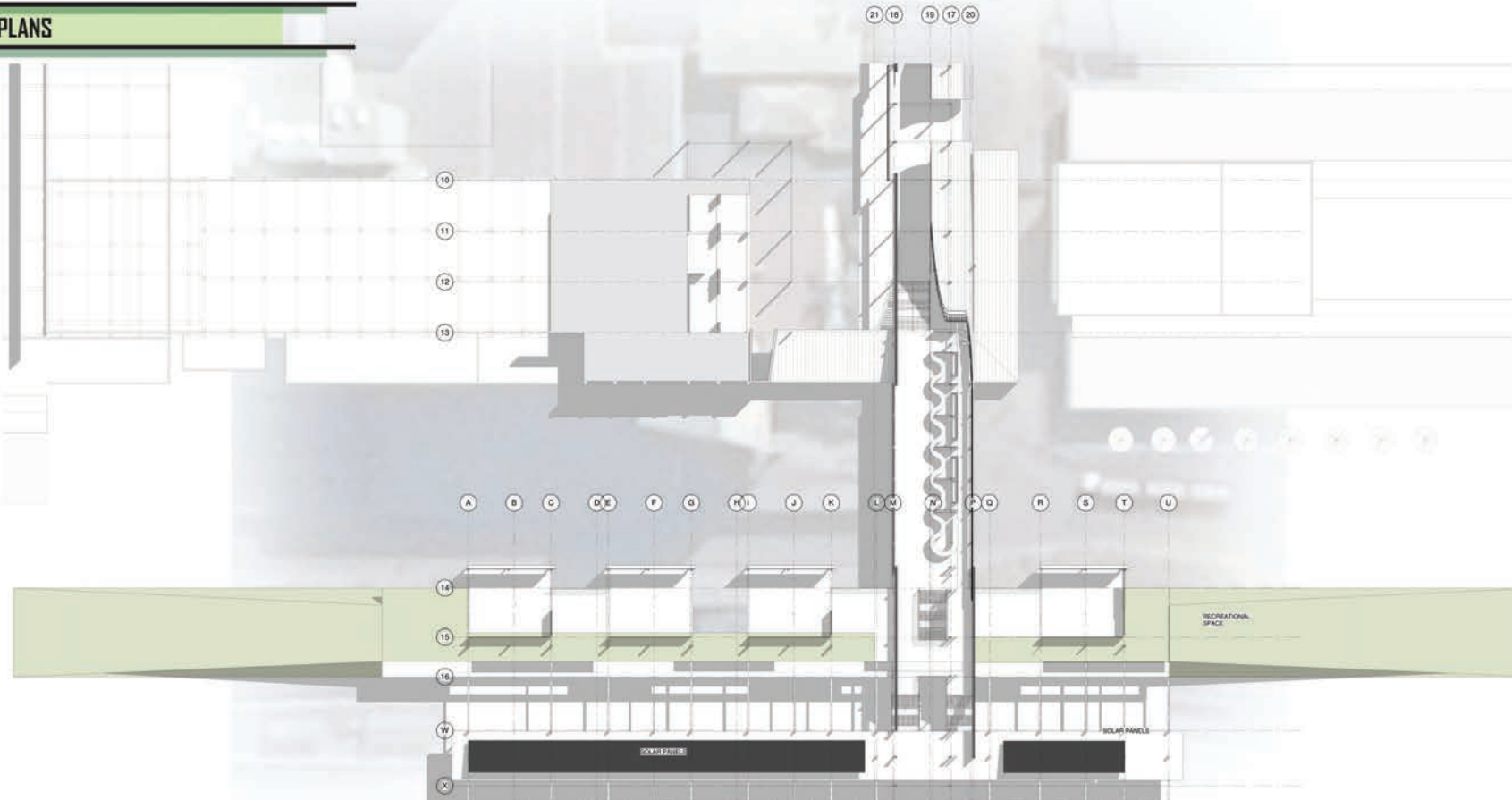

Train Station First Floor Plan

1:200

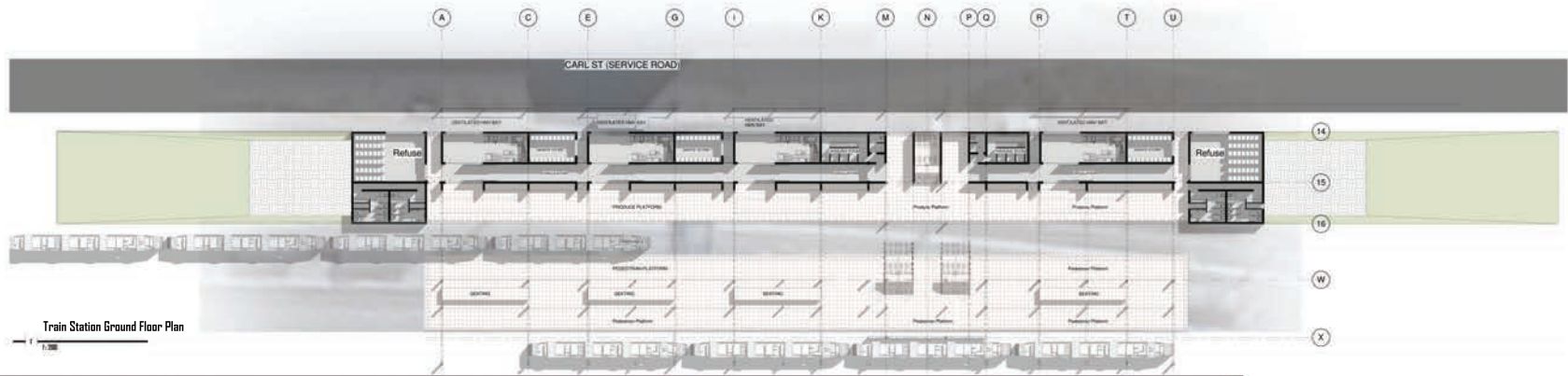

Train Station Ground Floor Plan

1:200

TECHNIFICATION

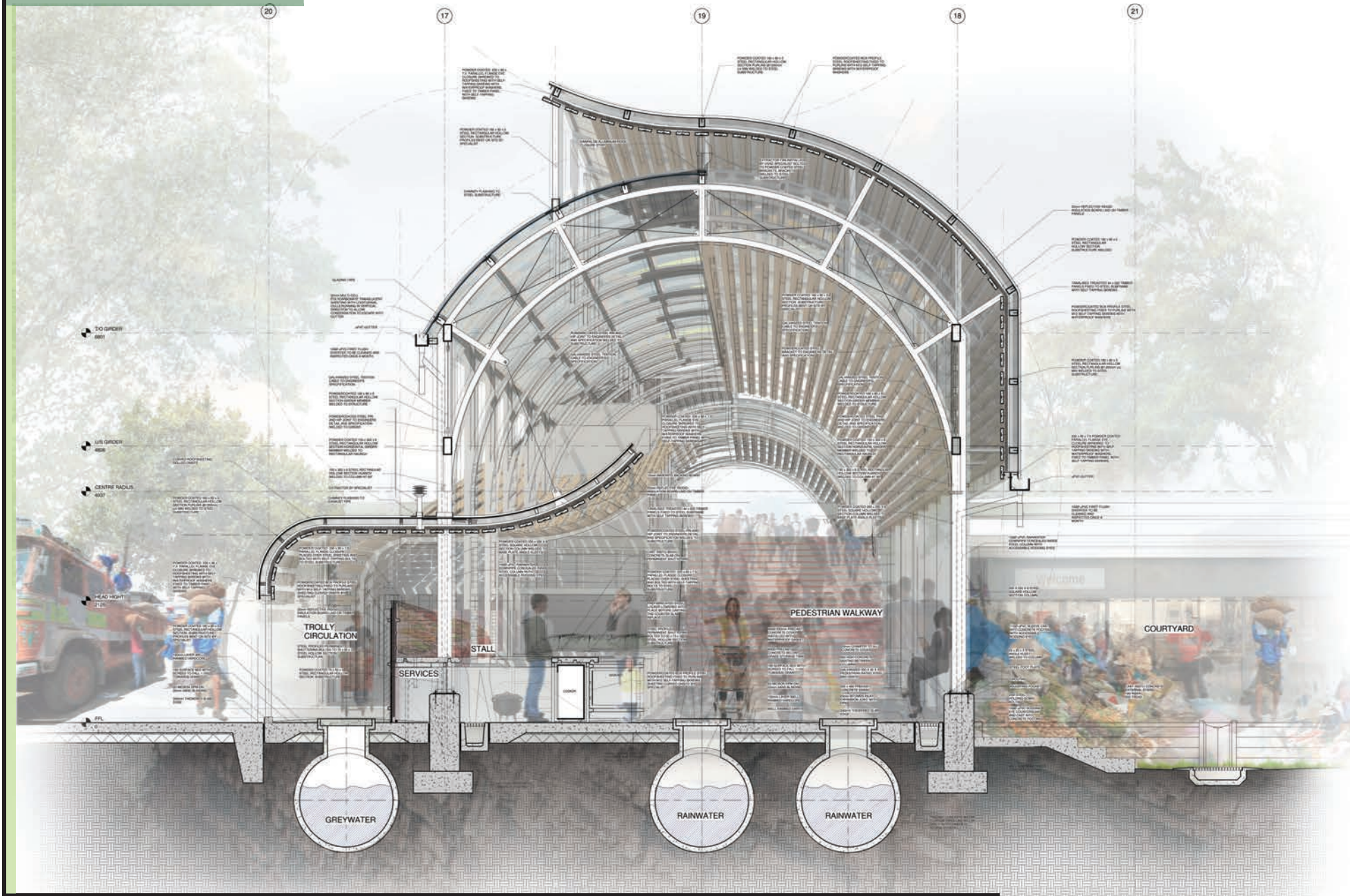

DAYLIGHTING

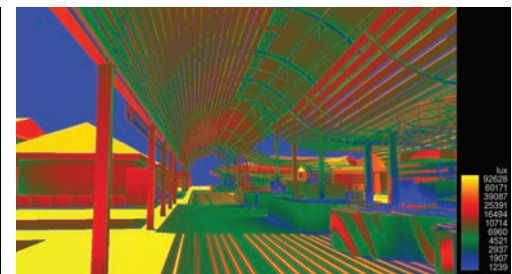
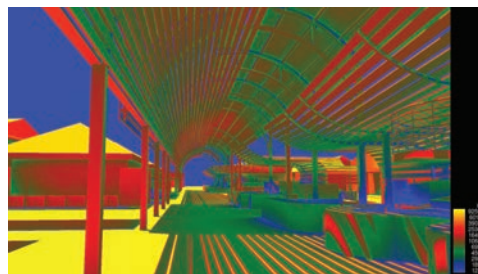
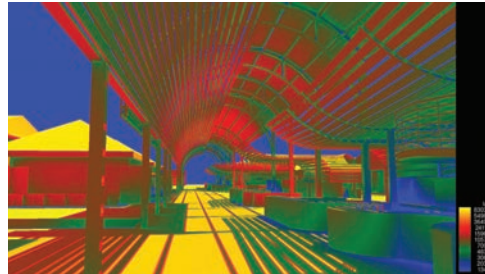
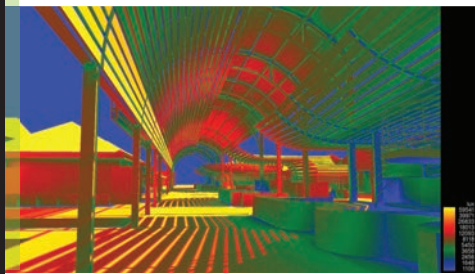
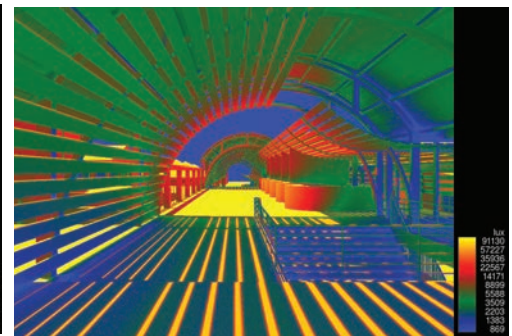
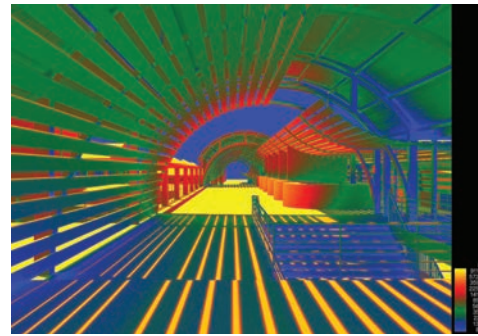
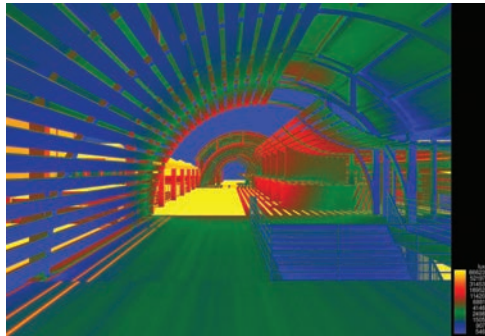
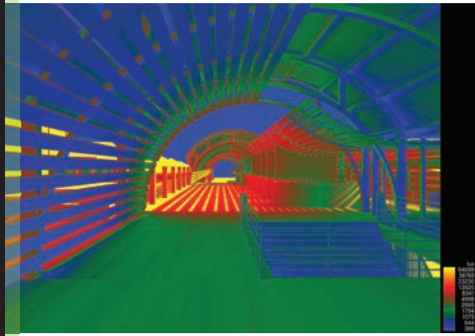
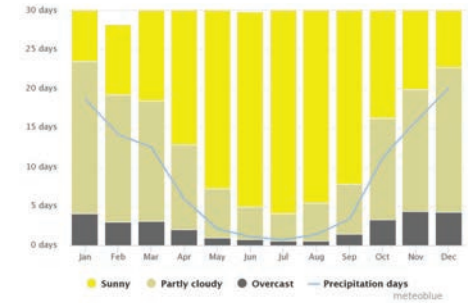
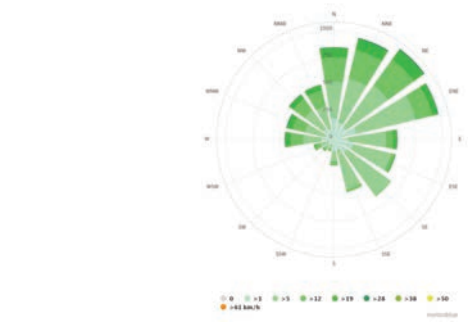
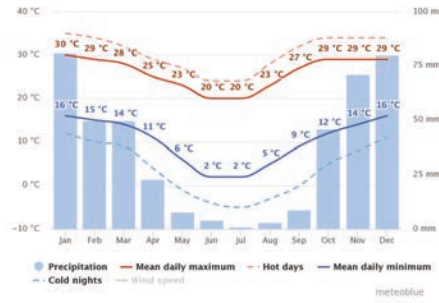
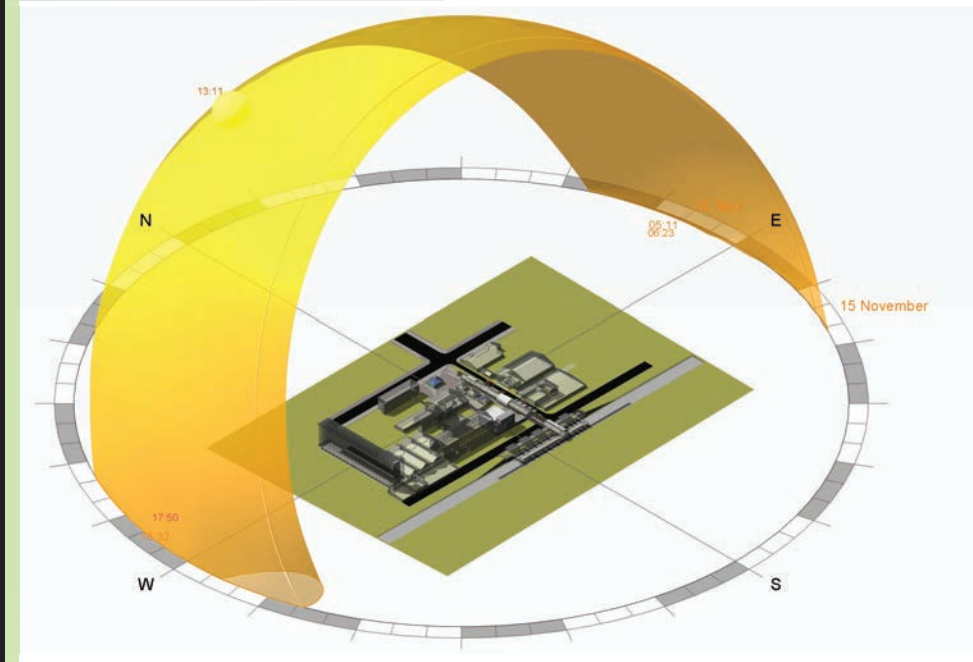

VENTILATION DESIGN

Iteration 1



Iteration 2



Iteration 3



Iteration 4

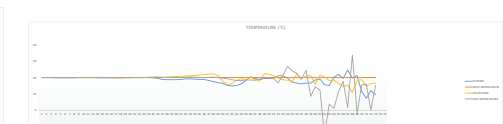
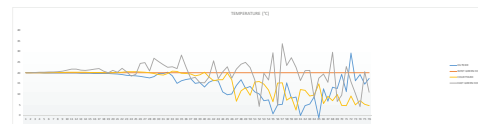
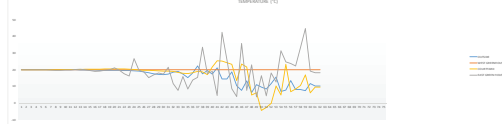
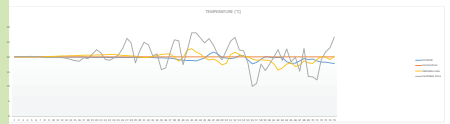

Iteration 5



Iteration 6



Iteration 7



Iteration 8

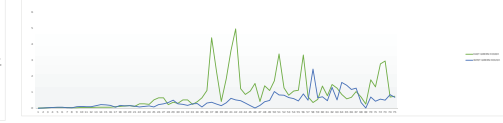
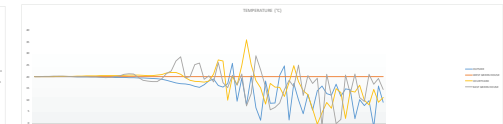
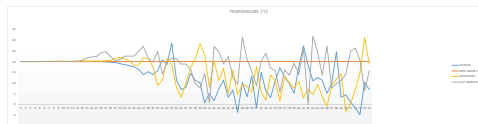
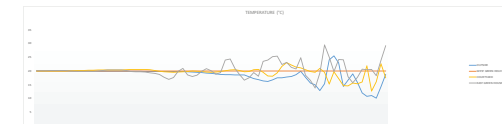
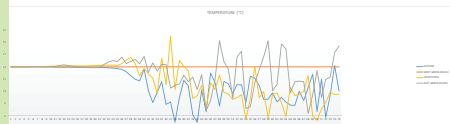

SECTIONAL ELEVATION

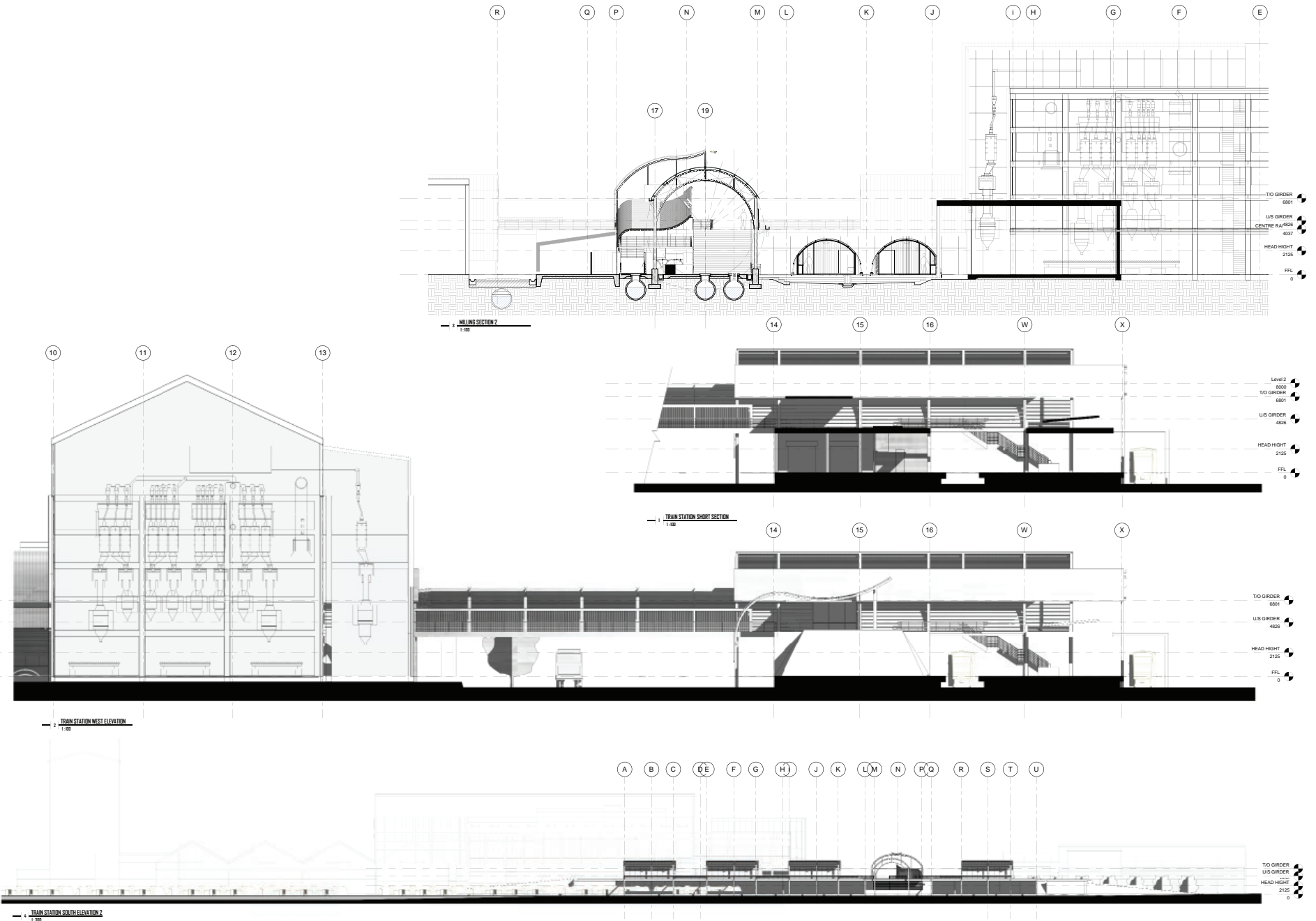

ELEVATIONS

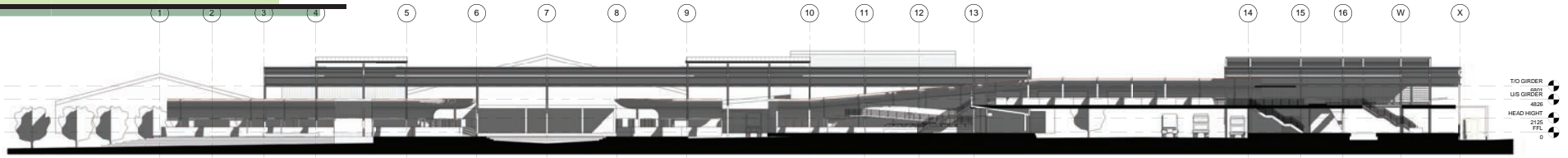

EAST SECTION
1:200



WEST ELEVATION
1:200

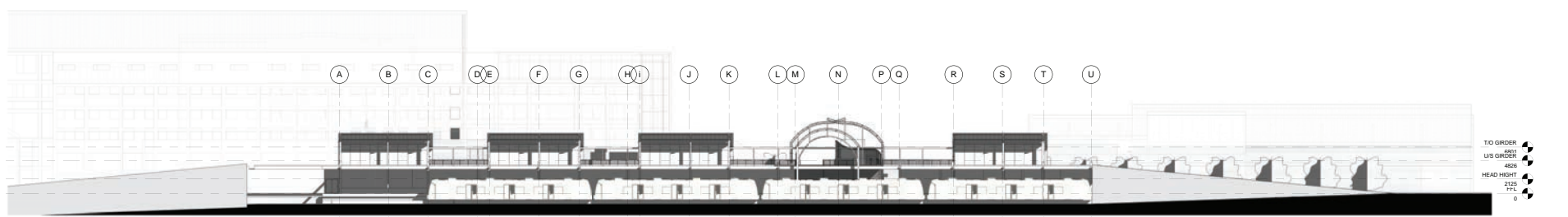

TRAIN STATION SOUTH ELEVATION
1:200

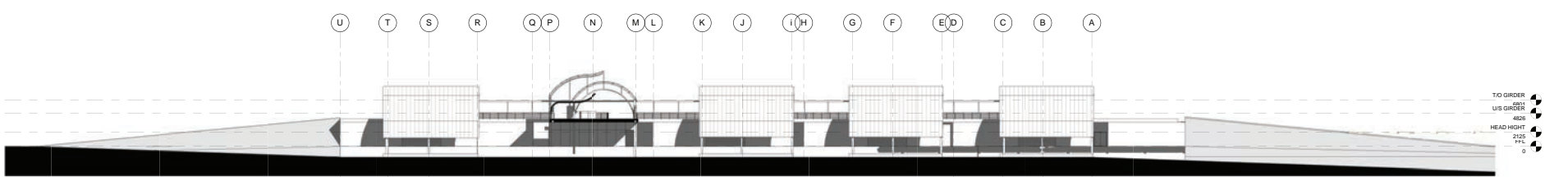

TRAIN STATION NORTH VIEW
1:200

RENDERS

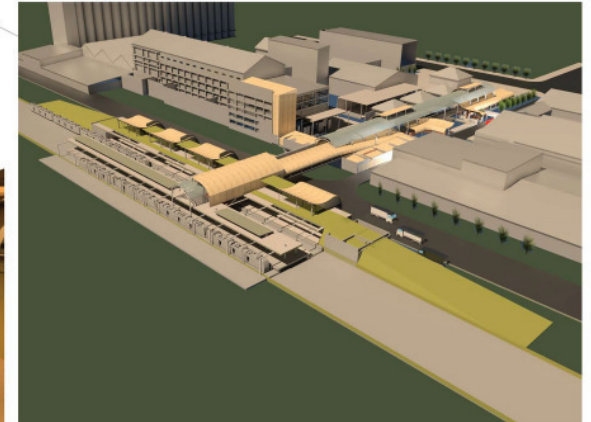
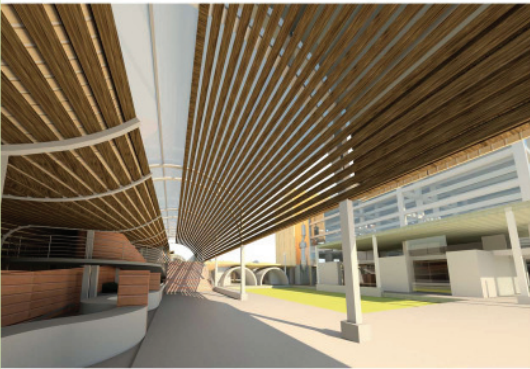
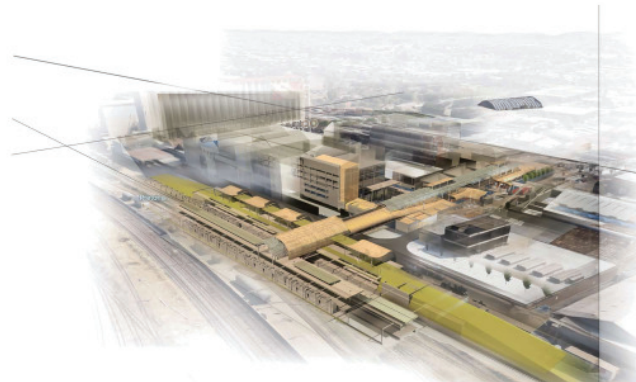
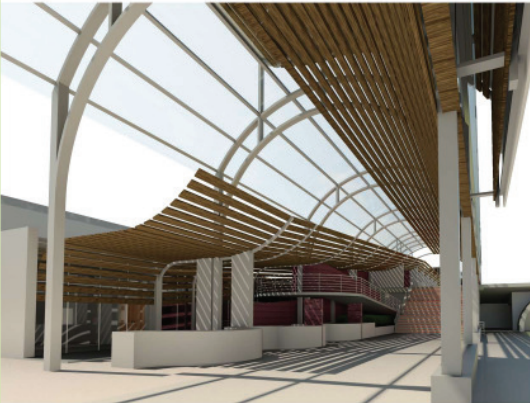
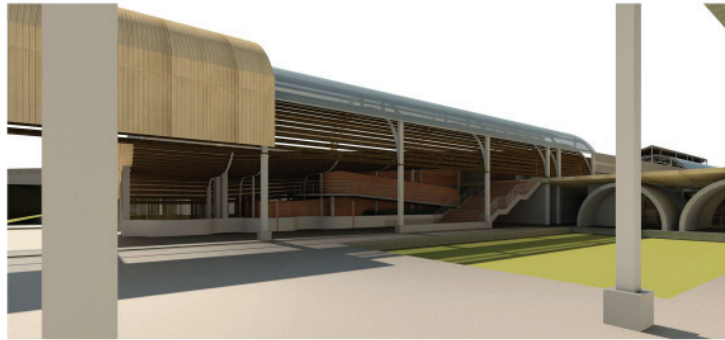

HERITAGE IN CONTEXT

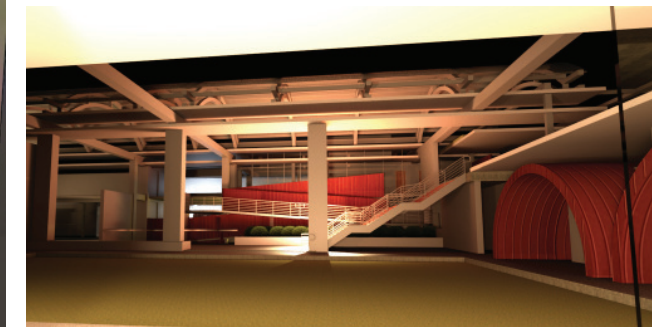



In formal food programs, not works
a Pretoria's story.

