

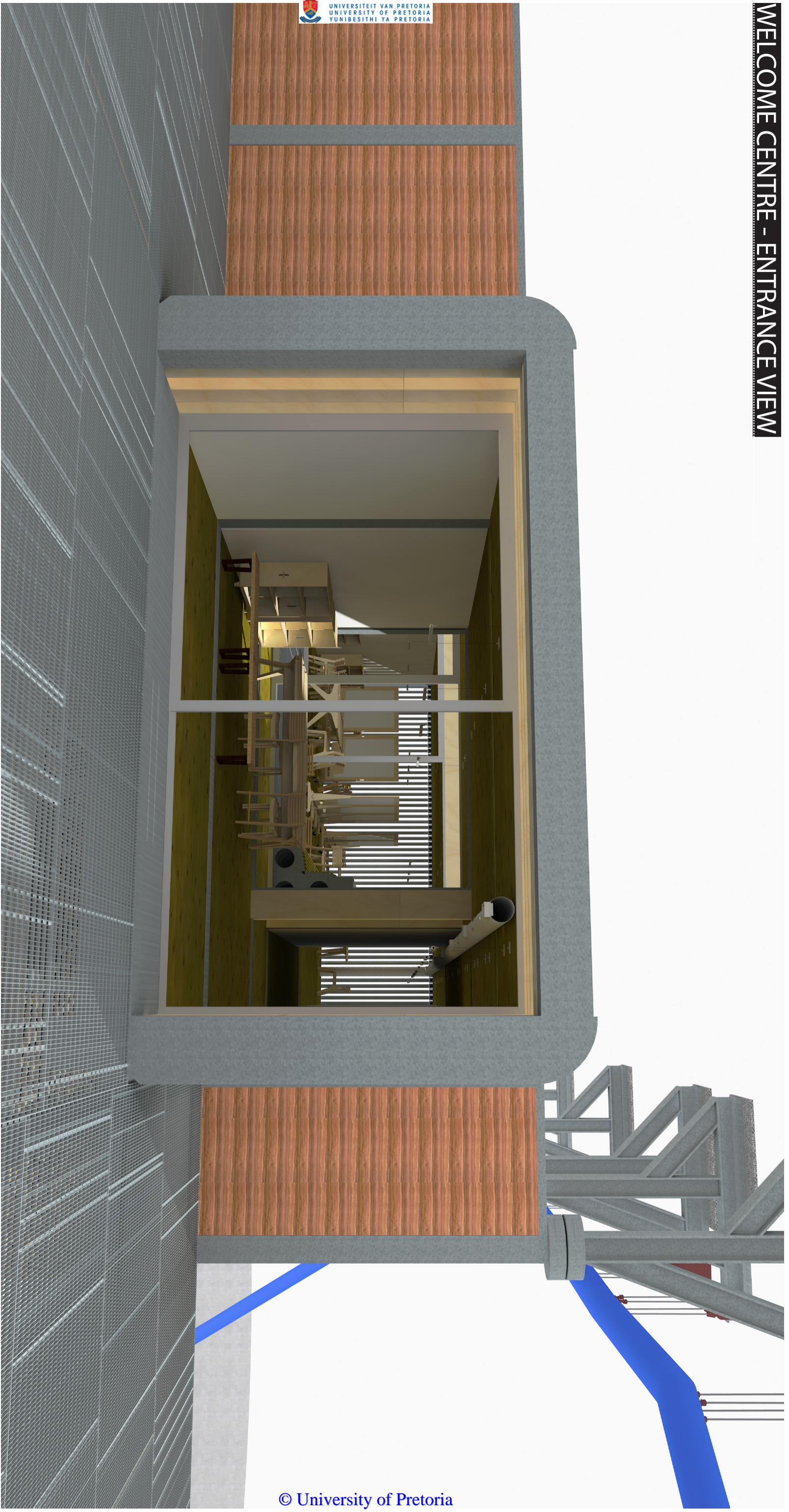

CHAPTER 06
FINAL PRESENTATION



6.1// RENDERS



WELCOME CENTRE - MEETING ROOM - VIEW ONE



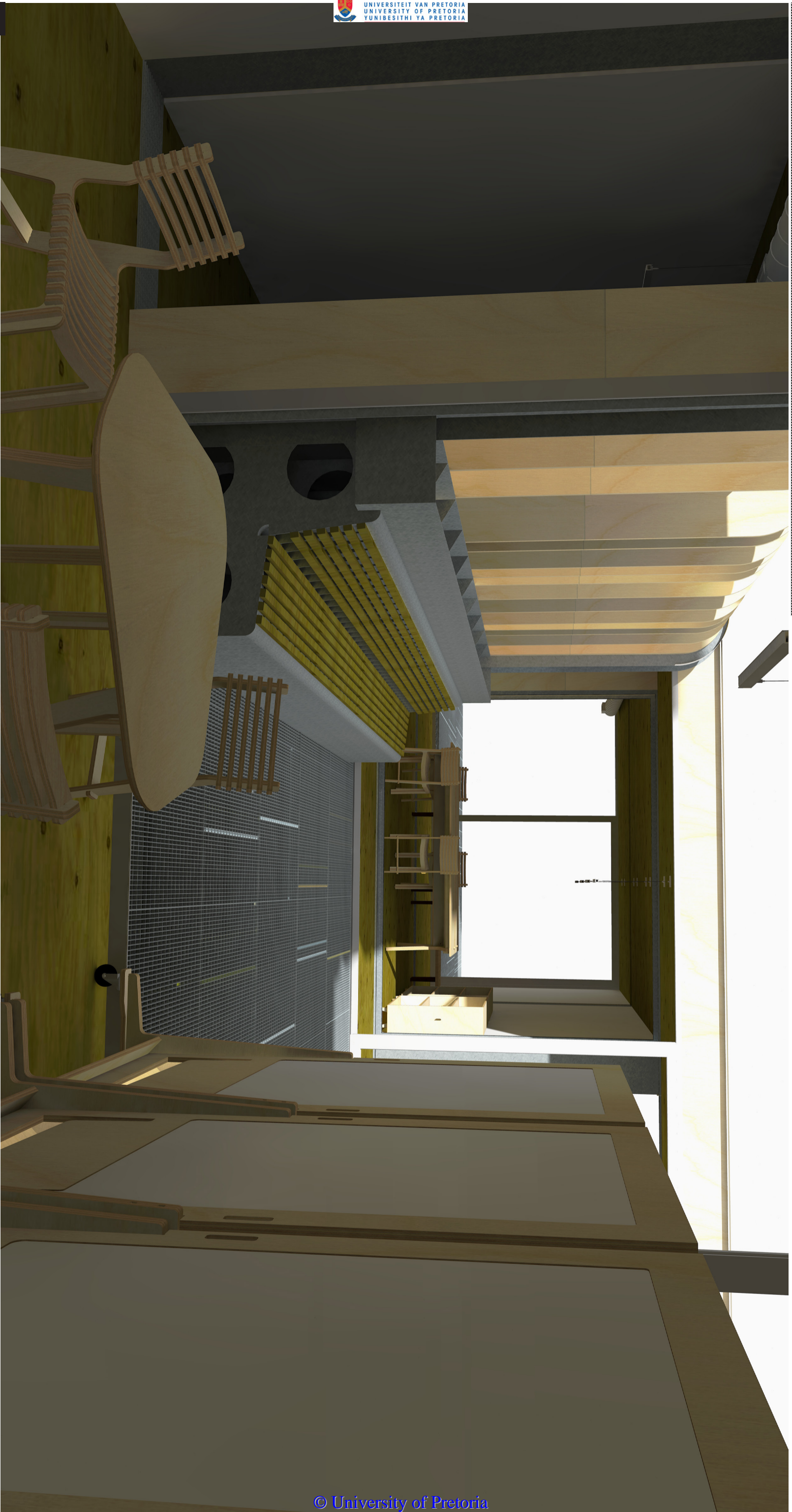

EXPLODED DIAGRAM - GREENHOUSE STRUCTURE & PUMP PLANT 1-50

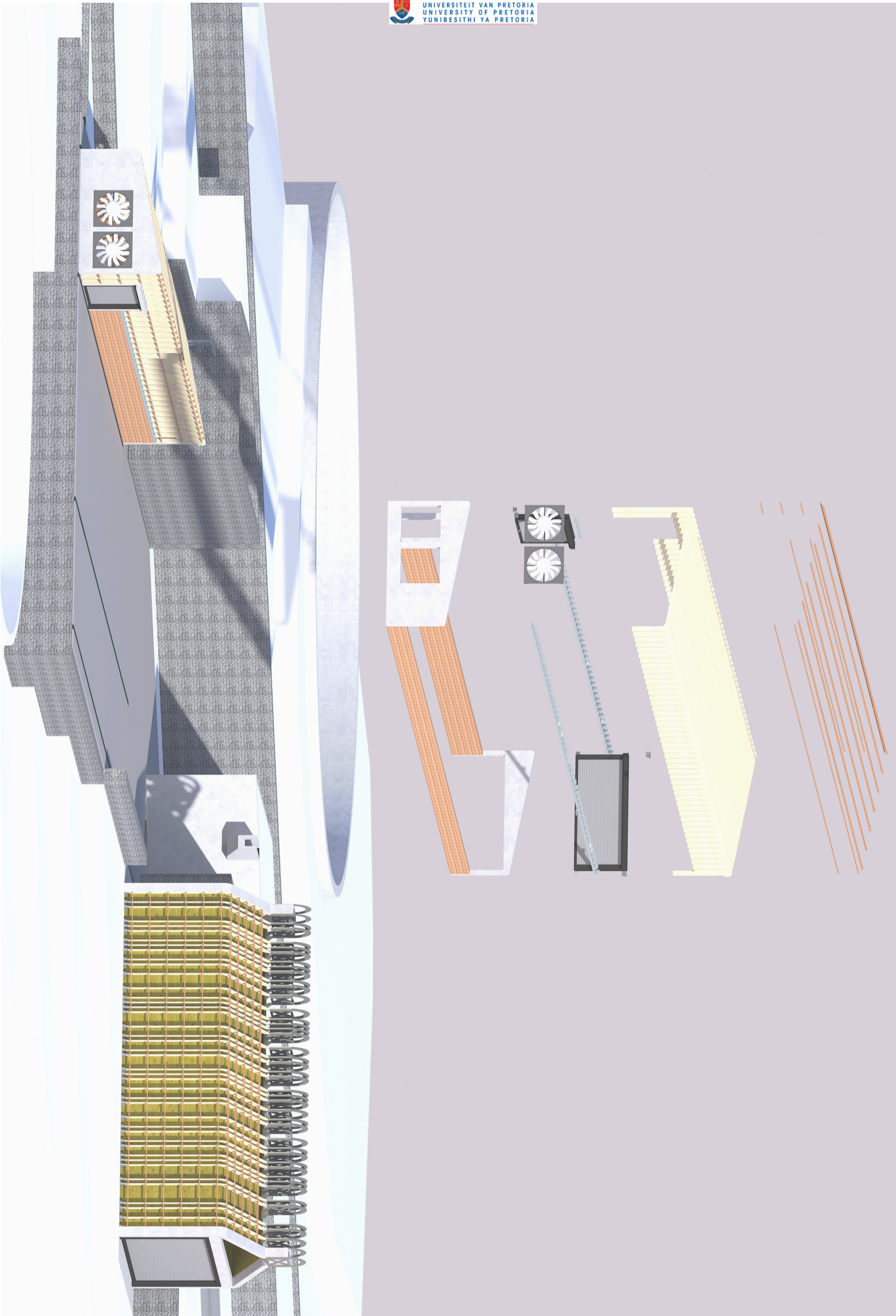

SOUTHERN SECTION - WELCOME CENTRE 1-20

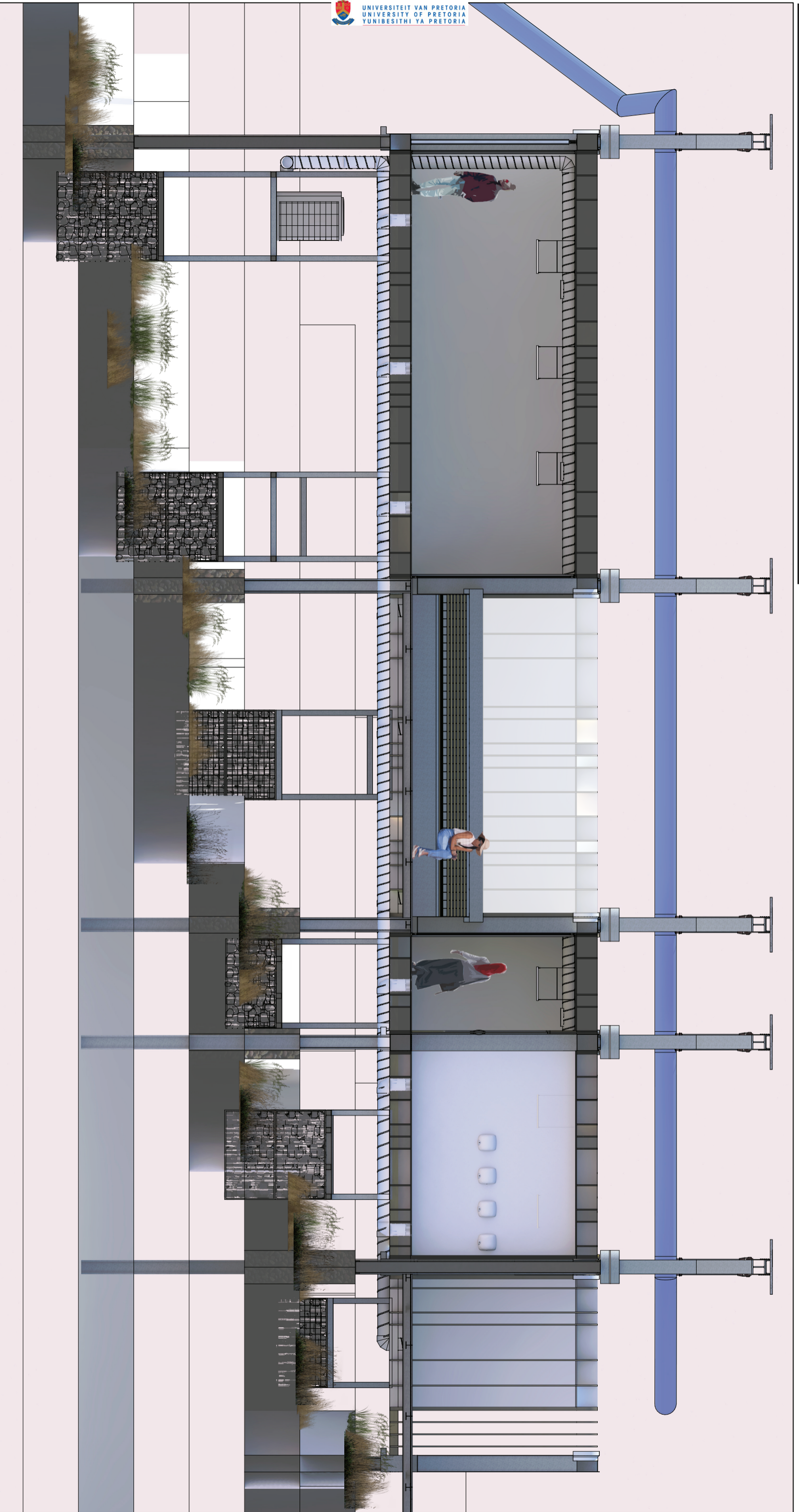



6.2// PLANS

FLOOR PLANS // SCALE 1-100

LABORATORY STRUCTURE // GROUND FLOOR

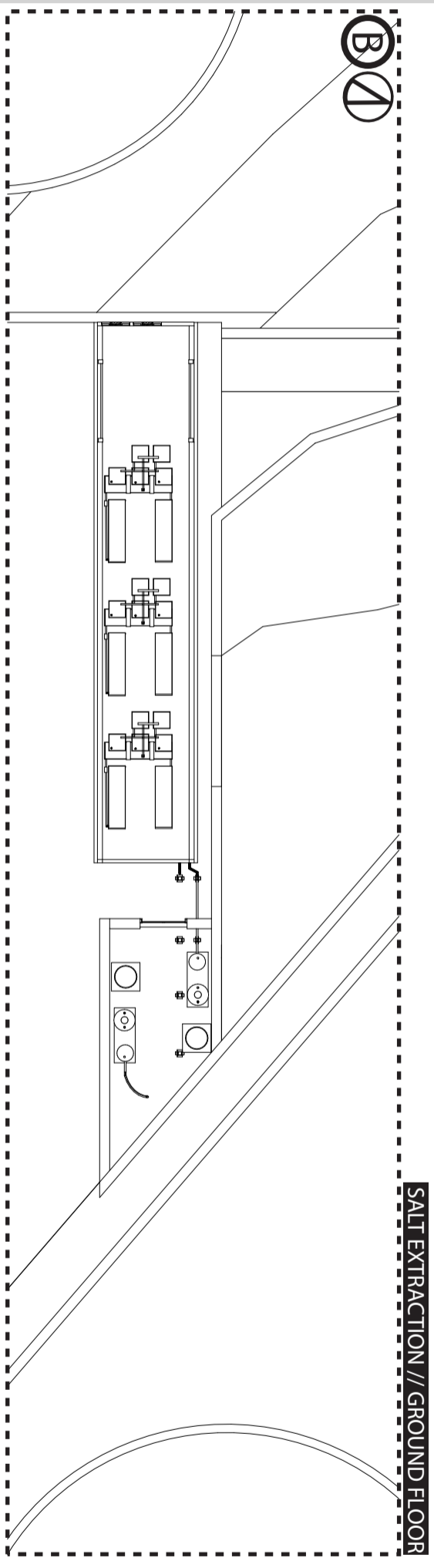
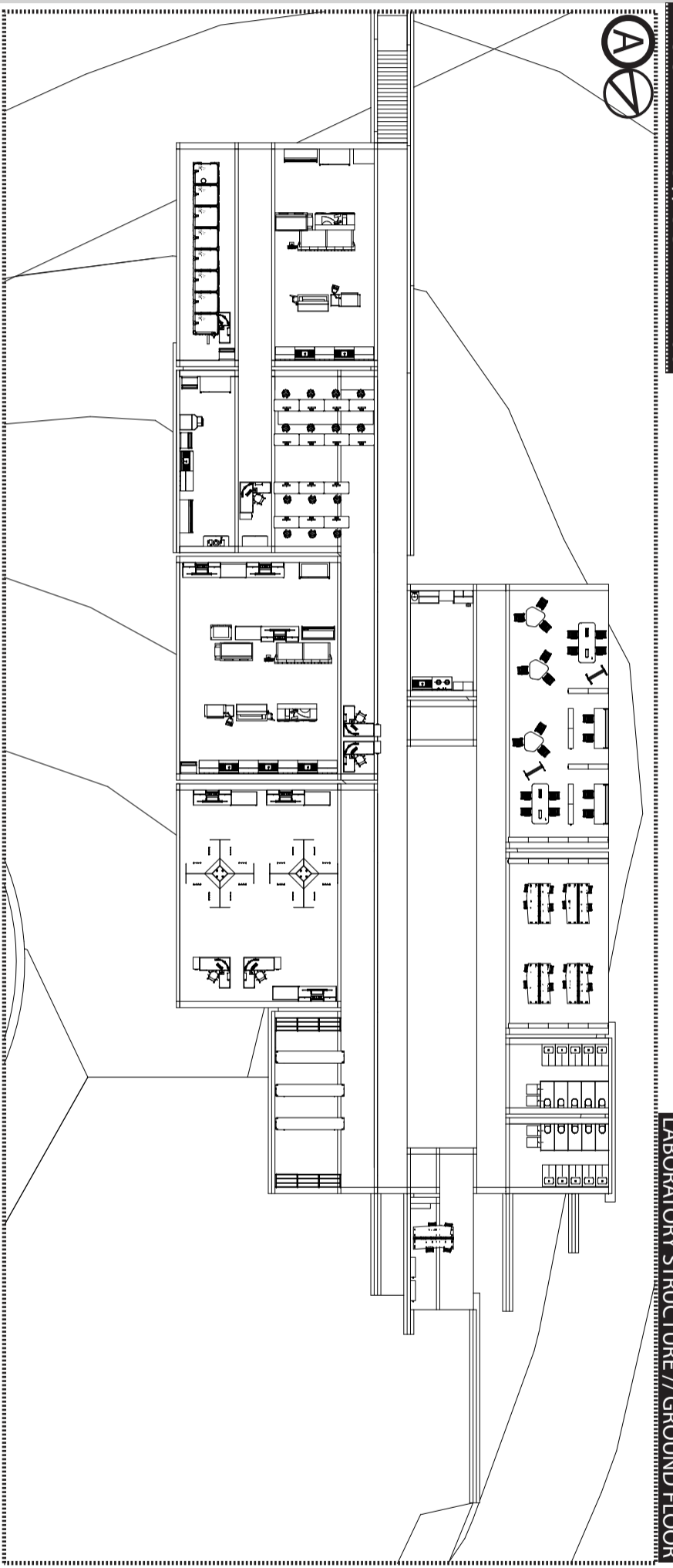

SALT EXTRACTION // GROUND FLOOR

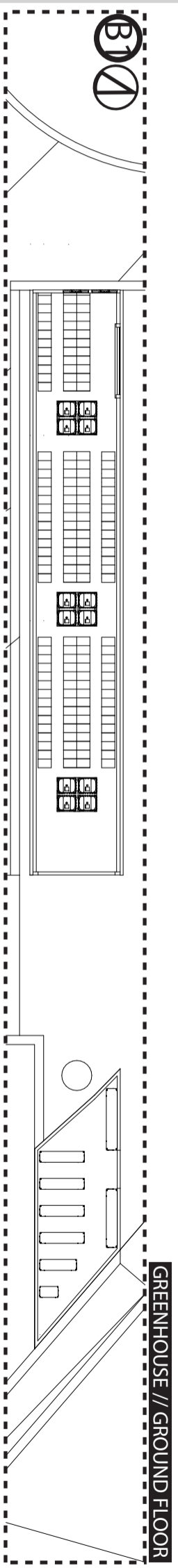

GREENHOUSE // GROUND FLOOR

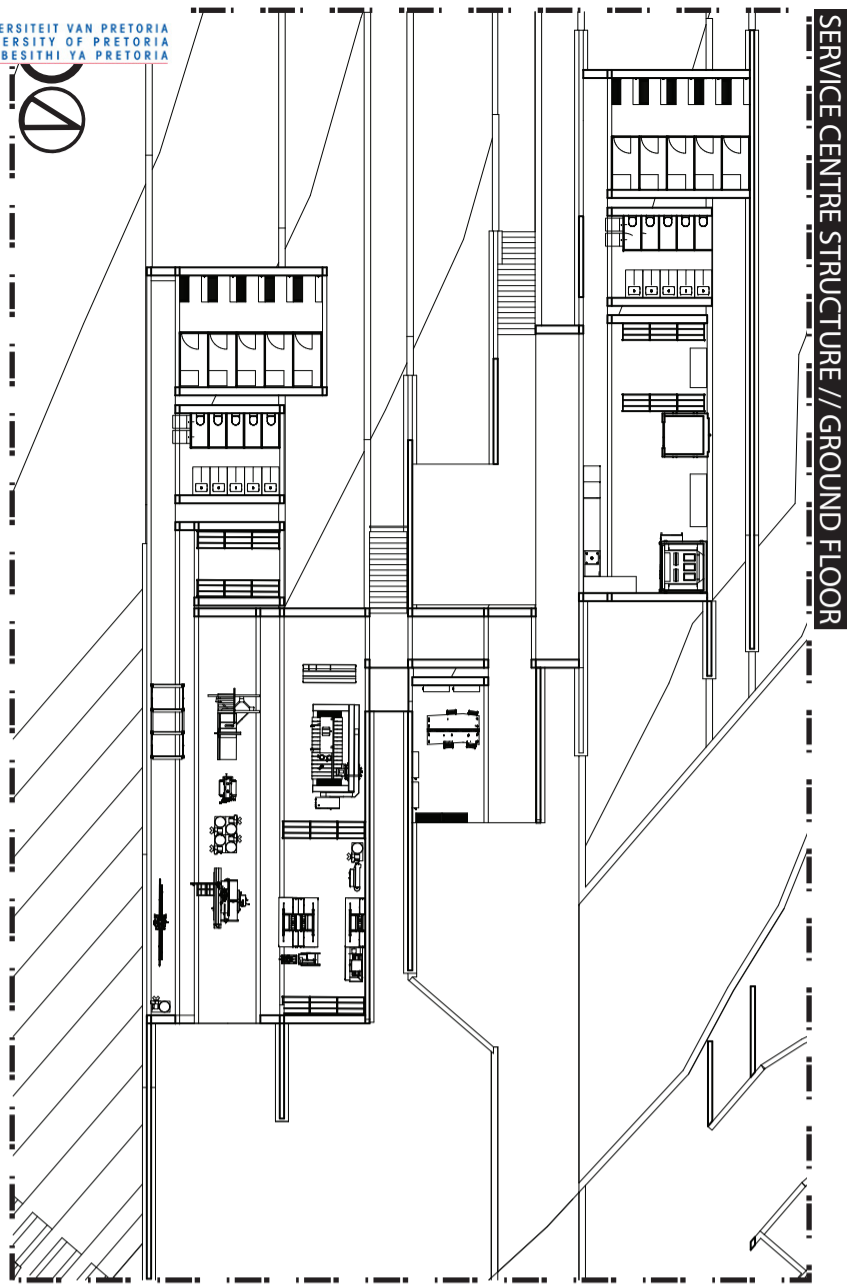

SERVICE CENTRE STRUCTURE // GROUND FLOOR

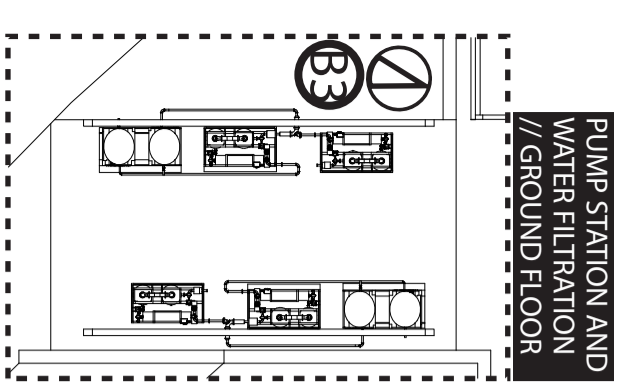

PUMP STATION AND
WATER FILTRATION
// GROUND FLOOR

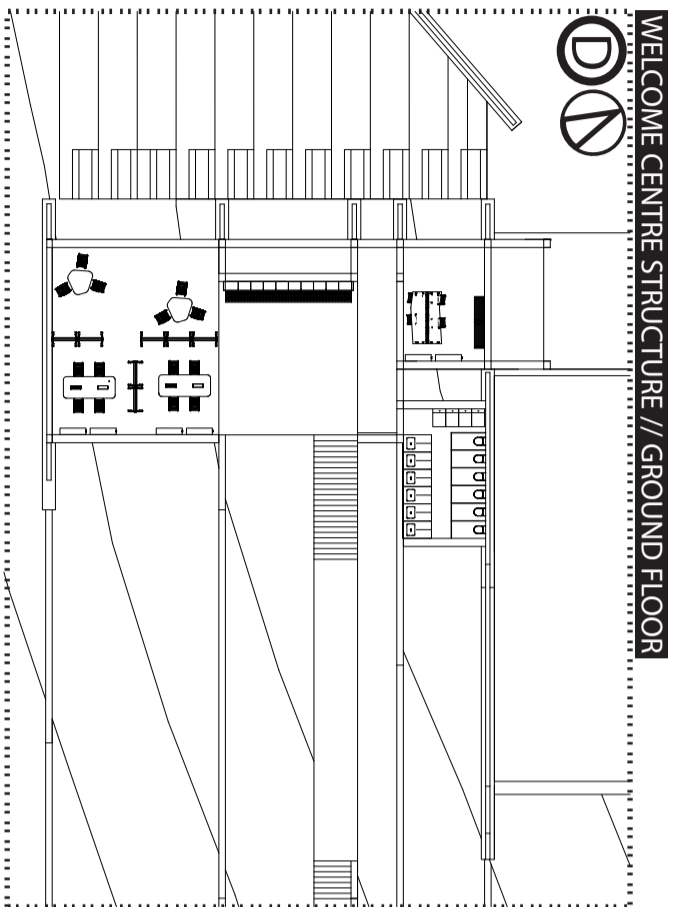

WELCOME CENTRE STRUCTURE // GROUND FLOOR

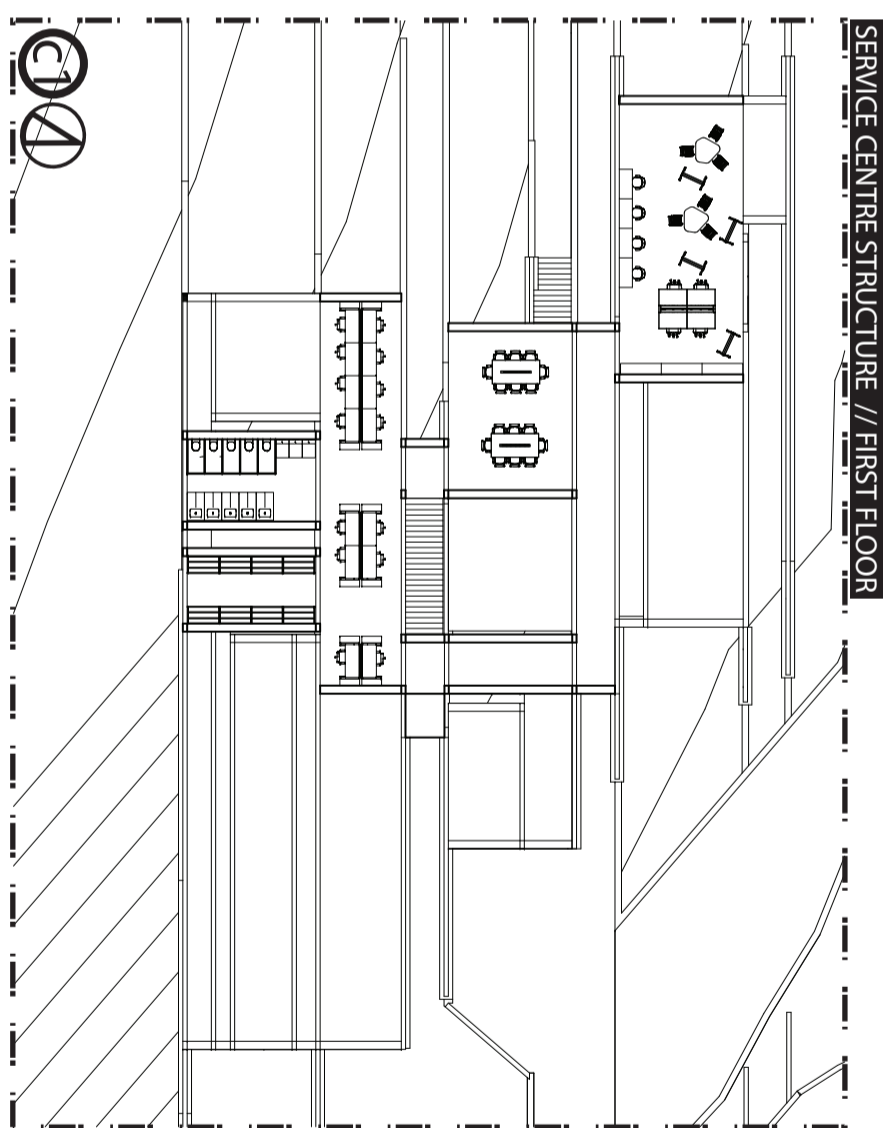

SERVICE CENTRE STRUCTURE // FIRST FLOOR

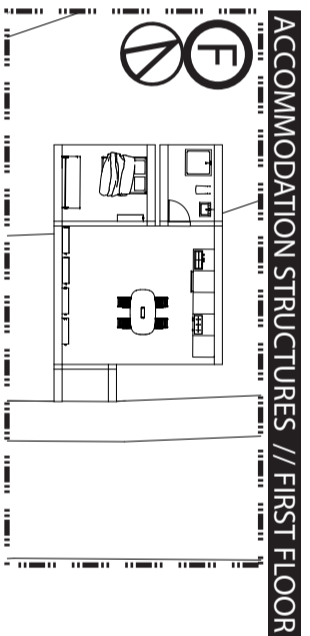

ACCOMMODATION STRUCTURES // FIRST FLOOR



6.3// TECHNICAL

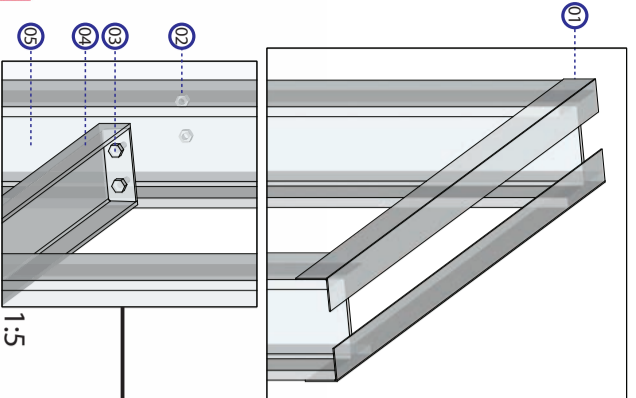

- 1 110mm x 100mm - S515 JR STEEL COLUMN - 13m STANDARD LENGTHS STRUCTURAL STEEL - MIN 355N/mm² YIELD STRENGTH
- 2 ASTM A563 - COMPATIBLE HEAVY HEX NUT (DIAMETER TO ENGINEERS SPECIFICATIONS)
- 3 A325 TYPE 1, ASTM F436, HEAVY HEX STRUCTURAL BOLT (DIAMETER TO ENGINEERS SPECIFICATIONS)
- 4 32mm x 80mm - EN10025 S235JR - PARALLEL FLANGE CHANNEL
- 5 25x25x3mm - S515 JR STEEL COLUMN - 13m STANDARD LENGTHS STRUCTURAL STEEL - MIN 355N/mm² YIELD STRENGTH

1:5

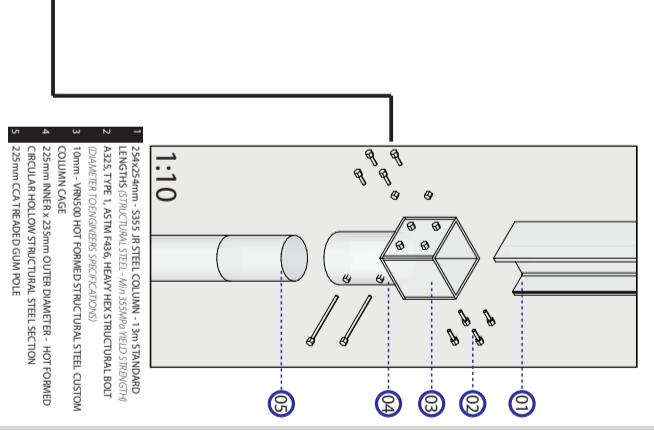
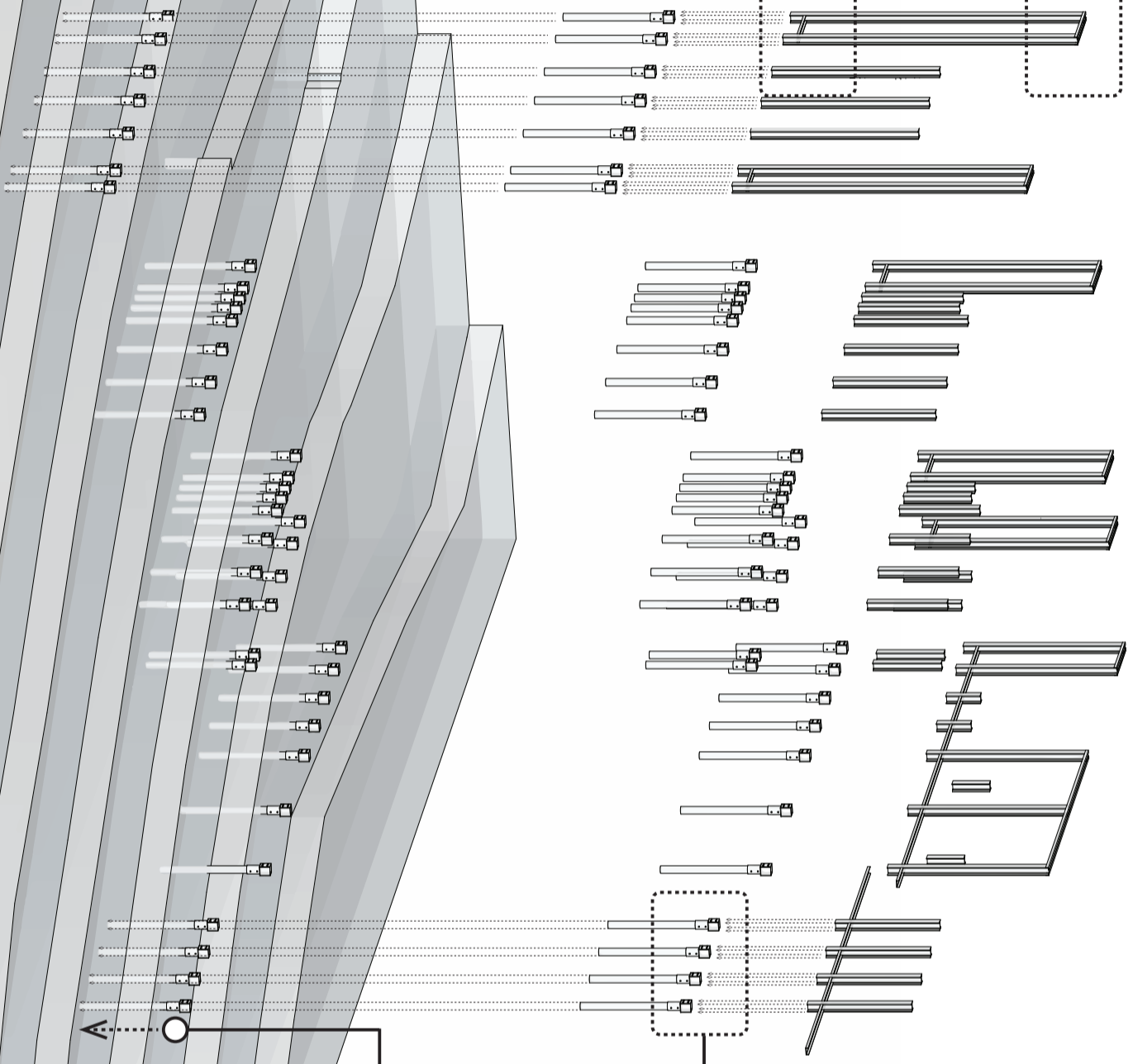

- 1 25x25x3mm - S515 JR STEEL COLUMN - 13m STANDARD LENGTHS STRUCTURAL STEEL - MIN 355N/mm² YIELD STRENGTH
- 2 A325 TYPE 1, ASTM F436, HEAVY HEX STRUCTURAL BOLT (DIAMETER TO ENGINEERS SPECIFICATIONS)
- 3 10mm - VANSO HOT FORMED STRUCTURAL STEEL CUSTOM COLUMN CAGE
- 4 25mm INNER x 25mm OUTER DIAMETER - HOT FORMED CIRCULAR HOLLOW STRUCTURAL STEEL SECTION
- 5 25mm CCA TREATED GUM ROLE

1:10

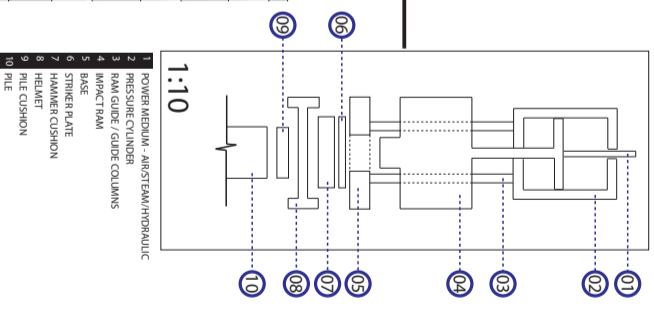

- 1 POWER MEDIUM - AIR/STEAM/HYDRAULIC
- 2 PRESSURE CYLINDER
- 3 BRACE / GUIDE COLUMNS
- 4 BRACE / PILE
- 5 BASE
- 6 STRIKER PLATE
- 7 HAMMER CUSHION
- 8 HEAVY
- 9 PILE CUSHION
- 10 PILE

1:10

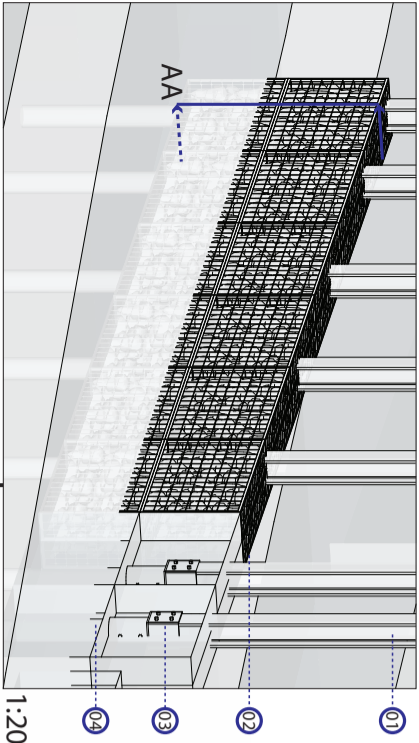

- 1 35x45mm - S355 JR STEEL COLUMN - 13m STANDARD LENGTHS
- 2 STRUCTURAL STEEL 40x135x8mm WELD STRINGER
- 3 WELD ROD MESH WITH 50MM OPENINGS - CUSTOM GALVANISED STEEL GABION BASKETS - FILLED WITH CRUSHED KIMBERLITE ROCK 10mm - VIBROSO HOT FORMED STRUCTURAL STEEL CUSTOM COLUMN CAGE
- 4 225mm - C/A TREADED GUM PILE

1:20

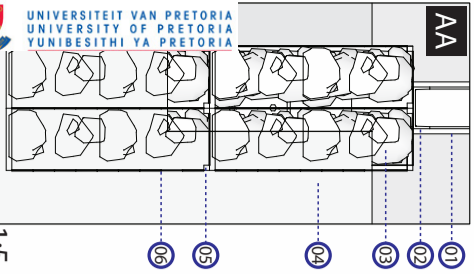

1:5

- 1 35x45mm - S355 JR STEEL COLUMN - 13m STANDARD LENGTHS
- 2 STRUCTURAL STEEL 40x135x8mm WELD STRINGER
- 3 WELD ROD MESH WITH 50MM OPENINGS - CUSTOM GALVANISED STEEL GABION BASKETS - FILLED WITH CRUSHED KIMBERLITE ROCK 10mm - VIBROSO HOT FORMED STRUCTURAL STEEL CUSTOM COLUMN CAGE
- 4 225mm - C/A TREADED GUM PILE



UNIVERSITEIT VAN PRETORIA
UNIBESITHI YA PRETORIA

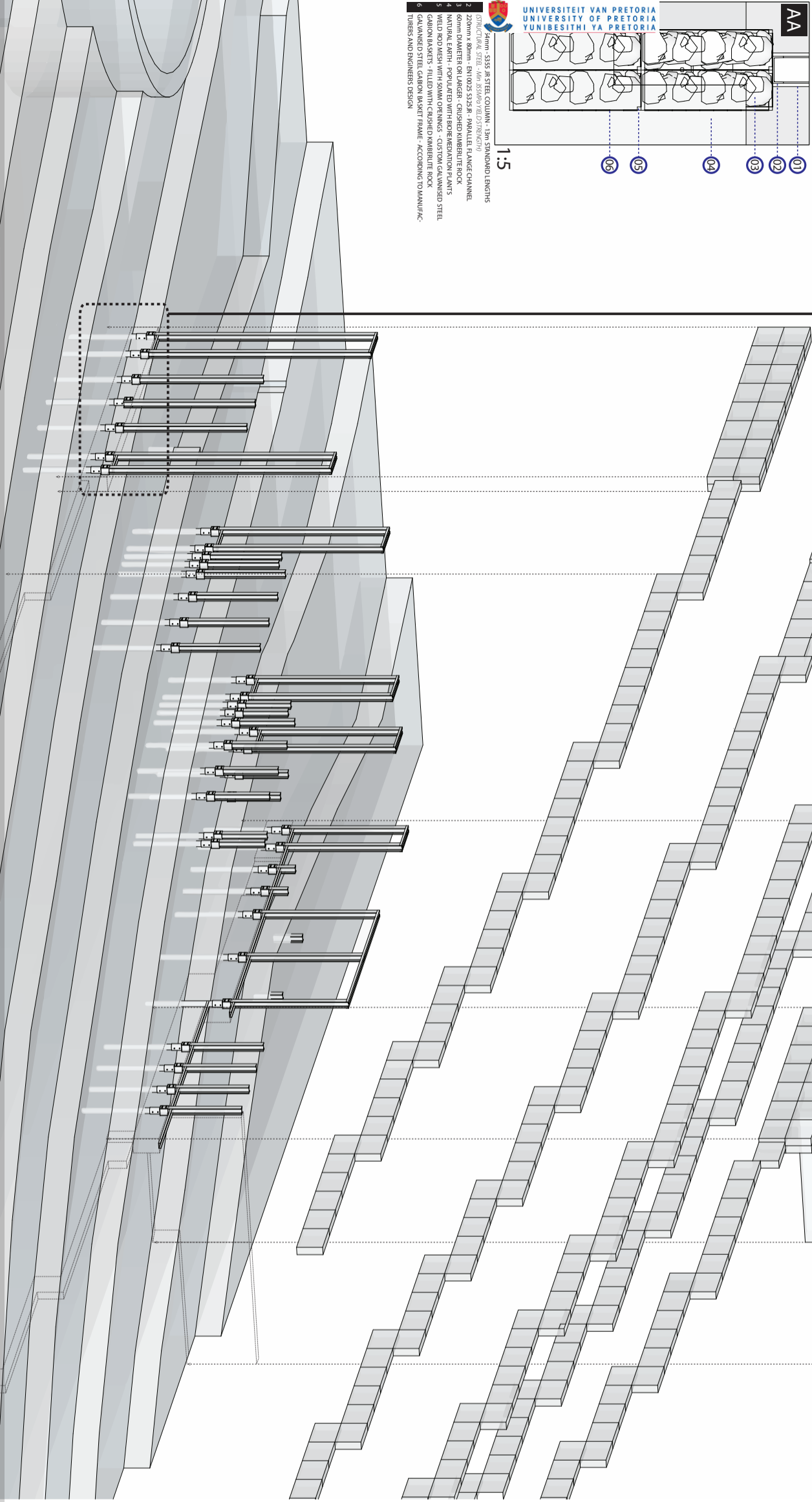

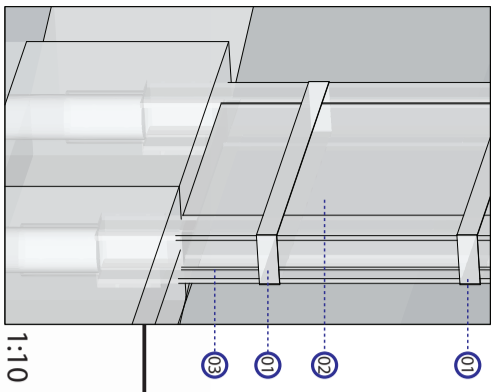

- 1 3mm - MILD STEEL PLATE THE MEMBER - RESTRANS SHUTTERWORK
- 2 20mm - S.A. PINE/PLYWOOD - SHUTTERWORK
- 3 25x425x4mm - S355 JR STEEL COLUMN - 13mm STANDARD LENGTHS STRUCTURAL STEEL - (MVA355M90 YIELD STRENGTH)

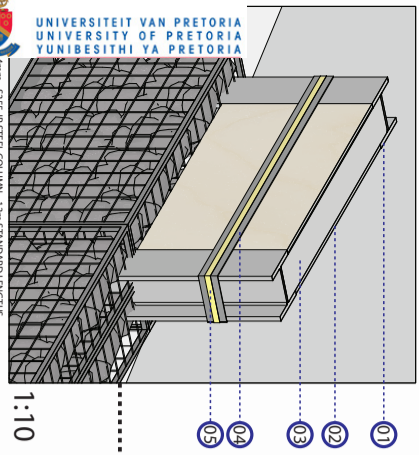

- 1 3mm - S.A. PINE/PLYWOOD - SHUTTERWORK
- 2 20mm - RAMMED EARTH - WITH CRUSHED KIBBERLITE ADDITION FOR COLOUR (BL. KCOX048 BRUYN/COLOR)
- 3 3mm - MILD STEEL PLATE THE MEMBER - RESTRANS SHUTTERWORK
- 4 45 tons YIELD STRENGTH - KEVLAIR LOKOSTRIPES - TO SUPPORT MILD STEEL PLATE THE MEMBER

UNIVERSITEIT VAN PRETORIA
UNIVERSITY OF PRETORIA
YUNIBESITHI YA PRETORIA

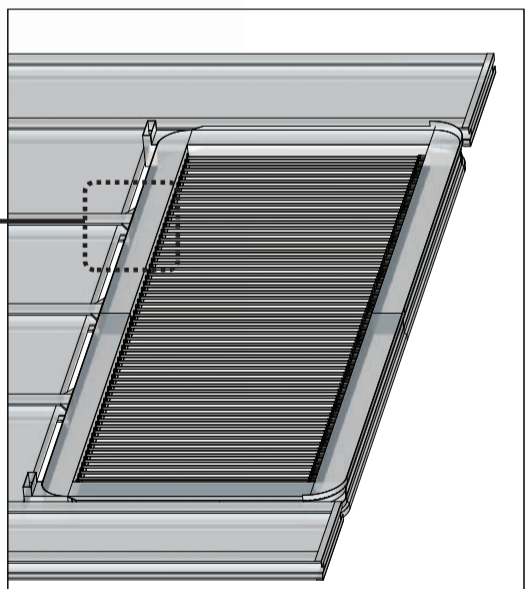
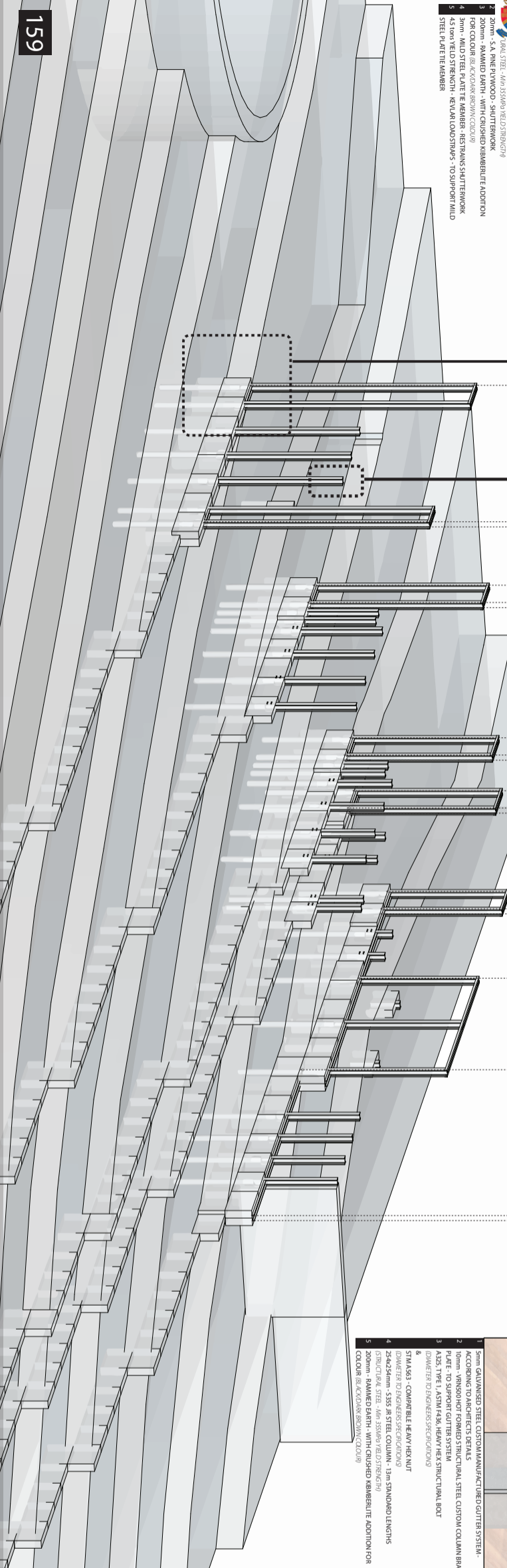

- 1 3mm GALVANISED STEEL CUSTOM MANUFACTURED GUTTER SYSTEM - ACCORDING TO ARCHITECT'S DETAILS
- 2 3mm - TO SUPPORT GUTTER STEEL CUSTOM COLUMN BRACE PLATE - TO SUPPORT GUTTER STEEL
- 3 A325 TYPE 1 ASTM A325 HEAVY HEX STRUCTURAL BOLT DIMENSIONED TO ENGINEERS SPECIFICATIONS
- 4 STWAA363 - COMPATIBLE HEAVY HEX NUT DIMENSIONED TO ENGINEERS SPECIFICATIONS
- 5 25x425x4mm - S355 JR STEEL COLUMN - 13mm STANDARD LENGTHS STRUCTURAL STEEL - (MVA355M90 YIELD STRENGTH)
- 6 200mm - RAMMED EARTH - WITH CRUSHED KIBBERLITE ADDITION FOR COLOUR (BL. KCOX048 BRUYN/COLOR)

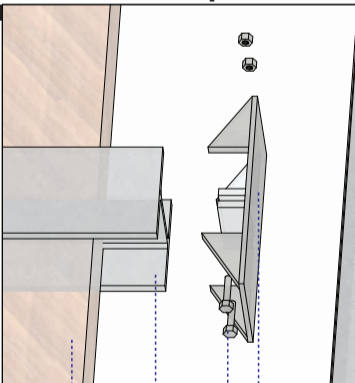

- 1 3mm GALVANISED STEEL CUSTOM MANUFACTURED GUTTER SYSTEM - ACCORDING TO ARCHITECT'S DETAILS
- 2 3mm - TO SUPPORT GUTTER STEEL CUSTOM COLUMN BRACE PLATE - TO SUPPORT GUTTER STEEL
- 3 A325 TYPE 1 ASTM A325 HEAVY HEX STRUCTURAL BOLT DIMENSIONED TO ENGINEERS SPECIFICATIONS
- 4 STWAA363 - COMPATIBLE HEAVY HEX NUT DIMENSIONED TO ENGINEERS SPECIFICATIONS
- 5 25x425x4mm - S355 JR STEEL COLUMN - 13mm STANDARD LENGTHS STRUCTURAL STEEL - (MVA355M90 YIELD STRENGTH)
- 6 200mm - RAMMED EARTH - WITH CRUSHED KIBBERLITE ADDITION FOR COLOUR (BL. KCOX048 BRUYN/COLOR)

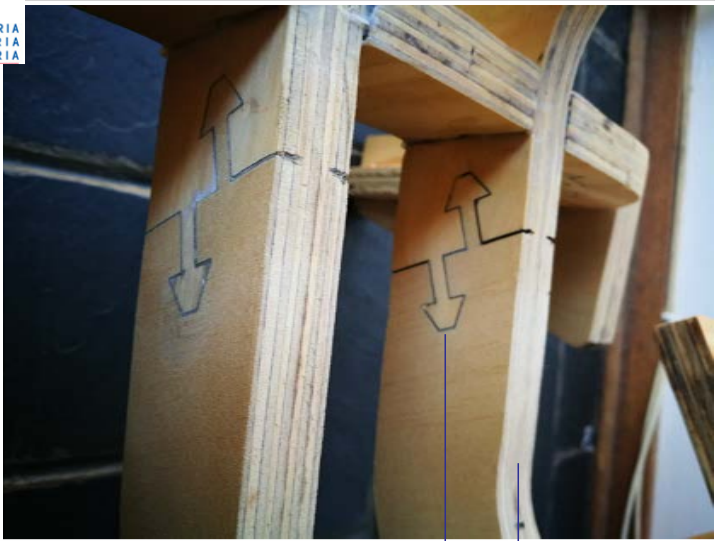

RCUT CHAIR - AS PART OF AN OPEN SOURCE
LABORATION

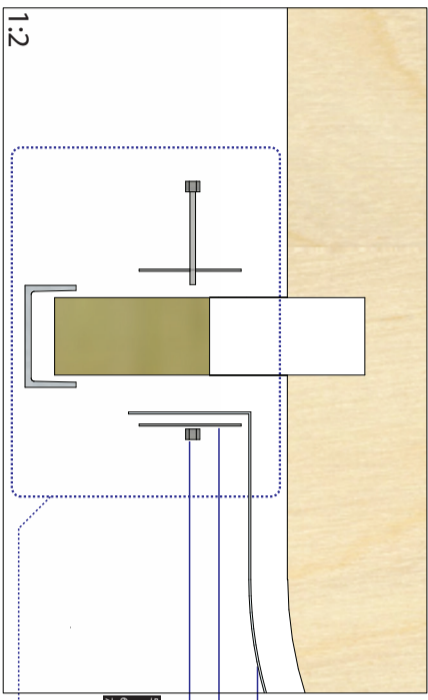

- 1 20mm - ENGINEERED COMPOSITE S.A. PINE PLYWOOD - GRADE A (3 x 6mm LAYERS + GLUE)
- 2 28mm x 76mm - S.A. PINE BEAM (20mm x 20mm AFTER PLANING)
- 3 6mm - S.A. PINE PLYWOOD - GRADE A
- 4 CNC CUT PLYWOOD COMPONENTS - GLUE LAMINATED FOR STRUCTURAL STABILITY
- 5 0.3mm - LINEAR LOW DENSITY POLYETHYLENE - THERMO SHRINK PLASTIC FILM (Formulated with both linear and low density / heat sensitive vinyl)
- 6 2mm - VARIOUS HOT FORMED STRUCTURAL STEEL RETENTION PLATE
- 7 ASTM A568 - COMPATIBLE HEAVY HEX NUT (DIAMETER TO BUSINESS SPECIFICATION)
- 8 A4-8. TYPE 1, ASTM A568 HEAVY HEX STRUCTURAL BOLT (DIAMETER TO BUSINESS SPECIFICATION)

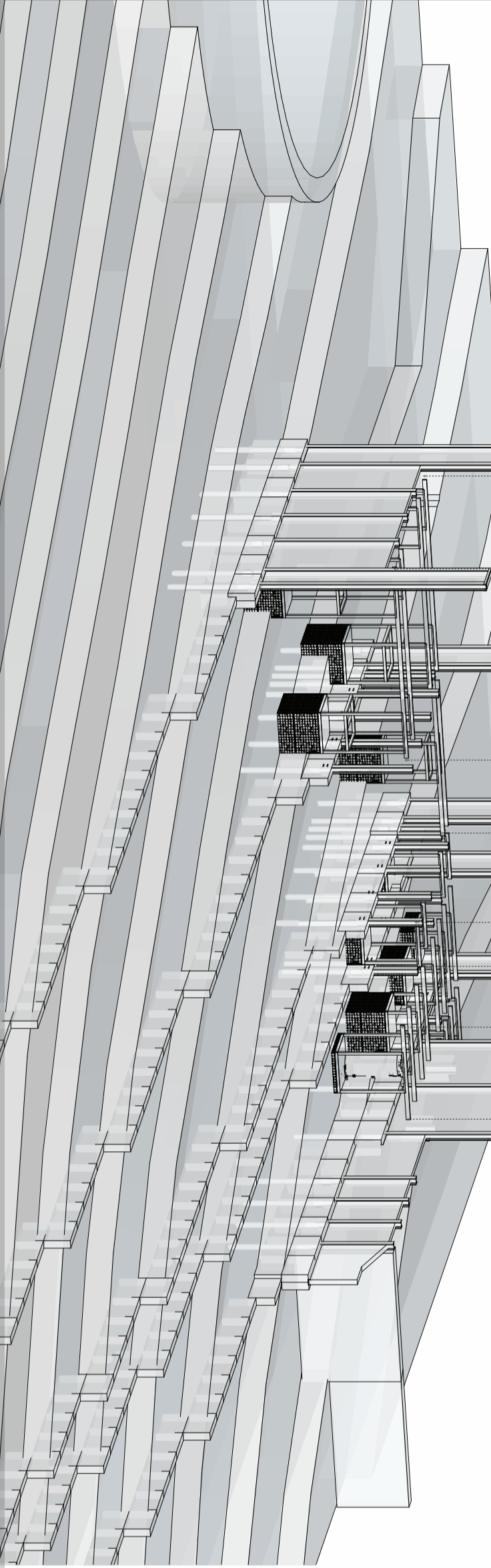
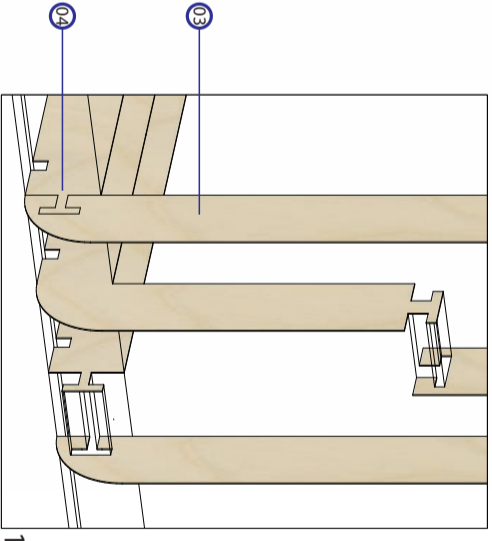
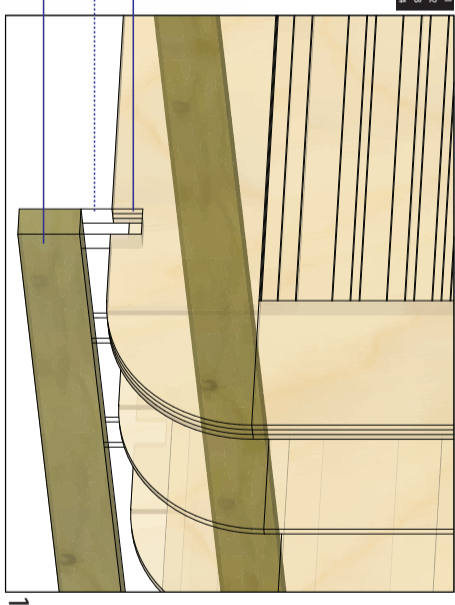

10mm - VANSO HOT FORMED STRUCTURAL STEEL PLATE - SUPPORT BRACKET 1
 ASTM A483 - COMPANIBLE HEAVY HEX NUT 2
 ID DIAMETER TO ENGINEERS SPECIFICATIONS
 A483 TYPE 1, ASTM F48, HEAVY HEX STRUCTURAL BOLT ID DIAMETER TO ENGI
 NEERS SPECIFICATIONS

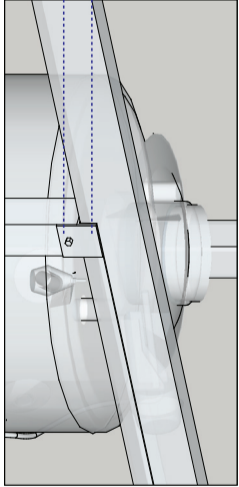

1:5

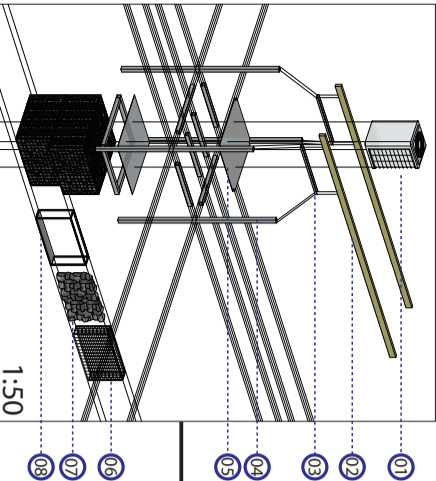

1:50

- 1 SUPPORT SERVICES - ASPER SERVICE ENGINEERS DETAILS
- 2 228mm x 76mm - S4 PINE BEAM 220mm x 70mm AFTER ANNO
- 3 100mm x 50mm - EN10025 S235JR - PARALLEL FLANGE CHANNEL
- 4 100mm x 100mm - HOT FORMED SQUARE HOLLOW STRUCTURAL STEEL SECTION
- 5 10mm - VANSO HOT FORMED STRUCTURAL STEEL PLATE STRUCTURAL DECK
- 6 WELD ROD MESH WITH 50MM OPENINGS - CUSTOM GALVANISED STEEL GABION BASKETS - FILLED WITH CRUSHED MAMBERUTE ROCK
- 7 60mm DIAMETER OR LARGER - CRUSHED MAMBERUTE ROCK
- 8 GALVANISED STEEL GABION BASKET FRAME - ACCORDING TO MANUFACTURERS AND ENGINEERS DESIGN

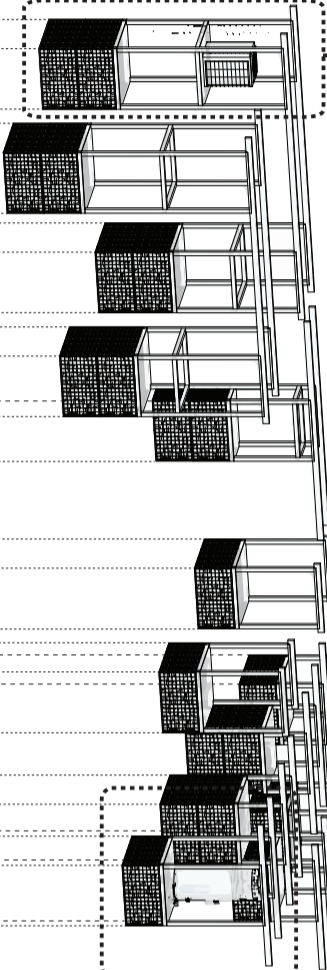

10mm - VANSO HOT FORMED STRUCTURAL STEEL PLATE - SUPPORT BRACKET 1
 ASTM A483 - COMPANIBLE HEAVY HEX NUT 2
 ID DIAMETER TO ENGINEERS SPECIFICATIONS
 A483 TYPE 1, ASTM F48, HEAVY HEX STRUCTURAL BOLT ID DIAMETER TO ENGI
 NEERS SPECIFICATIONS

01
 02

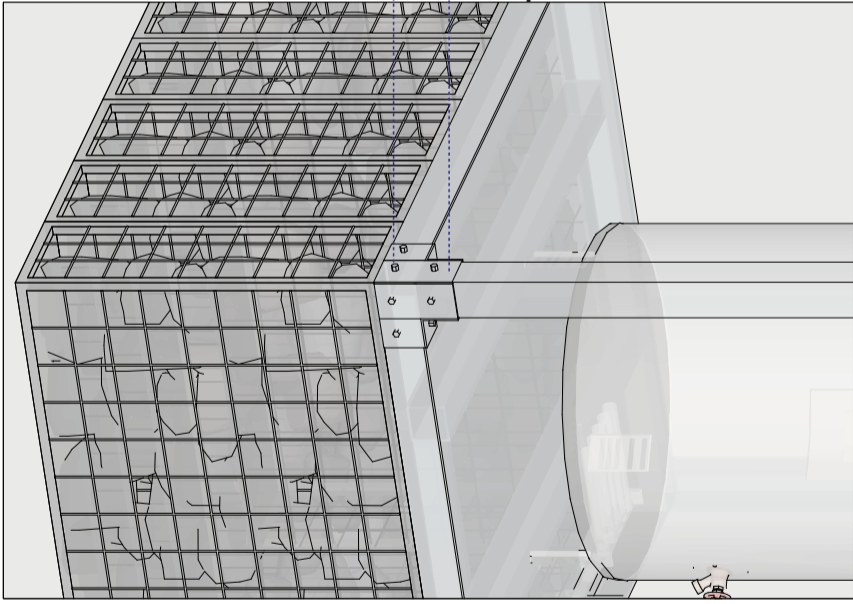

1:5

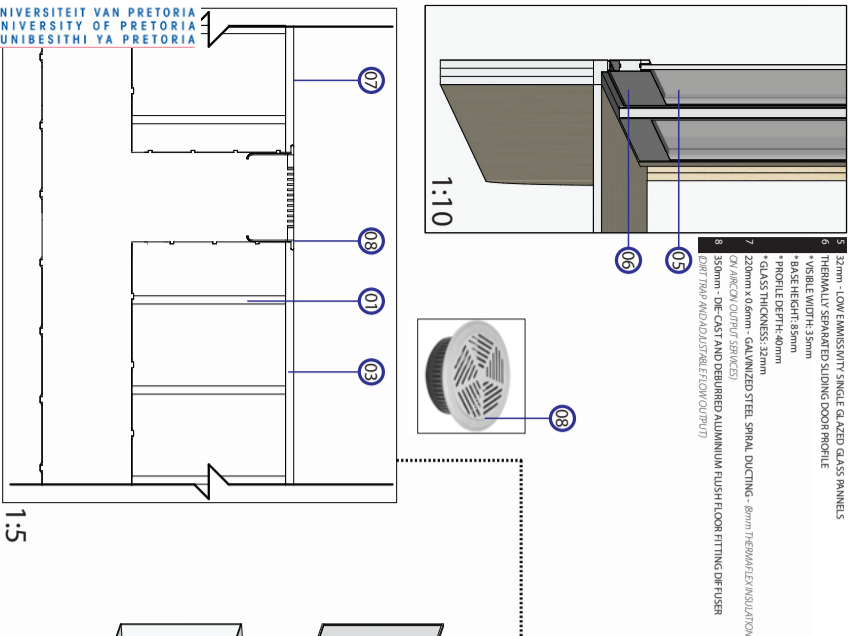

- 32mm - LOW EMISSIVITY SINGLE GLAZED GLASS PANNELS
- 1
- 2
- 3
- 4
- 5
- 6
- 7
- 8
- 9
- 10
- 11
- 12
- 13
- 14
- 15
- 16
- 17
- 18
- 19
- 20
- 21
- 22
- 23
- 24
- 25
- 26
- 27
- 28
- 29
- 30
- 31
- 32
- 33
- 34
- 35
- 36
- 37
- 38
- 39
- 40
- 41
- 42
- 43
- 44
- 45
- 46
- 47
- 48
- 49
- 50

1:5

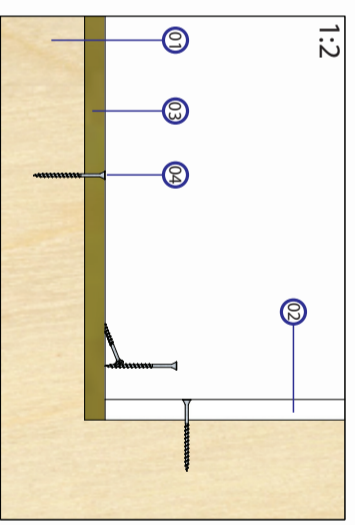
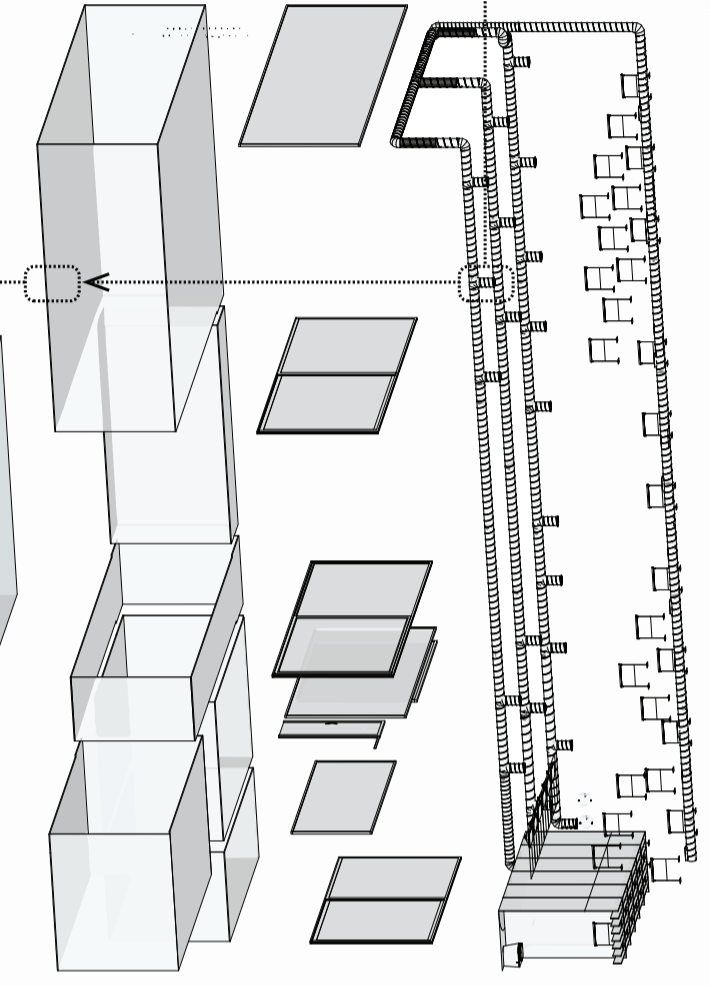

- 1
- 2
- 3
- 4
- 5
- 6
- 7
- 8
- 9
- 10
- 11
- 12
- 13
- 14
- 15
- 16
- 17
- 18
- 19
- 20
- 21
- 22
- 23
- 24
- 25
- 26
- 27
- 28
- 29
- 30
- 31
- 32
- 33
- 34
- 35
- 36
- 37
- 38
- 39
- 40
- 41
- 42
- 43
- 44
- 45
- 46
- 47
- 48
- 49
- 50

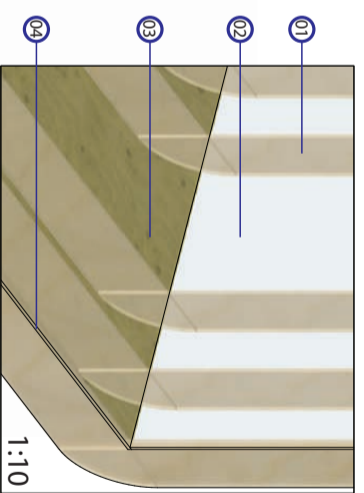

- 1
- 2
- 3
- 4
- 5
- 6
- 7
- 8
- 9
- 10
- 11
- 12
- 13
- 14
- 15
- 16
- 17
- 18
- 19
- 20
- 21
- 22
- 23
- 24
- 25
- 26
- 27
- 28
- 29
- 30
- 31
- 32
- 33
- 34
- 35
- 36
- 37
- 38
- 39
- 40
- 41
- 42
- 43
- 44
- 45
- 46
- 47
- 48
- 49
- 50

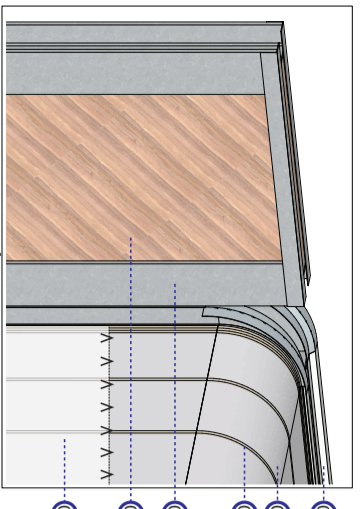

1:20

- 1 2mm - GALVANISED CUSTOM STEEL FLASHING
- 2 365mm - POLYISOCYANURATE (PI) INSULATION
- 3 20mm - ENGINEERED COMPOSITE S.A. PINE PLWOOD - GRADE A
- 4 3.65mm LAYERS + GULL
- 5 25x25mm - S355 STEEL COLUMN - 13m STANDARD LENGTHS
- 6 25x25mm - S355 STEEL COLUMN - 13m STANDARD LENGTHS
- 7 25x25mm - S355 STEEL COLUMN - 13m STANDARD LENGTHS
- 8 25x25mm - S355 STEEL COLUMN - 13m STANDARD LENGTHS
- 9 25x25mm - S355 STEEL COLUMN - 13m STANDARD LENGTHS
- 10 25x25mm - S355 STEEL COLUMN - 13m STANDARD LENGTHS
- 11 25x25mm - S355 STEEL COLUMN - 13m STANDARD LENGTHS
- 12 25x25mm - S355 STEEL COLUMN - 13m STANDARD LENGTHS
- 13 25x25mm - S355 STEEL COLUMN - 13m STANDARD LENGTHS
- 14 25x25mm - S355 STEEL COLUMN - 13m STANDARD LENGTHS
- 15 25x25mm - S355 STEEL COLUMN - 13m STANDARD LENGTHS
- 16 25x25mm - S355 STEEL COLUMN - 13m STANDARD LENGTHS
- 17 25x25mm - S355 STEEL COLUMN - 13m STANDARD LENGTHS
- 18 25x25mm - S355 STEEL COLUMN - 13m STANDARD LENGTHS
- 19 25x25mm - S355 STEEL COLUMN - 13m STANDARD LENGTHS
- 20 25x25mm - S355 STEEL COLUMN - 13m STANDARD LENGTHS

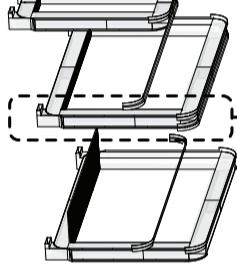
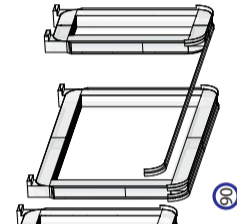
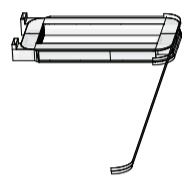
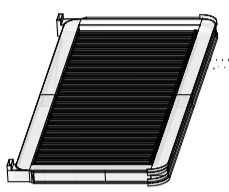
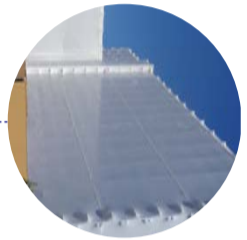

05

06

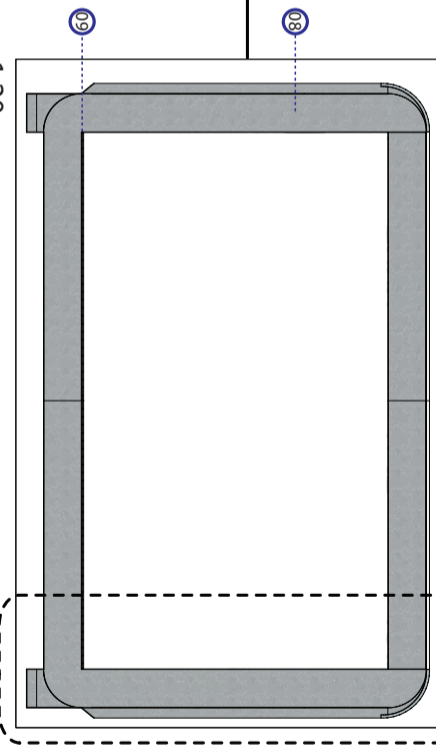

1:20

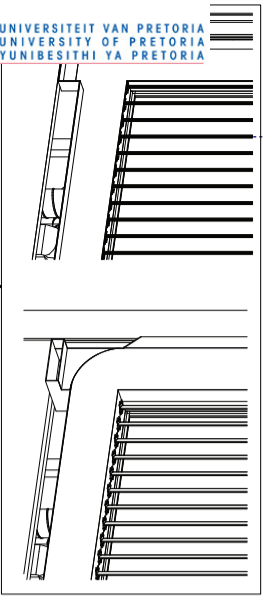

07

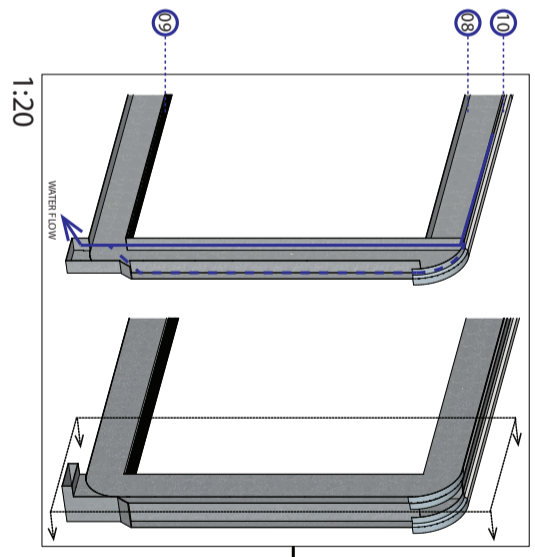

1:20

08

09

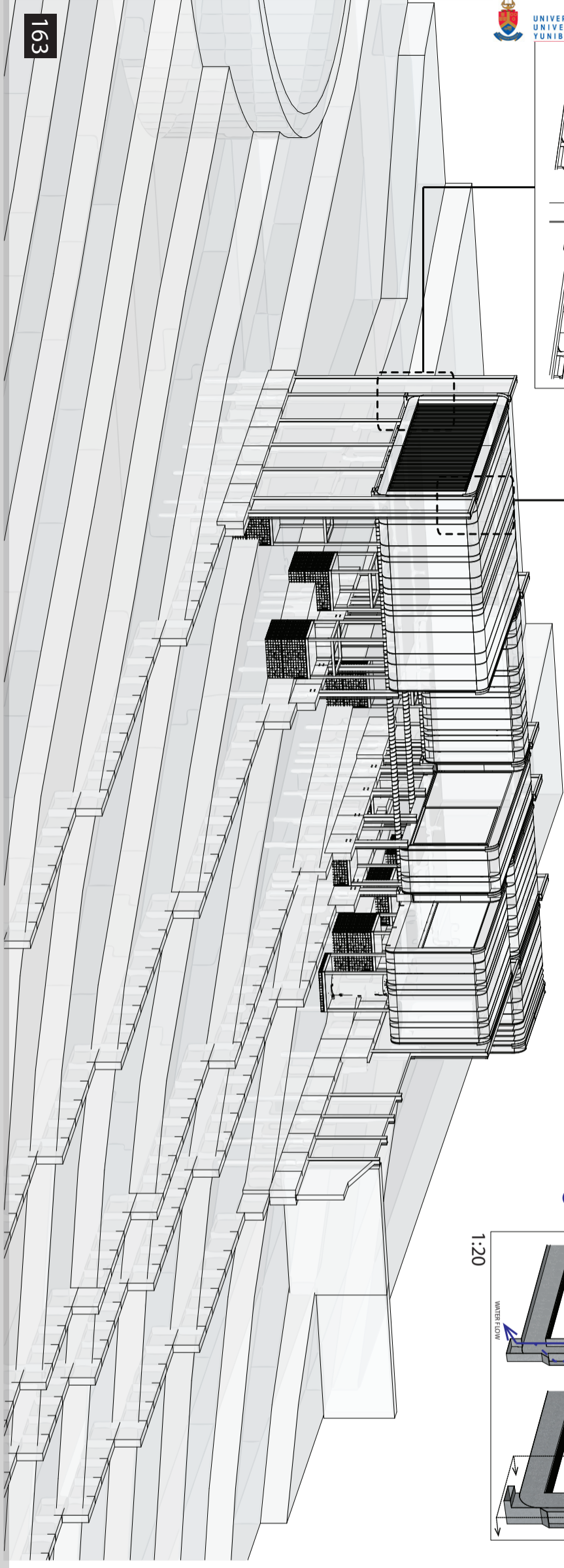



6.4// MODELS

