



1. View from the north-east



2. View from the sea-facing garden looking east



3. View from the front garden looking west



4. View from the south-west corner



5. View from the driveway looking west



6. View of the living and dining room



7. View from southern most bedroom looking west



8. Sliding door reveal to living room



9. North facing window to main bedroom



10. Detail of continuous steel handrail at carport and entrance stair

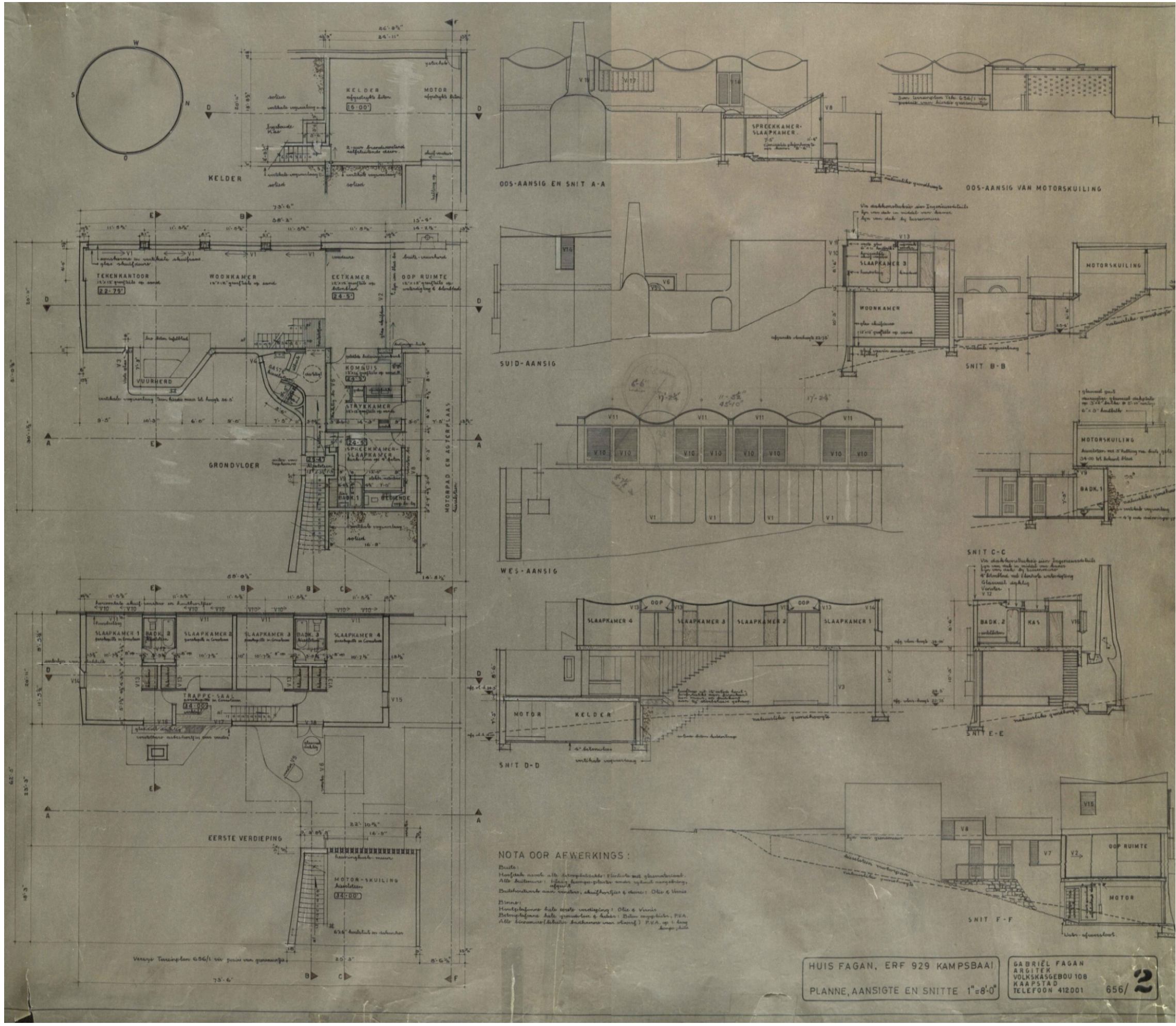

NOTA OOR AFWERKINGS :

Buite:
 Hoofdeinde murele alle skoonheidskele: Eendele met gemaaktesel.
 Alle buite murele: 1/2" dikke baksteen met yskoude mureloring.
 Buite murele met venster, skoonheidskele & dore: 1/2" dikke mureloring.

Binnre:
 Hoofdeinde murele alle murele mureloring: 1/2" dikke mureloring.
 Binnre murele alle mureloring & dore: 1/2" dikke mureloring. P.V.A.
 Alle mureloring (dorele buite mureloring) P.V.A. op 1" dikke
 baksteen.

HUIS FAGAN, ERF 929 KAMPSBAAI
 PLANNE, AANSIGTE EN SNITTE 1"=8'-0"

GABRIEL FAGAN
 ARGITEK
 VOLKSKASSEBOU 108
 KAAPSTAD
 TELEFOON 412001 656/2

Working drawing