



UNIVERSITEIT VAN PRETORIA
UNIVERSITY OF PRETORIA
YUNIBESITHI YA PRETORIA

P R O D U C T I O N B E Y O N D P R O D U C T

PRETORIA WEST BIO-DIESEL PLANT - by Mias Claassens

Buitenkant Street, Pretoria West Industrial area, City of Tshwane.

Submitted in fulfilment of the requirements for the degree of Masters in Architecture (Professional) in the Faculty of Engineering, Built Environment and Information Technology, University of Pretoria, South Africa. November 2010.

Study leaders: Derick de Bruyn and Ida Breed.

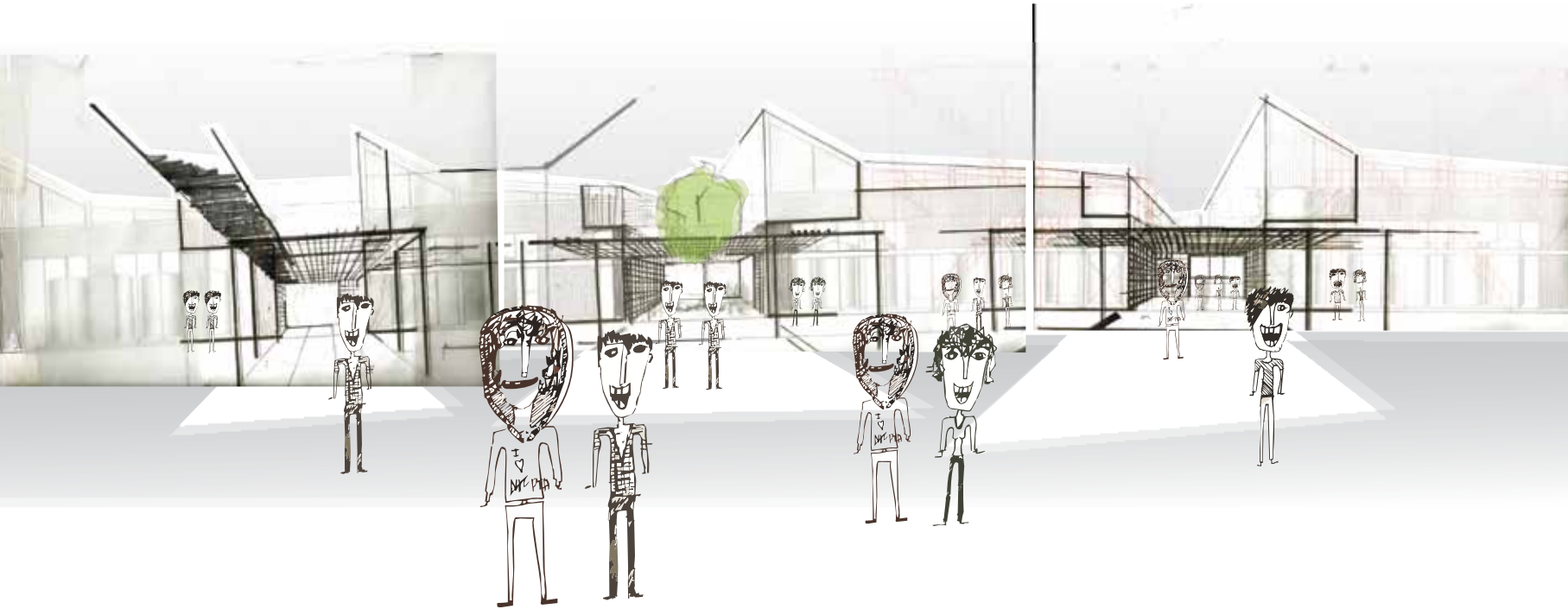

Figure 1. Visionary image of the Pretoria West Bio-diesel plant: Buitenkant Street, Pretoria West Power Station, Pretoria West Industrial area, City of Tshwane: Author 2010.



In 1991 a landfill just outside of New York City surpassed the Great Wall of China as the largest human-made structure on earth.

Freshkills Park will be almost three times the size of Central Park and the largest park developed in New York City in over 100 years. The transformation of what was formerly the world's largest landfill into a productive and beautiful cultural destination will make the park a symbol of renewal and an expression of how our society can restore balance to its landscape (New York City Department of Parks and Recreation, 2010).

Human demand for resources has reached unprecedented levels.

The case for an architecture that is regenerative and environmentally sustainable has never been stronger.



Contents

List of figures I

Abstract IX

p.1

Chapter 1: Introduction

Background	1
Problem statement	9
Hypothesis	9
Aim of study	9
Methodology	11
Methods	15
Site introduction	17
Heritage	21
Client & brief	25

p. 27

Chapter 2: Framework

Background	27
Vision	31

p.85

Chapter 6: Design development

Aim of design	85
Technical development	87
Spatial development	95

p. 111

Chapter 7: Design resolution and Technical report

Materiality	111
Structure	114
Design resolution	116
Building systems	136
Technical report	144
Green design assessment	164



p.39

Chapter 3: Context analysis

Project location	39
Climatic zone	43
Legislative context	45
Emerging opportunities in context	45

p.49

Chapter 4: Site analysis

Discarded space	49
Regeneration	54
Social themes	63

p.69

Chapter 5: Precedent studies

Passive design	69
Heritage	73
Building as an ecosystem	77
Production process	78

p.171

Chapter 8: Conclusion

Conclusion	173
Building profile	174
References	176
Addendums	180



List of figures

- Figure 1: Visionary image of the Pretoria West Bio-diesel plant: Buitenkant Street, Pretoria West Power Station, Pretoria West Industrial area, City of Tshwane: Author 2010.
- Figure 2: Vision for an integrated production process: Author 2010.
- Figure 3: Pretoria West Industrial area in context with the City of Tshwane CBD. From: City of Tshwane Municipality, edited by author 2010.
- Figure 4: Photo collage of existing urban fabric in Pretoria West Industrial area (Mitchelle Street) showing the deterioration of the area due to the homogenous vehicle related industrial activities: Author 2010.
- Figure 5: Pretoria West Power Station showing the landmark qualities of the site: Author 2010.
- Figure 6: Sketch by author to capture the atmospheric and iconic qualities of the Pretoria West Power Station
- Figure 7: The natural and industrial landscape of the Pretoria West Power Station site: Author 2010.
- Figure 8: Abstract representation of the discarded Pretoria West Industrial Area in context to the City of Tshwane. The discarded Pretoria West Industrial urban-cell holds the potential to be reintegrated into the urban fabric; to become a sub-support to the City of Tshwane CBD. From: Author 2010.
- Figure 9: Abstract representation of connections between the Pretoria West Industrial Area and the City of Tshwane. The aim is to establish supporting connections between the various urban-cells to yield an integrated urban environment and stronger supporting structure to the CBD . The Pretoria West urban-cell could once again connect to and support the CBD of the City of Tshwane and re-establish its importance within the greater urban fabric. From: Author 2010.
- Figure 10: The Pretoria West Power Station is chosen as the intervention node for urban regeneration in the Pretoria West Industrial Area. The site is a discarded industrial landmark and holds the potential for a diverse and versatile adaptive re-use interpretation, in working with the scale, location and industrial ethos of the site. From: Author 2010.
- Figure 11: Conceptual understanding of methodology: Author 2010 (visual interpretation).
- Figure 12: Hamdi's (2004) backward approach to design: Author 2010.
- Figure 13: Design process that is guided by the methodology. From: Author 2010.
- Figure 14: Visual interpretation of the methods applied to obtain the required information that is stipulated by the methodology. From: Author 2010 (visual interpretation).
- Figure 15: Pretoria West Power Station in context with the City Of Tshwane CBD. From: City of Tshwane Municipality, edited by Author 2010.
- Figure 16: Pretoria West Power Station and Pretoria West Industrial Area, City of Tshwane. From: City of Tshwane Municipality, edited by Author 2010.
- Figure 17: Bio-diesel plant on the Pretoria West Power Station site. Image from Google Earth, edited by Author 2010.
- Figure 18: Photo collage of existing structures on site. By Author 2010.
- Figure 19: Photo collage of Pretoria West Power Station showing the landmark and tectonics qualities of the study area . From: Author 2010.

- Figure 20: Pretoria West Power Station showing the landmark qualities of the cooling towers . From: Author 2010.
- Figure 21: Existing energies in the study area that will be used to integrate the Pretoria West Industrial Area with City of Tshwane CBD: Pretoria West Group Framework 2010.
- Figure 22: Walking distances to show close proximity of the Pretoria West Industrial area to the City of Tshwane CBD Pretoria West Group Framework 2010, edited by Author.
- Figure 23: Vision for the Pretoria West Industrial Area. The aim of the proposed interventions is to discourage further sprawling to the west (Atteridgeville), and to focus on existing emerging and discarded energies as opportunities to re-connect the area to the City of Tshwane CBD and its surrounding areas: Pretoria West Group Framework 2010.
- Figure 24: Pretoria West transport nodes, showing how existing infrastructure relate to the Pretoria West Power Station: Pretoria West Group Framework, edited by Author 2010.
- Figure 25: Vision for Pretoria West Industrial Area : The area must function as a productive cell, and keep its ethos as an industrial urban-cell: Pretoria West Group Framework 2010.
- Figure 26: Vision for Pretoria West Industrial Area : The area must connect to existing energies .The already existing energies (people, transport nodes, industrial building stock and natural landscape) must be applied to regenerate the area: Pretoria West Group Framework 2010.
- Figure 27: Vision for Pretoria West Industrial Area: The area must accommodate regenerative production industries. Diversity in terms of industrial processes is important to generate emerging opportunities in the Pretoria West Industrial Area that will establish re-connections with the rest of the urban fabric: Pretoria West Group Framework 2010.
- Figure 28: Vision for Pretoria West Industrial Area: The area must connect to the urban fabric that will demonstrate sustainable social integration .It is important for the industrial processes to hace will have a positive impact on the urban fabric and not function as the current isolated entity: Pretoria West Group Framework 2010.
- Figure 29: South Africa with City of Tshwane as indicated. From: www.samaps.co.za, edited by Author 2010.
- Figure 30: The study area of Pretoria West Industrial Area in context to the industrial areas of City of Tshwane: City of Tshwane Municipality, edited by Author 2010.
- Figure 31: The study area of Pretoria West Power Station in context to the City of Tshwane CBD: City of Tshwane Municipality, edited by Author 2010.
- Figure 32: Average rainfall : City of Tshwane: Holm 1996.
- Figure 33: Average day and night temperature: City of Tshwane.: Holm 1996.
- Figure 34: Rainwater harvesting: Author 2010.
- Figure 35: Passive solar design: Author 2010.
- Figure 36: Capturing solar energy: Author 2010.
- Figure 37: Zoning for Pretoria West Industrial Area. From: City of Tshwane Municipality, edited by author 2010.
- Figure 38: In the Pretoria West Industrial Area, along Charl, Mitchell and Souter Street, seventeen technical harvesting centres have been identified that could plug into the industrial metabolism where products-of-service are generated. Designing products as products of service means designing them to be disassembled and to be part of numerous cycles, generating an industrial ecosystem: Author 2010.



- Figure 39: In order for the production process to function as an ecosystem it needs to be cyclical (process orientated) and not linear (product orientated): Author 2010.
- Figure 40: Existing conditions at the Pretoria West Power Station: Author 2010.
- Figure 41: Pretoria West Power Station: Existing Structures: Author 2010.
- Figure 42: ArcelorMittal (March 2010), Pretoria West, City of Tshwane: Author 2010
- Figure 43: Main movement routes linking to the Pretoria West Industrial Area: Author 2010.
- Figure 44: Pretoria West Power Station: natural systems: Author 2010
- Figure 45: Movement along the street edge (Buitenkant Street) and the proposed bio-diesel plant: Author 2010.
- Figure 46: Non-linear facade to generate maximum interaction with street activity (urban fabric): Author 2010.
- Figure 47: Existing activities in the Pretoria West Power Station site, City of Tshwane: Author 2010
- Figure 48: Proposed activities in the Pretoria West Power Station, City of Tshwane. From: Pretoria West Group Framework 2010.
- Figure 49: Flaneur walking through Pretoria West Industrial area: Author 2010
- Figure 50: Integration of the production process into the urban fabric through movement and activity: Author 2010.
- Figure 51: The surrounding landscape that indicates industrial (view B) and residential activities(view A) from the Pretoria West Power Station: Author 2010.
- Figure 52: Emerging themes in Pretoria West Industrial area; City of Tshwane. From Pretoria West Record newspaper (Jan - Apr 2010) as per periodical analysis described under methods on page 15.
- Figure 53: Drawings of the Pretoria West Power Station to show the character of the site: Author 2010.
- Figure 54: Trellis structure with vines to allow sun to enter the building in winter and limit it in summer: Woo, 2010.
- Figure 55: Hot air is allowed to dissipate out of clearstory windows as cooler air enters the space from below: Woo, 2010.
- Figure 56: John T Lyle Regenerative Centre: a trellis structure on the southern side of the building support deciduous vines, the shade from the vines blocks direct sun from entering in the summer, helping to keep the interior spaces from heating up: Woo, 2010.
- Figure 57: John T Lyle Regenerative Centre: roof profile design to accommodate solar panels:Stine, 2000.
- Figure 58: Turbine Hall, Jeppe Street, Johannesburg: The development stands as a example of modern architecture coupled with the conservation of an historic site and the seed for an urban renewal programme: Krige & Beswick 2001: 2.
- Figure 59: Re-interpretation of a theme in Turbine Hall: the X-brace as structural and aesthetic device. The architecture is sympathetic to the existing architecture and urban fabric, preserving as far as possible the 'ethos' of the existing power station complex: Krige & Beswick, 2001: 24.
- Figure 60: The original concrete hoppers in the demolished North Boiler House are commemorated as skylights in the central atrium of Turbine Hall: Krige & Beswick, 2001: 110.
- Figure 61: Solar panels on the roof of Turbine Hall and natural lighting through use of skylights: Krige & Beswick, 2001: 121.
- Figure 62: Pretoria West Bio-diesel plant ecosystem: the production process, rain water harvesting and solar energy. As inspired by the Harmonia Office building precedent study: Author 2010
- Figure 63: Harmonia office building: Harmonia 57 by Triptyque, 2008.
- Figure 64: Harmonia office building: the walls are thick and covered externally by a vegetation layer that serves as the skin of the structure. Harmonia 57 by Triptyque, 2008.



- Figure 65: Harmonia office building: an ecosystem where rain-and soil-water are drained, treated and re-used; a complex ecosystem is formed within the local: Harmonia 57 by Triptyque, 2008.
- Figure 66: Map of London underground indicating the location of Uptown Oil Bio-diesel Plant: London Underground Station 2010.
- Figure 67: Uptown Oil Bio-diesel Plant in its urban context: Author, 2010
- Figure 68: Uptown Oil bio-diesel Plant plan: Author, 2010.
- Figure 69: Diagram demonstrate the production process of bio-diesel at Uptown Oil, London, UK. Photographs by author (visited in June 2010).
- Figure 70: Diagram showing the production process of bio-diesel at Uptown Oil, London, UK. Photographs by author (visited in June 2010).
- Figure 71: Bio-diesel CO₂ cycle showing how discarded cooking oil can be turned onto fuel: Uptown Oil brochure, 2010.
- Figure 72: Bio-diesel components; showing that glycerol is a by product that can be used in another production process (for example in soap production) and methanol that are recycled, demonstrating that production can be cyclical: Bio-diesel Production and Quality,
- Figure 73: Diagram explaining the aim of the architectural design process for the Pretoria West Bio-diesel plant: Author 2010.
- Figure 74: Conceptual exploration where the production process (functional and technical qualities) will be used to define the spatial qualities of the bio-diesel plant: Author 2010.
- Figure 75: Exploration of the production process of bio-diesel to determine the area needed for the various functions of the building: Author 2010.
- Figure 76: Diagram showing Pretoria West Bio-diesel Plant's spatial layout diagram; indicating social integration to the production process: Author 2010.
- Figure 77: Diagram indicating Pretoria West Bio-diesel Plant's spatial layout of the production process for bio-diesel. The current layout allows for maximum interaction between the production process and the surrounding urban fabric: Author 2010.
- Figure 78: Connectivity: Author 2010.
- Figure 79: Discarded objects and space: Author 2010.
- Figure 80: Production not linear but cyclical: Author 2010.
- Figure 81: Factors that influence the site location: Google Earth, edited by Author 2010.
- Figure 82: First conceptual spatial exploration showing the non-linear facade to create social spaces that will form connection points between the production process and surrounding urban activities: Author August 2010.
- Figure 83: First conceptual spatial exploration showing how the building reacts to the surrounding urban activities: through a human scale rather than an industrial scale: Author August 2010.
- Figure 84: Conceptual exploration: the non-linear façade imitates non-linear processes and creates rhythm and opportunity for visual and physical connection points between the industrial process and the surrounding urban fabric. By breaking up the facade the building will relate to a more human scale: Author 2010.
- Figure 85: Conceptual exploration: soft and humane spaces become the threshold between the industrial process and the adjacent urban fabric: Author 2010.
- Figure 86: Natural processes guiding the roof design (day light into the building and solar panels on the roof): Author 2010.
- Figure 87: Natural - and production processes guided the ventilation strategy; using rain water to 'wash' the discarded cooking oil will double up as the natural ventilation system for the production area: Author: 2010. 

- Figure 88: Integration with the public space and street edge will be programmed with thresholds, visual links and relating the industrial process to the urban environment with the appropriate human scale: Author 2010.
- Figure 89: Contextual response based on spatial intentions; contextually the Pretoria West Bio-diesel Plant must respond to the surrounding public space and to the street edge (Buitenkant Street) that will accommodate the proposed taxi rank and informal markets: Author 2010.
- Figure 90: The movement diagram is the first response to provide the building with spatial performance: Author 2010.
- Figure 91: Pretoria west Bio-diesel Plant: showing integration with the urban fabric through the employment of visual links, threshold and incorporating human scale: Author 2010.
- Figure 92: Pretoria west Bio-diesel plant: showing Buitenkant Steet and how the Pretoria West Bio-diesel plant is integrated into the surrounding urban fabric: Author 2010.
- Figure 93: The structure of the two service areas at the back of the bio-diesel plant will consist of masonry and mortar, to relate to adjacent power station building B: Author 2010.
- Figure 94: To gain consistency throughout the project and minimal material weight, material is assigned to the functions of the building: Author 2010.
- Figure 95: Pretoria West Bio-diesel plant: showing the structural components of the building: Author 2010.
- Figure 96: On the left is the threshold between the production process and the street. In the middle back is the bio-diesel fuel station that will establish connectivity through activity. To the right is the informal market that will spill over to the Bio-diesel plant and will be accommodated in the existing ash-bunkers to establish integrated social spaces: Author 2010.
- Figure 97: On the left is the production annexe that forms a non-linear facade and accommodates the social spill out space. The facade is opened up to have a visual connection with the production activities. On the right is the existing ash bunkers that will accommodate the informal market, this leads into the social space along the facade (the timber pergola structure and trees will programme the appropriate human scale along the facade)¹⁶
- Figure 98: The threshold social space between the Bio-diesel plant (office) and the adjacent main public space, which will contribute to the integration of the industrial building into the urban fabric: Author 2010.
- Figure 99: The social space at the back between the train station and the Bio-diesel plant: the workers are the most important source of energy in the production process, and it is therefore vital to have a space where they can interact in conversation, have a quite lunch or just be surrounded by other people away from their machine dominated work environment: Author 2010.
- Figure 100: Pretoria West Bio-diesel Plant lighting levels: the lighting level depends on occupancy and activity, and is determined in accordance with the requirements of SANS 10114-1: Author 2010.
- Figure 101: Daylight will enter through louvers which will be manually operated. The functions in the bio-diesel plant are arranged in relation to the natural light that enters the building; human-related activities are placed where the most light enters, and the storage and passive production processes where least amount of natural light reaches: Author 2010.
- Figure 102: A part of the roof angle is 27° to accommodate photovoltaic panels that will generate electricity for the lighting of the bio-diesel plant and solar water heating panels. From: Author 2010.





- Figure 103: Earth tubes will be connected to the adjacent coal bunker where cool and fresh air will be collected. The earth tube must be sunken into the ground to a distance of at least 2m, and the tube must be installed at a 1:100 slope for condensation to run off and prevent a sick building syndrome to develop: Author 2010.
- Figure 104: The floor of the production area is a raised steel mentis grid floor with a concrete funnel base, this allow for any spillage to be saved. The strategy is aimed at using rainwater to run down the funnel base which would move and 'wash' the oil (washing the oil is a process where the impurities of the discarded cooking oil react with the water). The constant water moving will cool the air from the lower level vents, that will be used to naturally ventilate the production area: Author 2010.
- Figure 105: Rainwater harvesting strategy of the Pretoria West Bio-diesel Plant: Author 2010.
- Figure 106: The production area section shows the relationship between the urban fabric, threshold space and Bio-diesel plant. The threshold space will have a visual connection to the street, function as a spill out area for the workers, and the openings will allow ample day light and fresh air into the building: Author 2010.
- Figure 107: The office area section shows the stitching between the urban activities (informal market at the ash bunkers) and industrial building (Bio-diesel plant); through the integrated social space - the social space is a light structure to strengthen the human scale to that of the industrial scale that is associated with the solid concrete ash bunker structure. The ash bunkers are retained because of their position on the street edge and ability to accommodate an urban activity (informal market): Author 2010.
- Figure 108: Pretoria West Bio-diesel plant: Daylight factor. From: Author 2010.
- Figure 109: Pretoria West Bio-diesel plant, natural ventilation, indicating the openable area to floor area. From: Author 2010.
- Figure 110: Potential trees that will be appropriate to climate and architectural design intend, and indigenous to local environment: Author 2010.
- Figure 111: Themes from the front pages and community news section: Author 2010.
- Figure 112: Themes from 'let's clean up' section: Author 2010.
- Figure 113: Themes from the advertisement: Author 2010.
- Figure 114: Emerging themes that came out of the study. Author 2010.